

Enclosed are Drawing for Creating ambience
at Bal Sangam 2019. Drawing are only for reference
purpose, details can be discussed with
Shri Bansi Kaul artistic director appointed for the event.
Changes and modifications can be done in installations
with approval of the artistic director

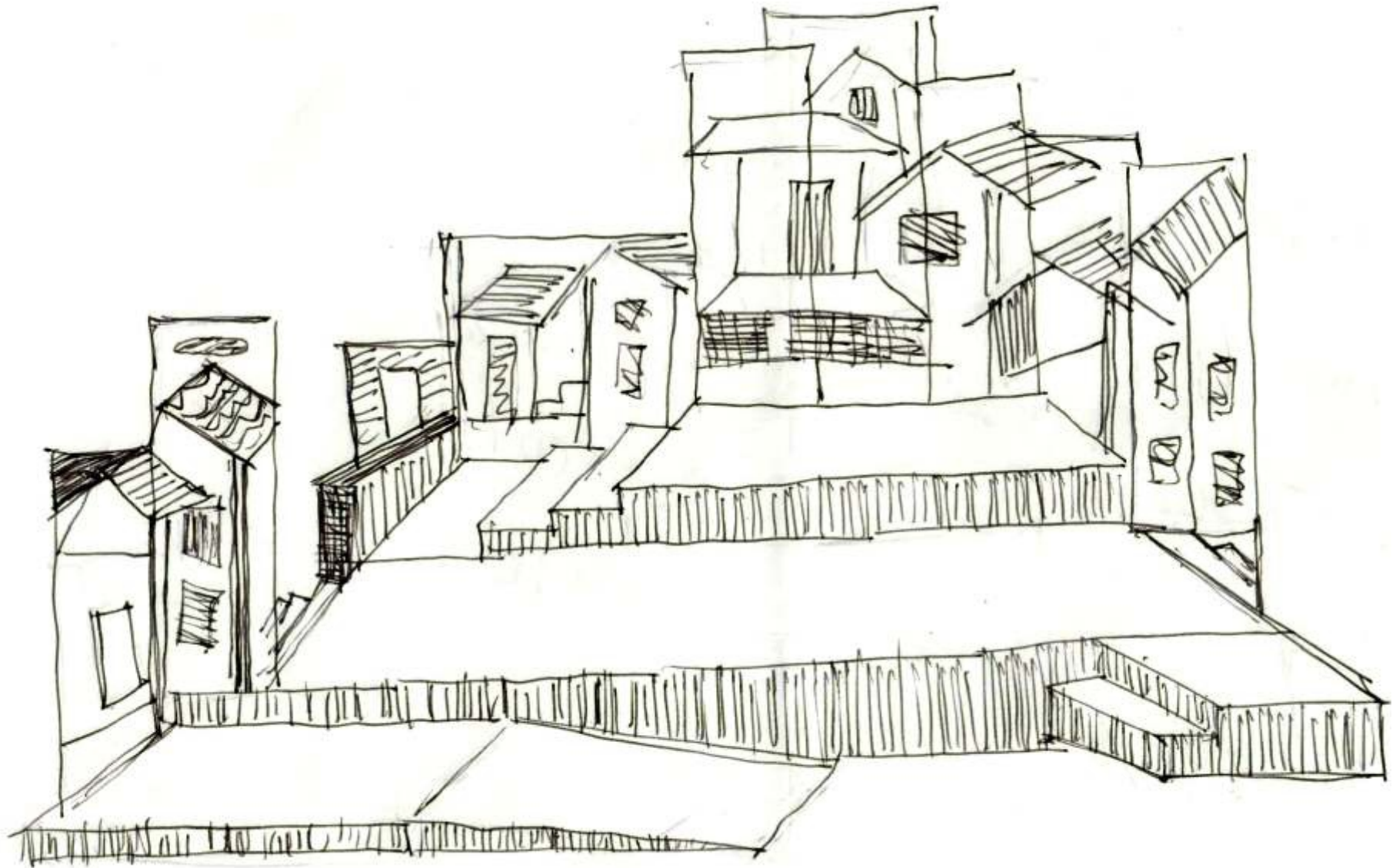

Installation 1 Model of a Theatre Stage to be erected near the main entrance of the school covering an area of 10ft x 20 ft make it colour ful

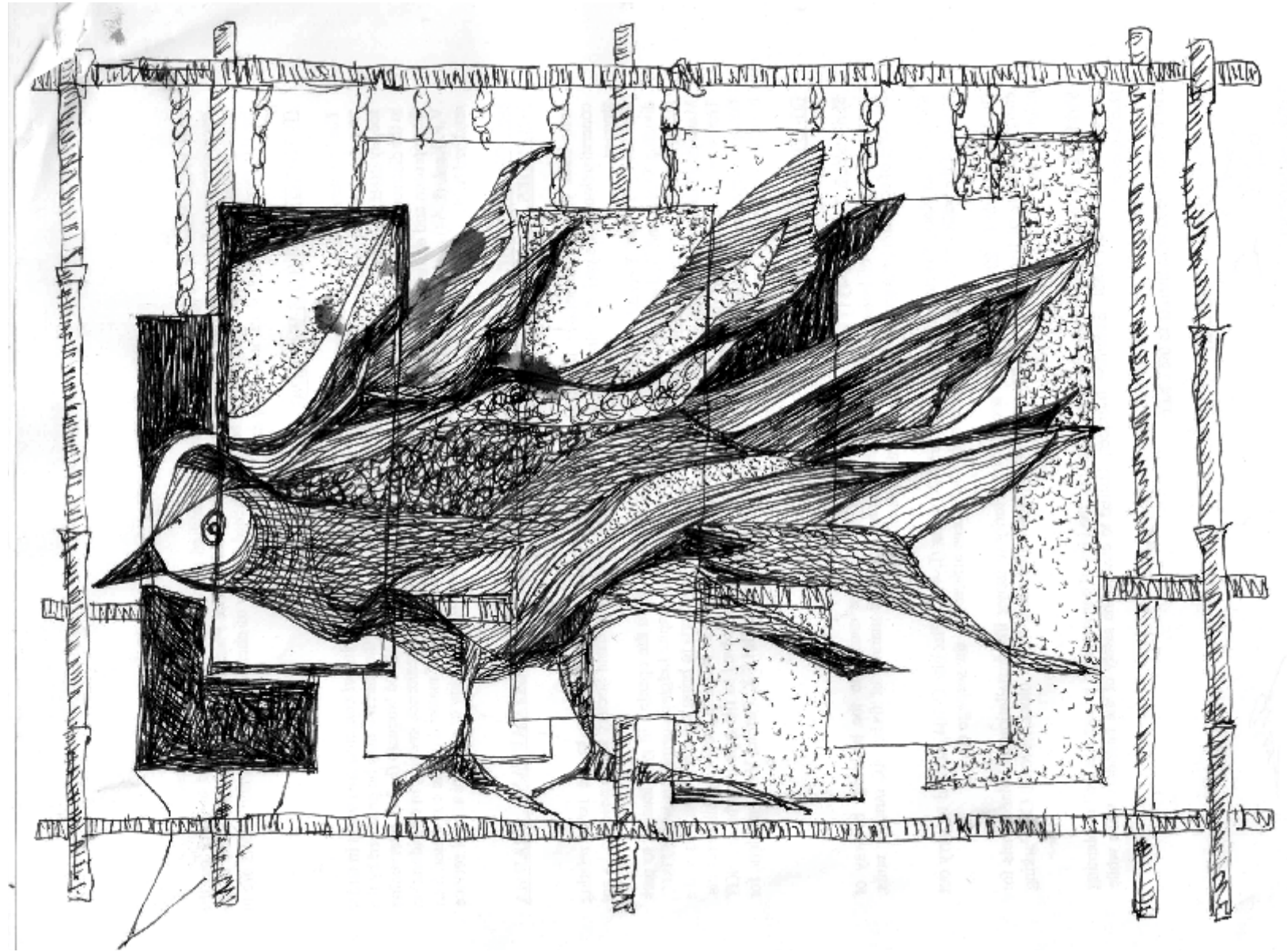

Installation 3 Large bird sketch installed in a 3d format on bamboo frames and vinyl prints to be install in front of NSD Foyer 10ft x 3ft Split Panel

Installation 2 Wooden Frames Square and circular wrapped with colorful cloths to be suspended from tree near the entrance gate.



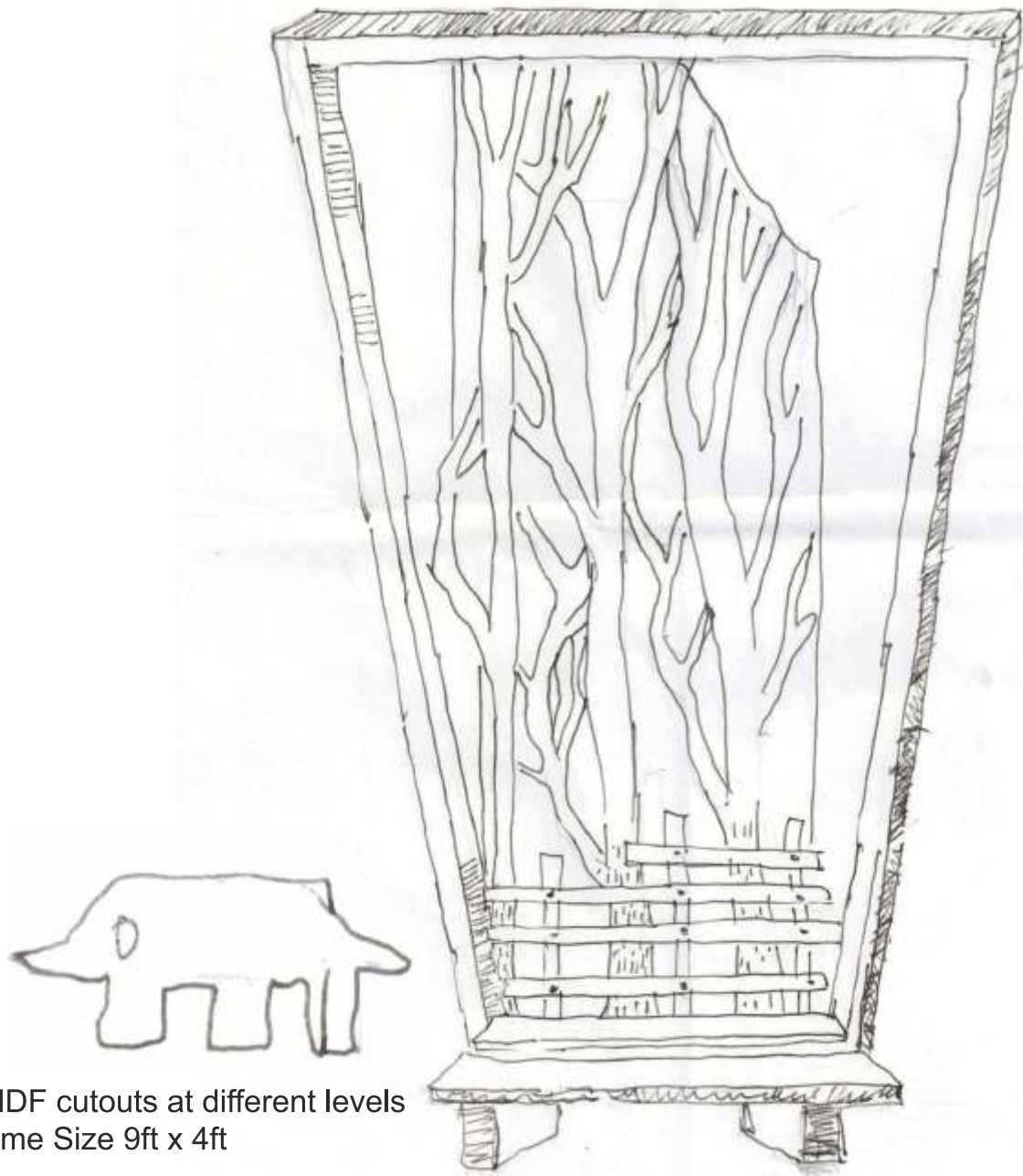

Installation 4 Wooden Frames with MDF cutouts at different levels along with different wooden toys (6No.) Frame Size 9ft x 4ft

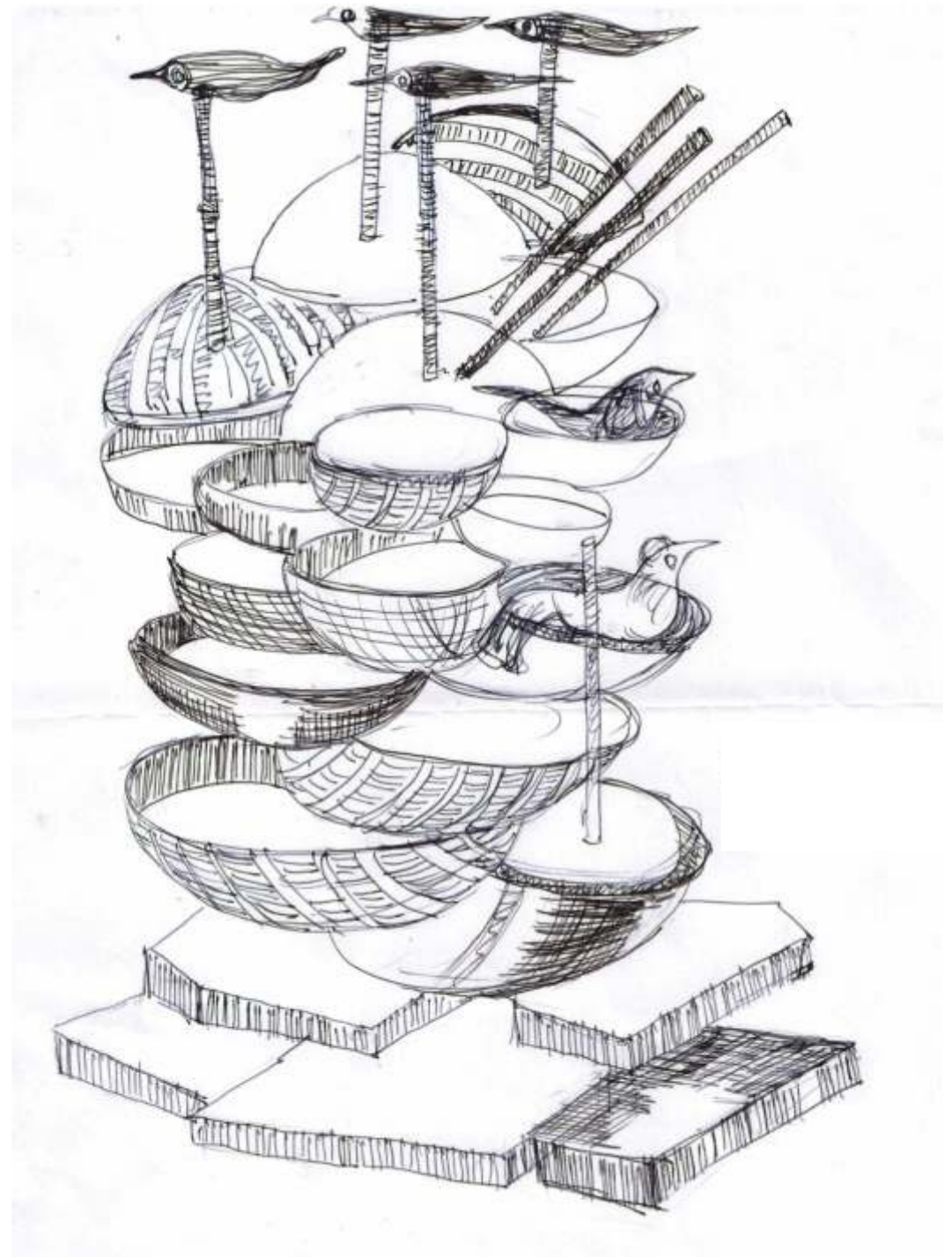

Installation 5 Bamboo basket and birds installation
and used cardboard also square shape

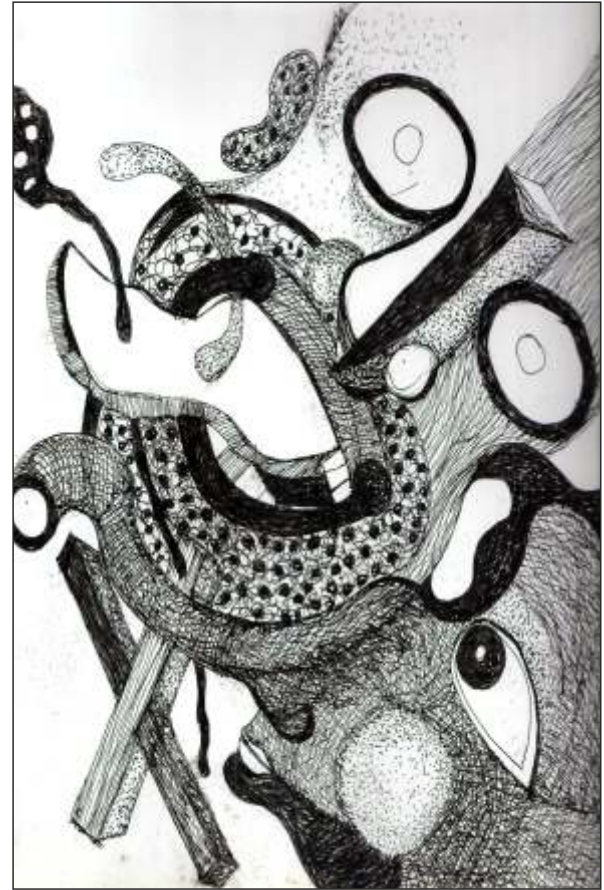

Installation 6a Portrait Drawing for scrolls to be suspended from the walls of abhimanch and other walls (6 Portrait) Split Panel



Installation 6b Portrait Drawing for scrolls to be suspended from the walls of abhimanch and other walls (6 Portrait) Split Panel

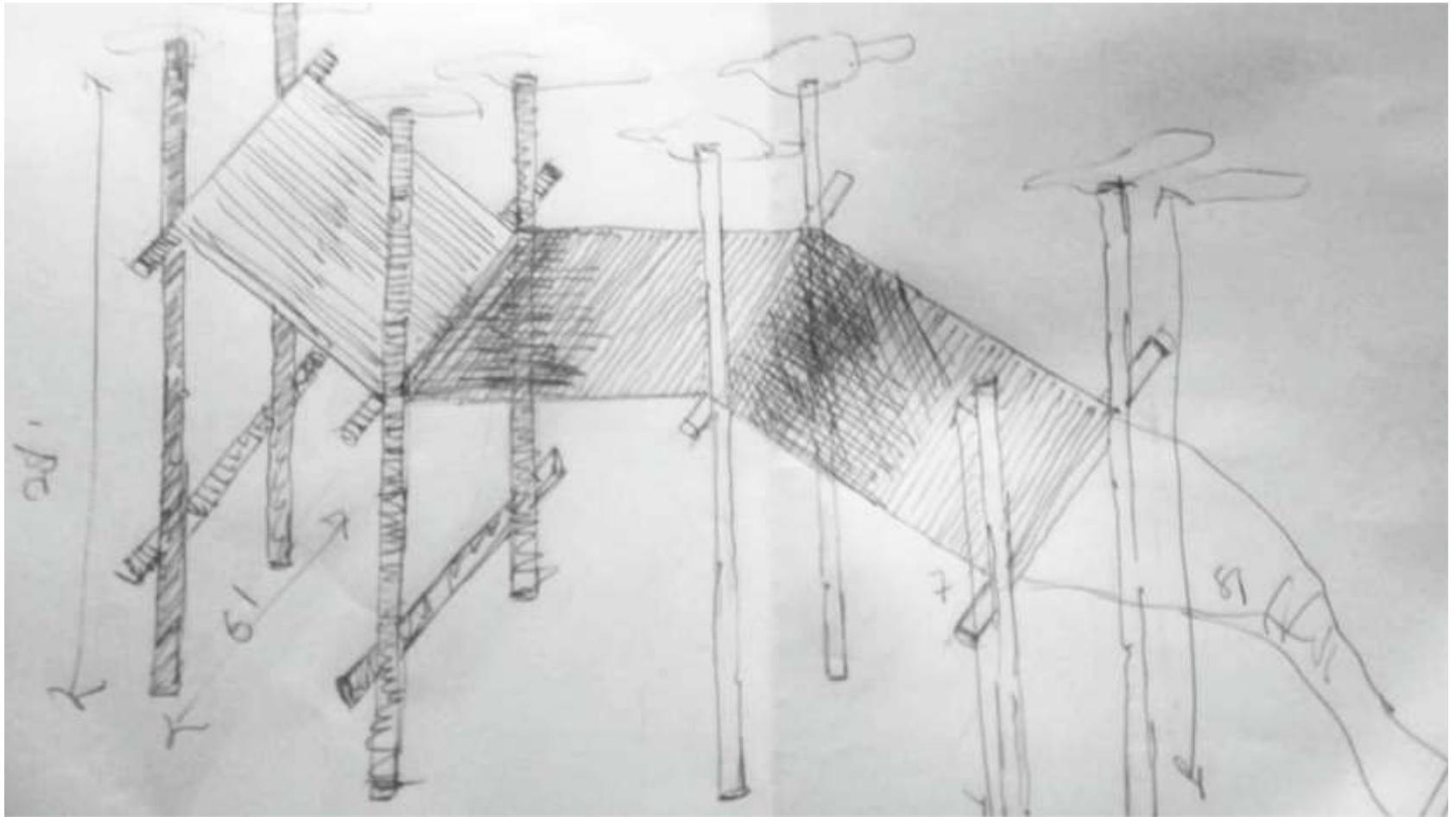

Installation 7 Installation using bamboo and colorful fabric to be installed into the large lawns

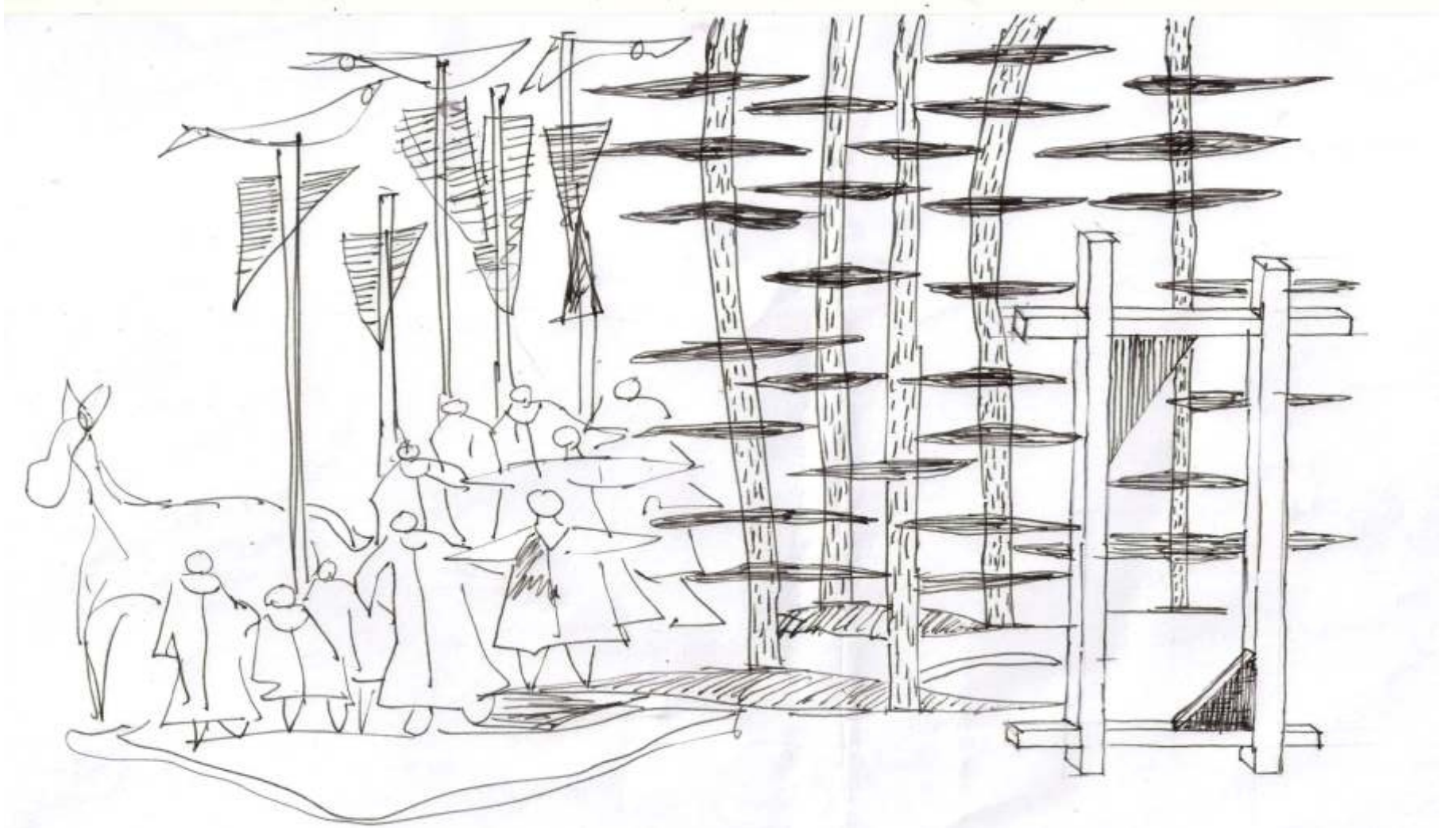

Installation 8 Installation using bamboo and colorful fabric to be installed into the large lawns
may be clubbed with installation no 7

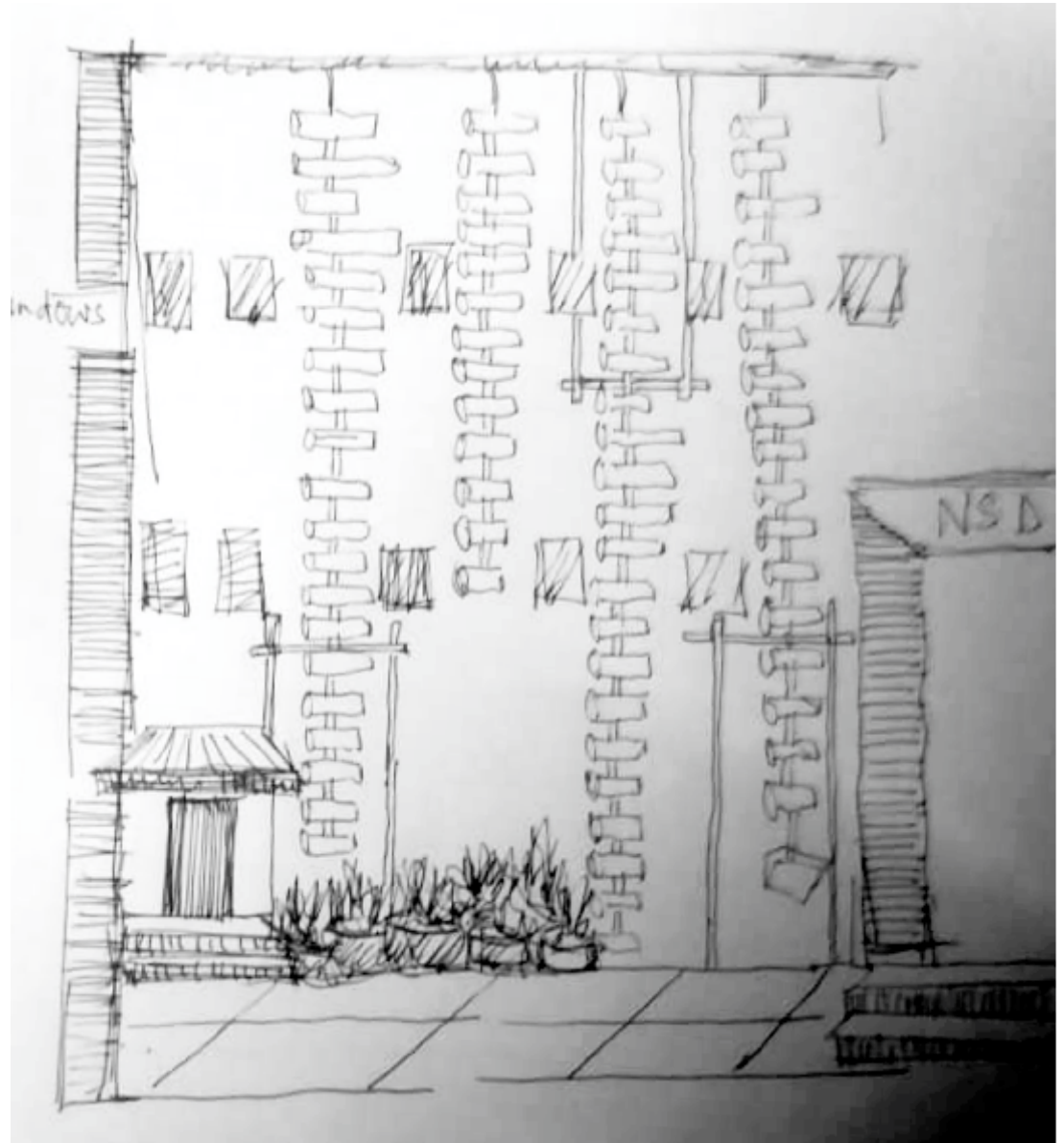

Installation 9 Bamboo hangings aprox 100ft

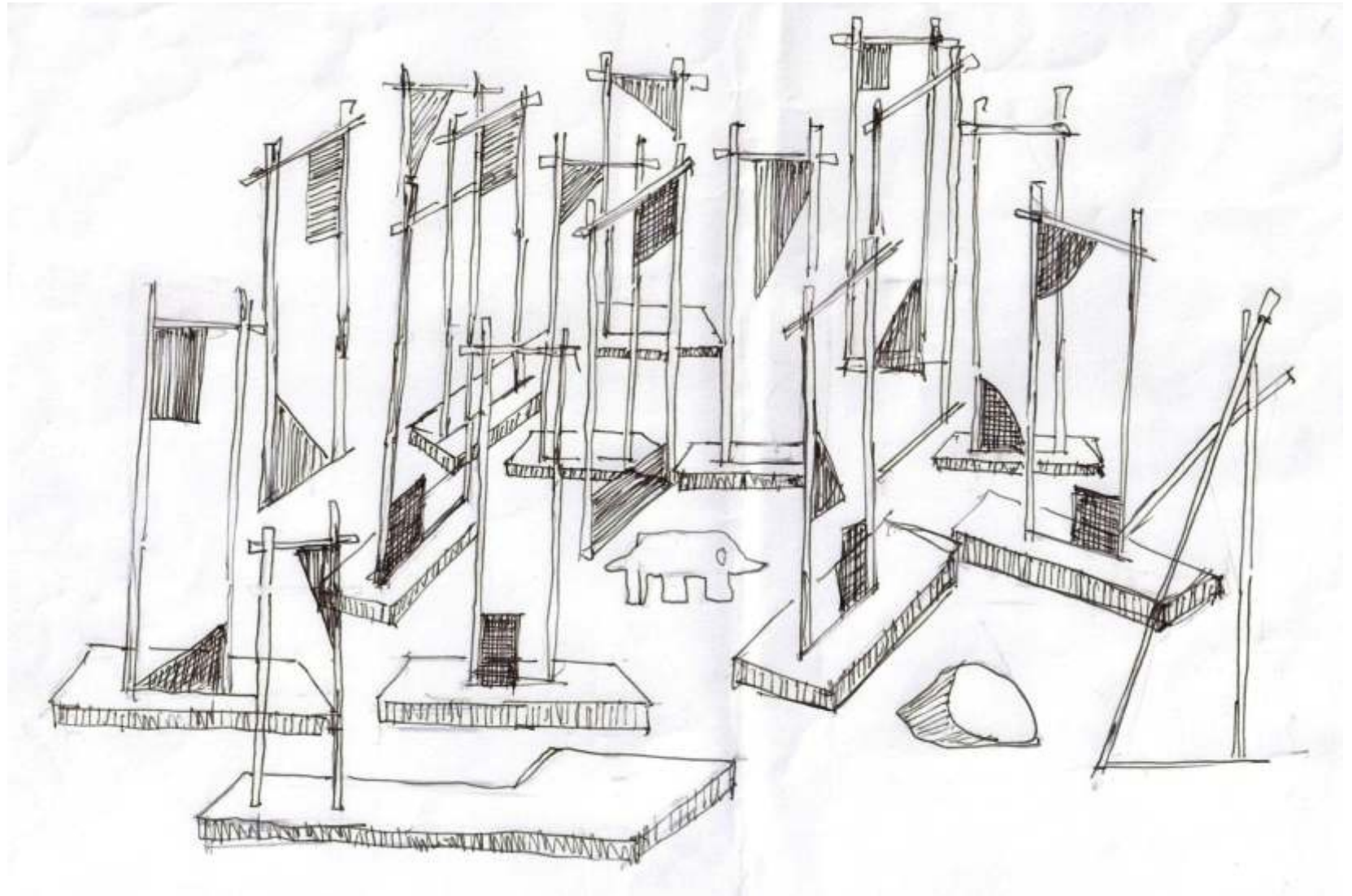

Installation 10 Individual wooden stands 11ft high along with fabric wrapped wooden cutouts placed individually or grouped together along with woodcut animals

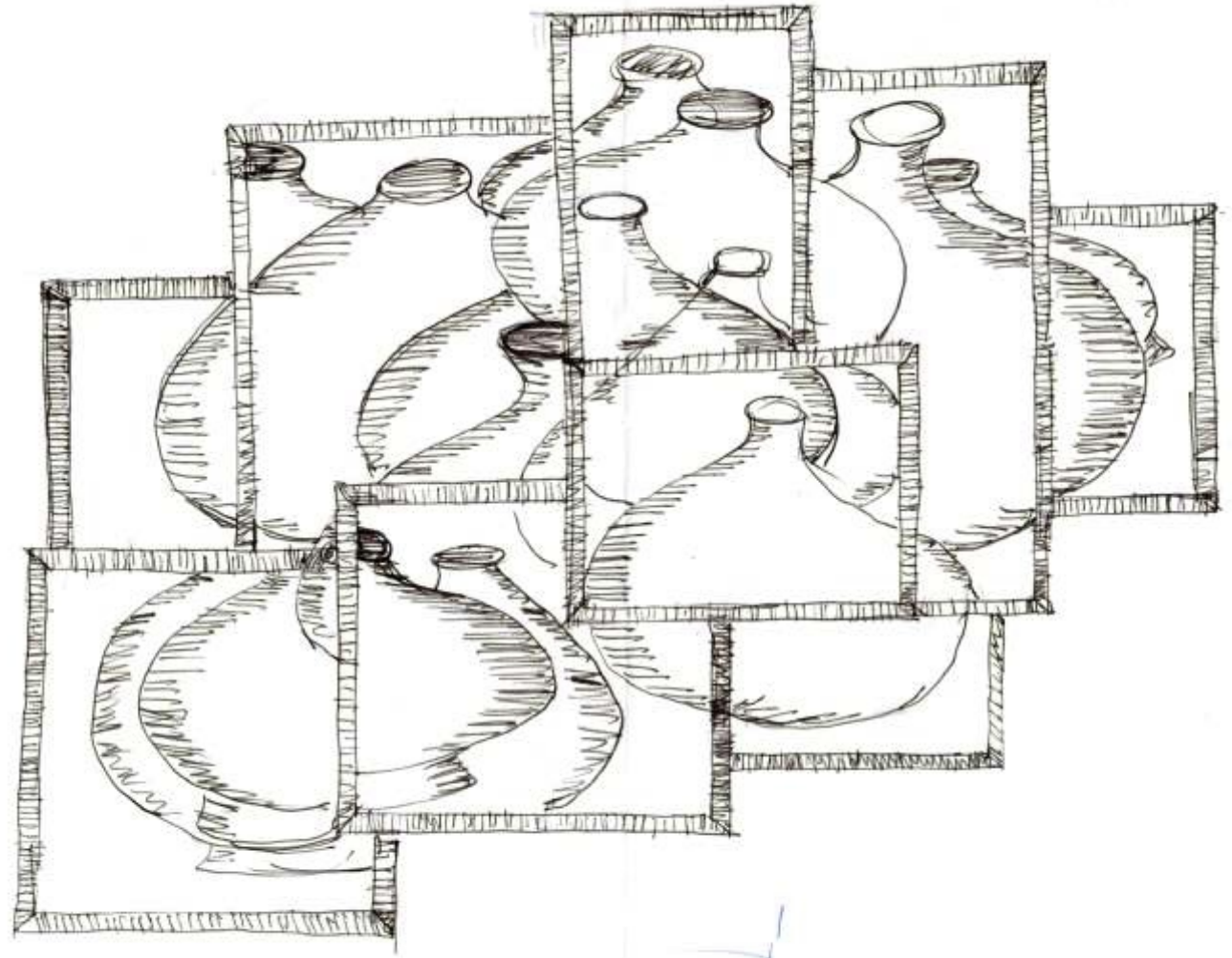

Installation 11 wooden frames and tracota pots cutouts fixed in relief format Environmental Friendly (Bamboos)

**20 wooden toys to be prepared to be placed
along with the installation**



Reference 1



Reference 2





Reference 5

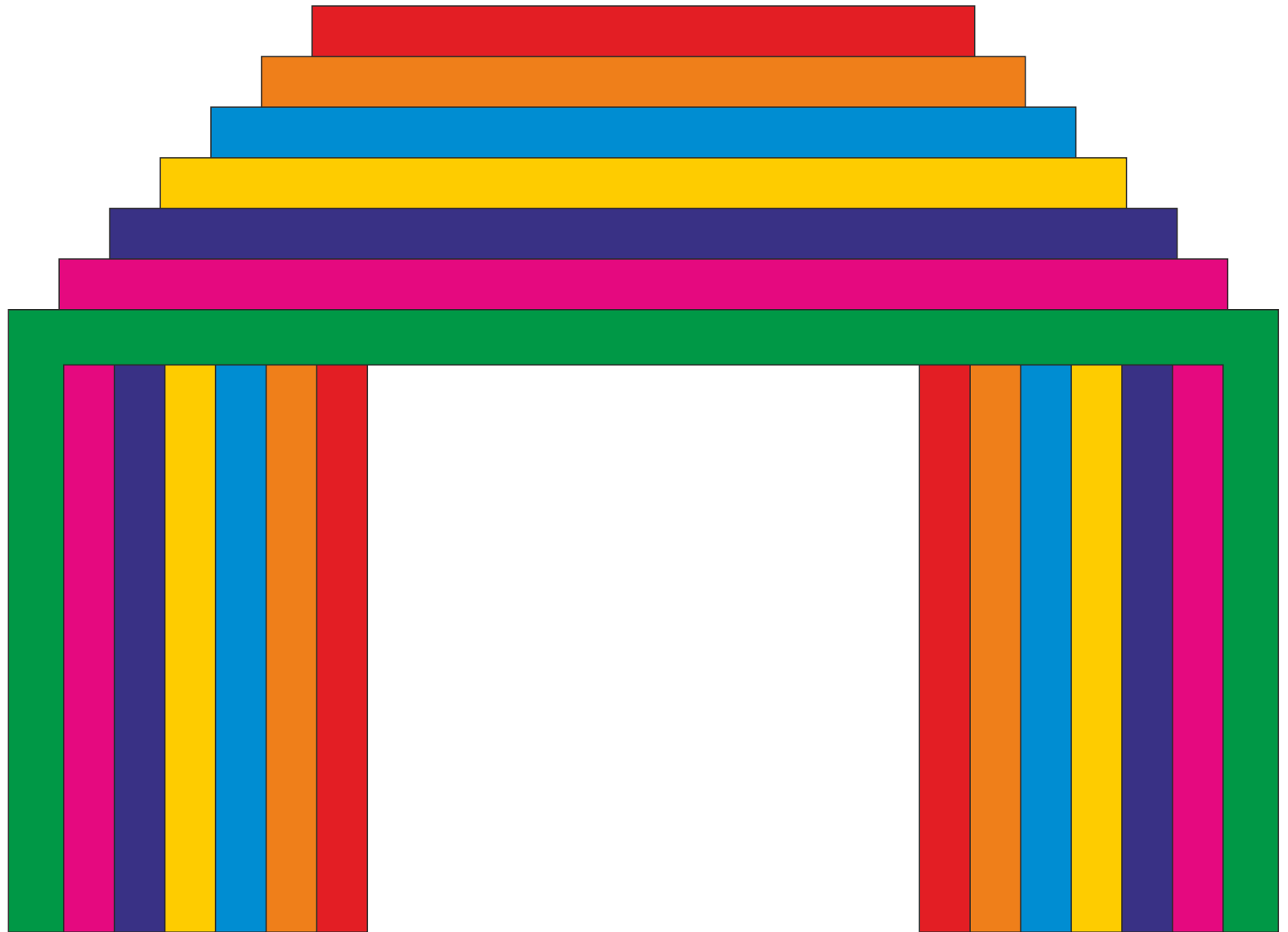

Gate Reference 1



Gate Reference 2
Tree Cutouts - No. 50 - Different Heights