

**NATIONAL SCHOOL OF DRAMA
NEW DELHI**

NSD Web Notice Inviting Offers for hiring of services for Light, Sound equipments, Set materials etc., Printing of Flex,(including fixing etc.) brochures and others.

National School of Drama, New Delhi is organizing North East Theatre Festival (Rashtriya Poorvotar Natya Samaroh) at Shillong (Meghalaya) and Nagaon (Assam) from 26th Feb to 8th March, 2019.

Offers are invited from service providers dealing in hiring of services for Transport Vehicles, Light, Sound equipments, Set materials etc., Printing of Flex,(including fixing etc.) brochures and others as per details in Annexures hereunder.

Service providers having experience in working for cultural events of Central/State Govt. organizations/Autonomous bodies/Corporations/PSUs etc. having PAN Card, Bank Accounts and sufficient transport vehicles, materials/equipments in required quantity as per requirement of NSD may please quote their barest minimum rates on or before 20th Feb, 2019 to the Registrar, NSD, New Delhi or e-mail to: registrar@nsd.gov.in; and/or : nsd.pns@gmail.com

Registrar

Ref. No. NSD/RPNS/2018-19

Dated: 13th Feb, 2019

Annexure – 1

Detail of Printing Material required by NSD for Theatre Festival at Shillong (Meghalaya) or the Nagaon (Assam).

S. No.	Particulars	Size	Qty
1.	Flex Printing	12'x 8'	
		10'x 16'	
		5'x 7'	
2.	Poster (Multicolour)	17''x 23''	200
3.	Folder (Multicolour) 10 nos. Of plays		1000
	Open size	9''x 6.5''	
	Closed size	4.5''x 9.5''	
4.	Invitation Card (Both side multicolour)	5''x 8''	500x2
5.	Envelopes		500x2
6.	Charges for wooden /Iron mounting		
7.	Providing and fixing them at proper location in the City/Town.		
8.	Leaflet/ poster despatch through newspaper etc.		

Annexure – 1

Detail of Transport Vehicles required by NSD for Theatre Festival at Shillong (Meghalaya) or the Nagaon (Assam).

S. No.	Type of vehicles	Rate/Rs. For 8 hrs.	Rate/Rs. For 12hrs.	Rate/Rs. For 24 hrs.	Extra Hrs.
	Cars/ Cabs				
1.	Innova				
2.	Swift Desire				
3.	Indigo				
4.	Indica				
5.	Scorpio				
6.	Bolero				
7.	Traveller i) 13 Seater ii) 17 Seater iii) 25 Seater				
8.	Bus i) 32 Seater ii) 36 Seater				

Note: Please indicate Terms & conditions of the following if applicable.

1. GST
2. Toll Tax etc
3. Driver and helper allowance (per day)
4. Bata (Food Allowance)

Note: The parties of Shillong (Meghalaya) and Nagaon (Assam) may please keep following information also in mind while quoting for various rates in proforma or suitably modify it:-

- Rate for Guwahati Rly. Station/Airport to Nagoan to Shillong and back to Guwahati.
- Rate for Guwahati Rly. Station/Airport to Nagoan dropping and pickup.
- Rate for Guwahati Rly. Station/Airport to Shillong drooping and pickup.
- Rate for Local city Nagoan and Shillong.

RASHTRIYA POORVOTTAR RANG UTSAV

Set up 26th FEBRUARY 2019
Performance date – 27 February – 8 March 2019

Lights for NAGOAN:

Following are basic requirement for the festival which should be quoted on lump sum basis/package.

1. PC = 25 pcs
2. Par = 20 pcs
3. Profile = 6 pcs (50* , 36*)
4. LED PAR (RGBW) = 10 pcs
5. Power pack (Dimmer) = 24 x 4 kw each
6. Console Board – Avolite or Any Programmable 48/60 channel Board.
7. T- Stand (14 foot high) – 2 pcs.
8. Stand Telescopic -- 6 pcs.
9. Colour Papers –All Colours
10. Truss – 40'x20' – 1 nos.

Extra Lights on Per day basis: (if required)

1. Cyc Flood – 8 Pcs.
2. Smoke = 2 pcs ,
3. Profile (50*, 36*). ,
4. Fresnel 1000 wt,
5. Strobe light ,
6. Ultra Violet Tube*(not LED Tube)- 4 Nos

Video for NAGOAN:

Video: (Date – 28/02/2019 for one day only)

Projector – 3000 Luminous with Screen and Laptop– 1 nos. for Subtitle.

RASHTRIYA POORVOTTAR RANG UTSAV

SHILONG

Set up 28th FEBRUARY 2019

Performance date – 1– 10 March 2019

Lights for SHILLONG:

Following are basic requirement for the festival which should be quoted on lump sum basis/package.

1. PC = 25 pcs
2. Par = 20 pcs
3. Profile = 6 pcs (50*, 36*)
4. LED PAR (RGBW) = 10 pcs
5. Power pack (Dimmer) = 24 x 4 kw each
6. Console Board – Avolite or Any Programmable 48/60 channel Board.
7. T- Stand (14 foot high) – 2 pcs.
8. Stand Telescopic -- 6 pcs.
9. Colour Papers –All Colours
10. Truss – 30'x18' – 1 nos.

Extra Lights on Per day basis: (if required)

1. Cyc Flood – 8 Pcs. 2. Smoke = 2 pcs , 3. Profile (50*, 36*). , 4.Fresnel 1000 wt, 5. Strobe light ,6. Ultra Violet Tube*(not LED Tube)- 4 Nos

Sound & Video for SHILLONG:

Set up 28th February 2019

Performance date – 1 – 10 March 2019

1. Sound box – 4 pcs.
2. Monitor (on stage) – 2 pcs.
3. Mixer – 24 channel.
4. Mike(SM 57/58)(for vocal/instrument) – 6 pcs.
5. Floor mike – 4 pcs.
6. Amplifier – As required.
7. CD player – 1 pcs.
8. Tini to phono Jack – 2 pcs.
9. Condenser mike – 4 pcs.
10. Laptop – 1 pcs.
11. Cordless mike – 1 nos.

Video : (Date – 02/03/2019 for one day only)

Projector – 3000 Luminous with Screen and Laptop– 1 nos. for Subtitle.

RASTRIYA POORVOTAR NATYA SAMAROH

SET REQUIREMENT as per Design & Measurement , NAGOAN

Play – Gul – E – Bakawali

Date – 27.2.2019

SET: Wooden Platform 2’X6’X1.5’ht: 1 No.

Wooden Square Stand: 1’X1’X 2.5’ ht: 2 Nos.

Play – karnbharam

Date – 28.2.2019

- 1. Black Curtain in back**
- 2. Wooden Platform – 4’x4’x1’ painted black**
- 3. Banana Tree – 6’ Height – 6 nos.**
- 4. Wing to Wing Platform – width – 1.5’ to 2.5’ , Height – 1’ or 2’**

Play – Mahanirvan

Date –1.3.2019

Platform – 6'x4'x1' – 2 nos. (Mask & Painted Black)

Platform – 6'x3'x1' – 7 nos. (Mask & Painted Black)

Play – Loha Kutt

Date – 2.3.2019

Black - F (for kitchen)
Quantity - 01 No

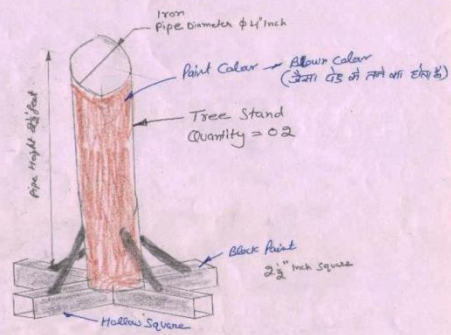
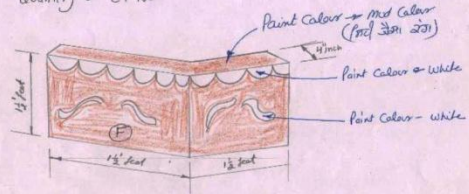

Charpai = 01

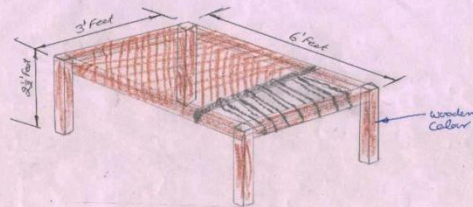

Block - E (for making Bhatti)

Quantity → 01 No

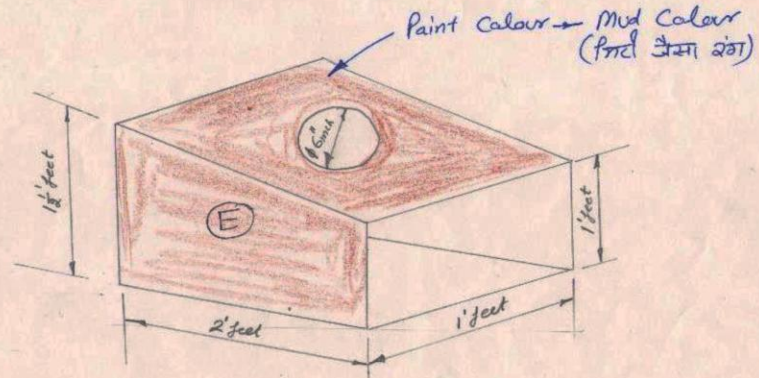

Block G for Making (4' x 4' x 1/2' feet)

Quantity → 08 No

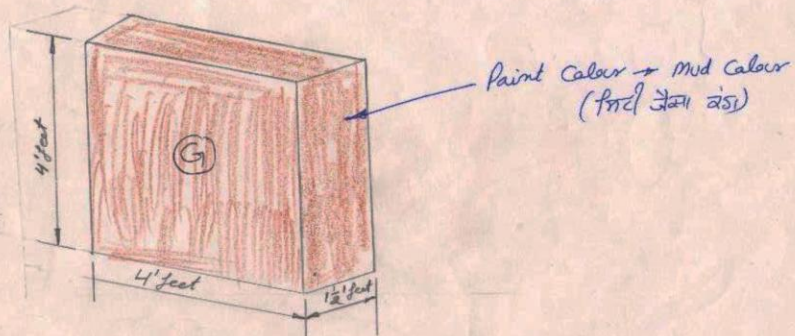

कुम्भ (2 x 1 1/2 feet) ①
दोस्तुल मरु 1 x 1 1/2 feet ②
1 1/2 x 1 1/2 feet ③
1 1/2 x 1 1/2 feet ④
1 1/2 x 1 1/2 feet ⑤
1 1/2 x 1 1/2 feet ⑥
1 1/2 x 1 1/2 feet ⑦
1 1/2 x 1 1/2 feet ⑧

Block - C (for wall)
Quantity = 02 No

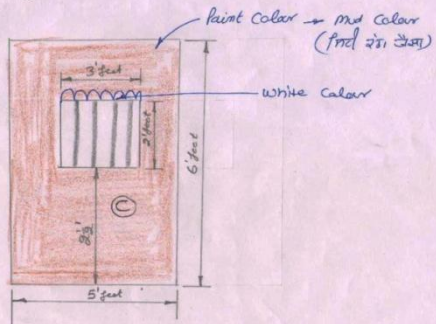

Block - A (for wall)
Quantity = 01 No

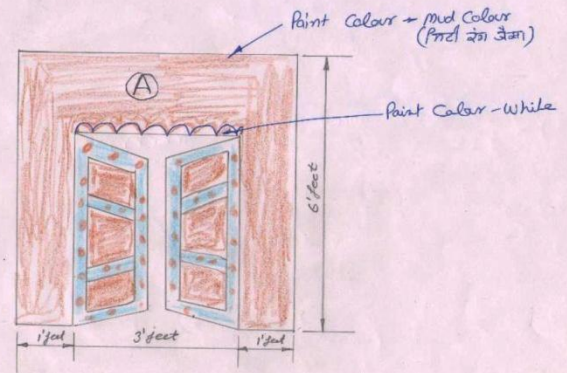

Block - D (for wall)
Quantity = 3

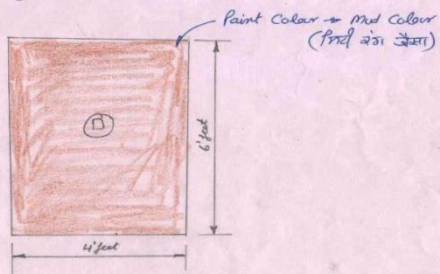

Block - B (for wall)
Quantity = 01 No

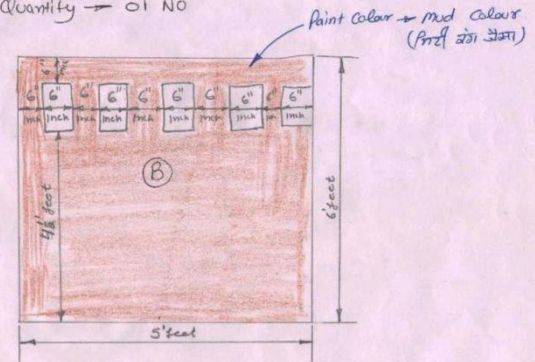

Technical detail of Play “LOHA KUTT”

1 Drawing of required wooden Blocks for making set are attached with mail including quantity, size, and required color also kindly check it

2 Lighting requirements : (a) 20 No CP64 par light with 1000 watt lamp

(b) 16 No L.D lights

(c) 12 No Profile with Irish cutter

3. Sound requirements : Normal Sound as Music operated by laptop

4 Properties Requirements

A) Iron Bucket (□□□□ □□ □□□□□□) 01 No

B) Old Agriculture equipment Such as (Kassi □□□□□ , kulhari □□□□□□□□□, drati □□□□□, cheni □□□□ ,reeti □□□□ , old talwar,□□□□□□ □□□□□)

C) Dummy sledge Hammer Made from iron hollow pipe

D) old iron chain 2 feet length (□□□□□□ □□□□ □□ □□□□□)

E) constructional Bricks 20 No

F) Tokra □□□□□ 02 No

G) brass utensils commonly used in kitchen

5. Photograph of set of play are also attached

PLAY LOHA KUTT YOU TUBE LINK FOR SET REFERENCE

<https://www.youtube.com/watch?v=z8rw-2jdUM4>



Play – Hum Mukhtara

Date – 3.3.2019

① One opposite two

1)

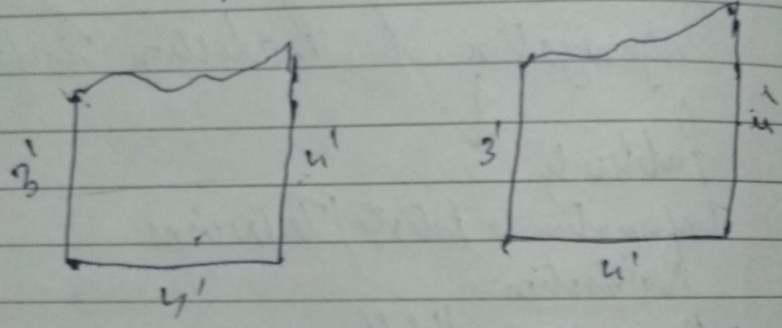

②

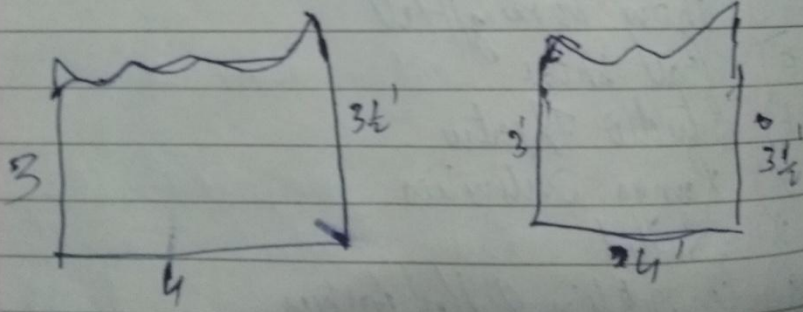















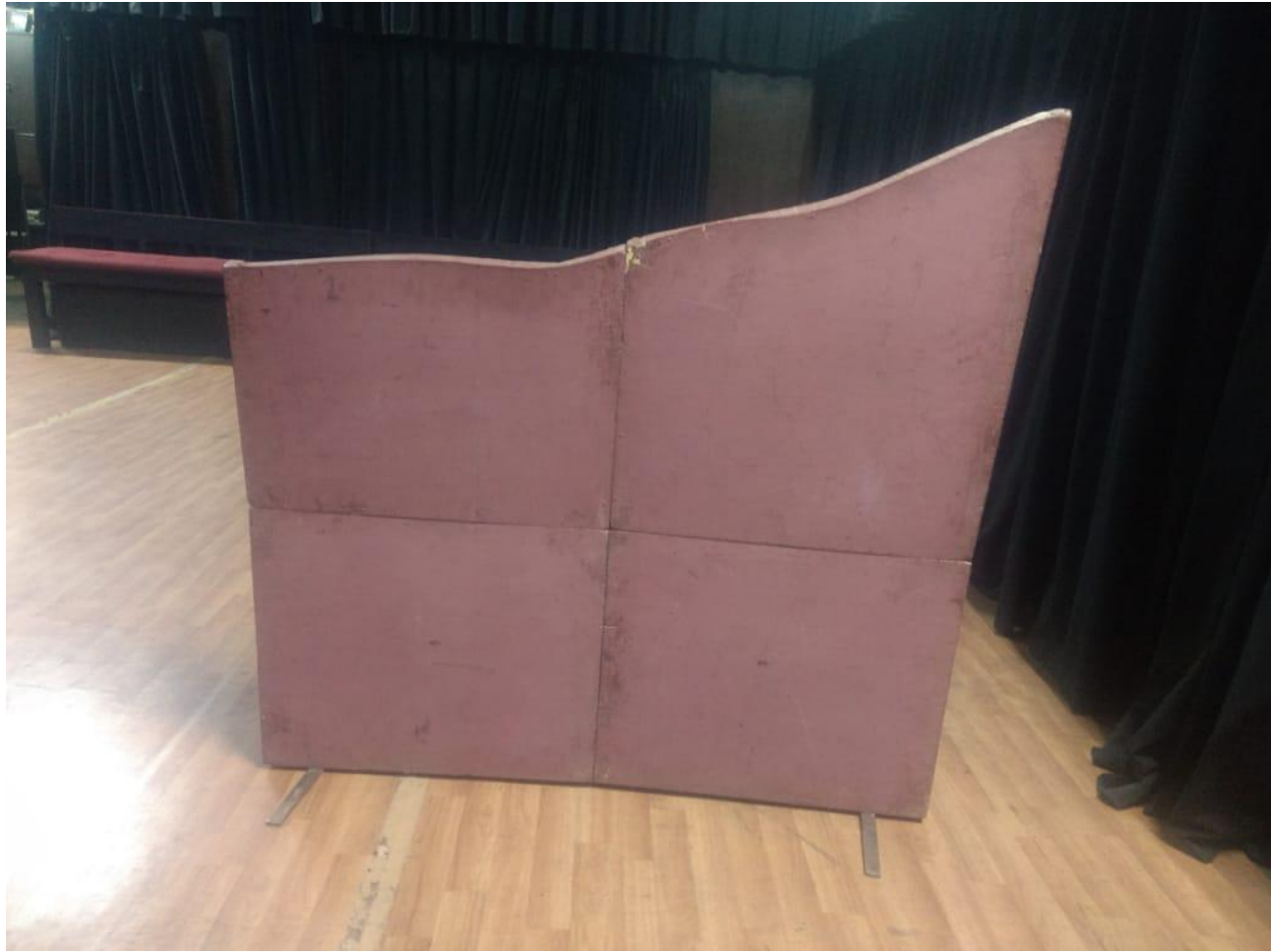



'HUM MUKHTARA'

- 1) Lantern -- 20
- 2) School Board -- 15
- 3) Torch -- 30
- 4) Gita (Quran) -- 01
- 5) Signature Paper -- 04
- 6) Ink pad -- 01
- 7) Cheque -- 01
- 8) Jay Namaz -- 01
- 9) Kite -- 01
- 10) Doll -- 02
- 11) Red Curtain -- 02
- 12) Salma Choti -- 01
- 13) Court Board -- 01
- 14) Gun -- 05
- 15) Choti -- 14
- 16) Dholl -- 02
- 17) Costume Box -- 01
- 18) Prop Box -- 02
- 19) Doll's Dopatta, Kurta, Salwar - 01 each
- 20) Kaji's Mora -- 01
- 21) Yellow Big Torches - 02
- 22) Charging Wire -- 02
- 23) Kerosene Oil -- 2 Ltrs
- 24) Funnel -- 01
- 25) Hurricane's Fita -- 4 Bundles

Play – Ashad ka Ek Din

Date – 4.3.2019

Sets & Furnitures

Sl. No.	Particulars	Quantity
1.	Platforms (6' × 4')	4 Pieces
2.	Platforms (Triangular) - See Drawing	5 Pieces
3.	Stair Case - See Drawing	2 Pieces
4.	Bamboo Poles - See Drawing	4 Pieces
5.	Plug in Shelf for Utensils- To be pushed & adjusted inside the Platform- See Drawing	1 Piece
6.	Woven-Chulha - Length-3' × Depth-1'6" × Height-1'6"	1 Piece
7.	Stool with Legs (Chauki) - Length-1' 6", Depth-1' 6", Height-15"	1 Piece
8.	Cubic Stool - Length-1' 6", Depth-1' 6", Height-1'- Polished	1 Piece
9.	Cubic Stool Different Style - Length-1', Depth-1', Height1' - Polished	1 Piece
10.	Bed-Cot - Platform- Length-5', Depth-2'6", Height-1'6"	1 Piece
11.	Table - Length-2', Depth-2', Height-2',	1 Piece
12.	Deepmalika (Off White)- See Drawing	1 Piece
13.	Long Block for Seating - Length-3', Depth-1', Height-9" - Polishsed	2 Pieces
14.	Clay made Urns (Tall <i>Haandi</i> or <i>Jaala</i> in Traditional name) - See Picture of the SET.	2 Pieces



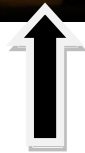

CUBIC STOOL- Length-1', Depth-1', Height1'



 LONG BLOCK for Seating - Length-3', Depth-1', Height-9 inches



STOOL - Length-1' 6 inches, Depth-1' 6 inches, Height-15 inches

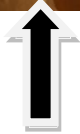

STOOL - Length-1' 6 inches, Depth-1' 6 inches, Height-1'





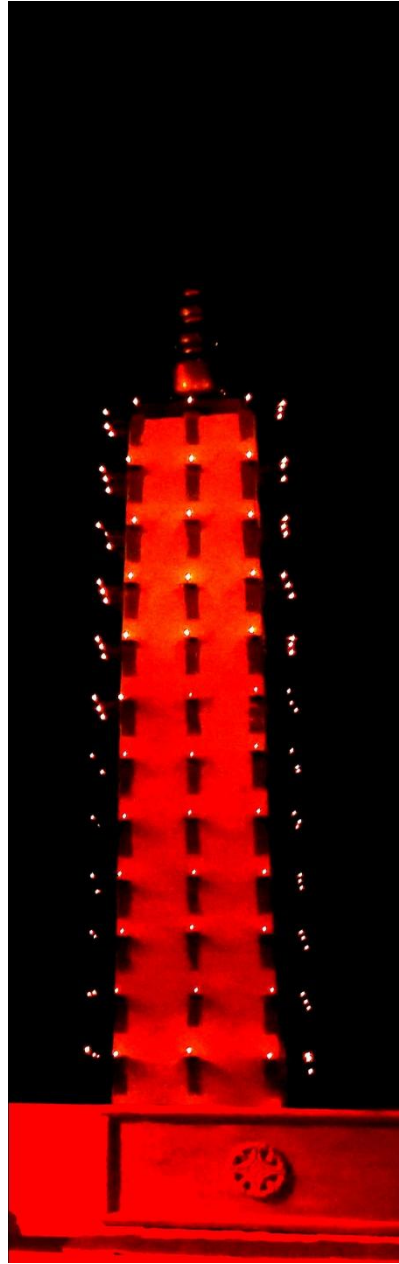





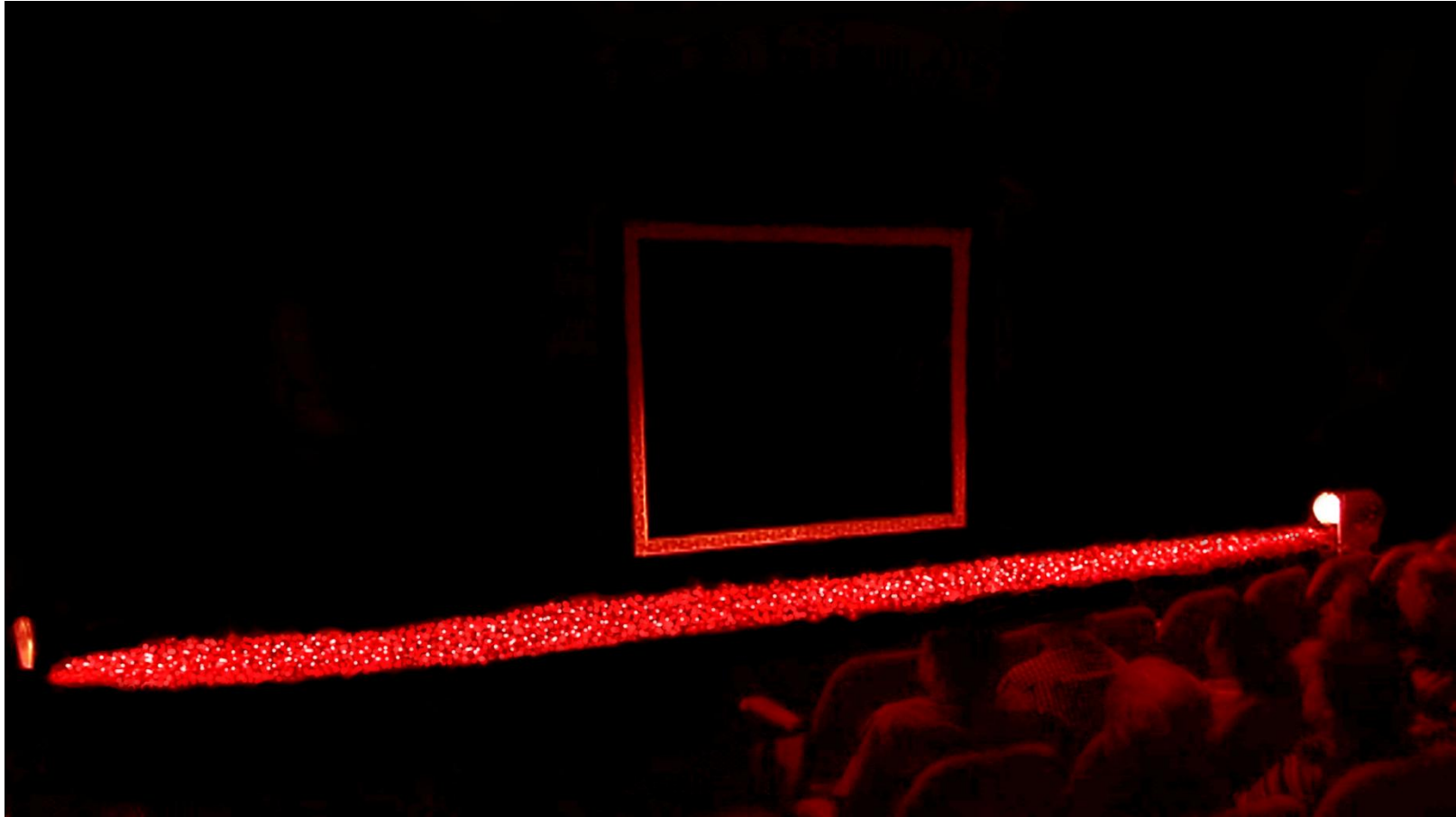

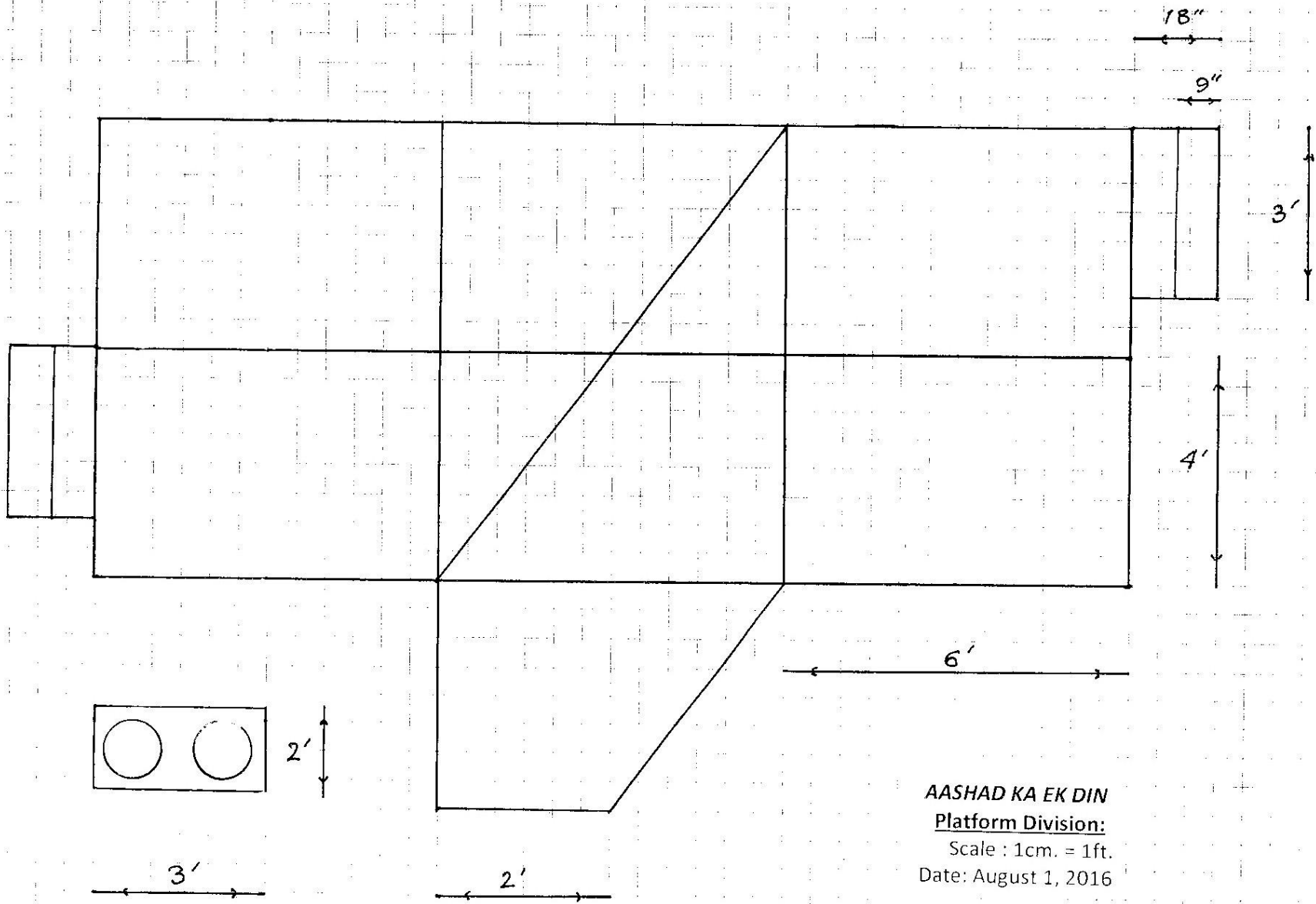

AASHAD KA EK DIN
Platform Division:
 Scale : 1cm. = 1ft.
 Date: August 1, 2016

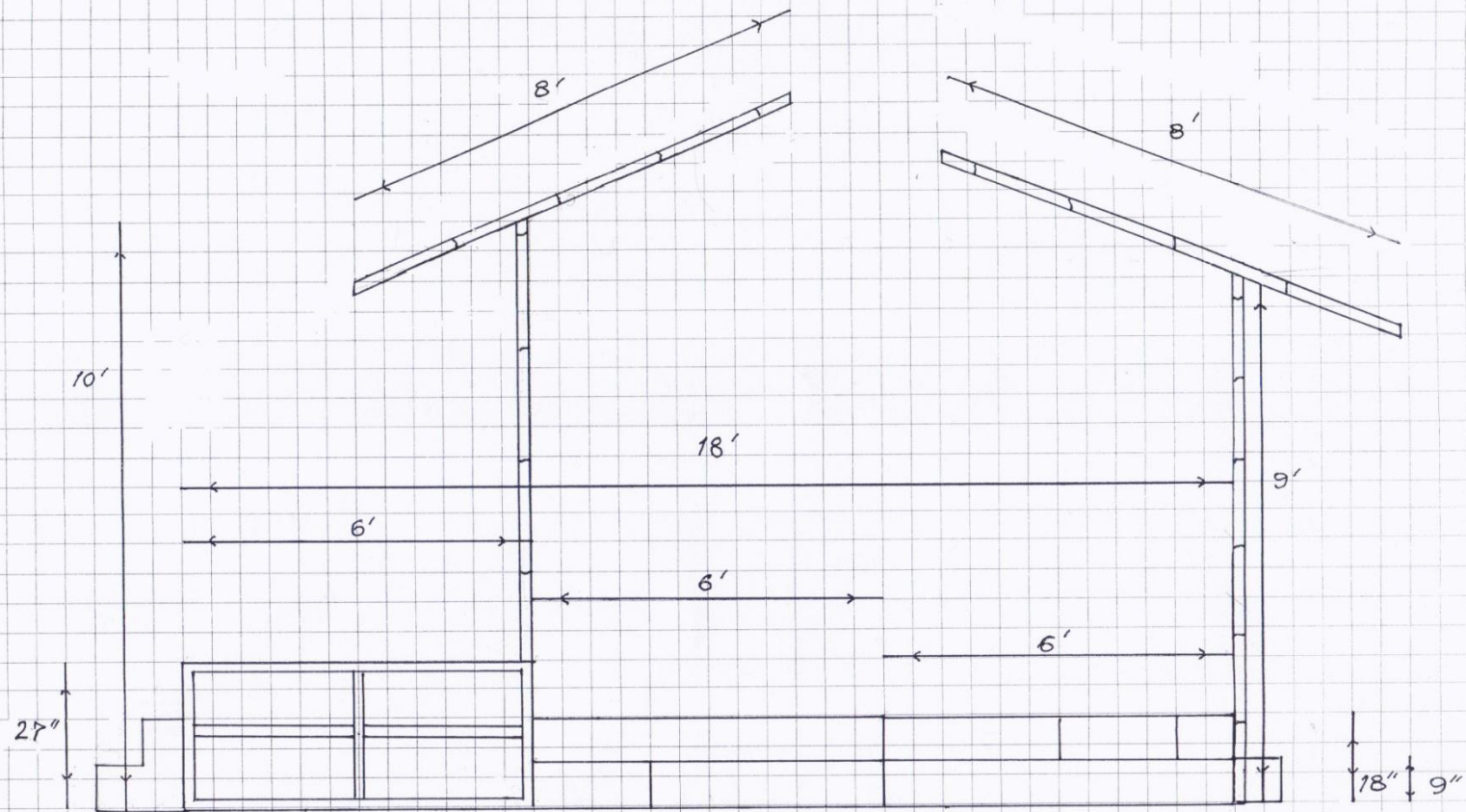

AASHAD KA EK DIN

Front Elevation:

Scale : 1cm. = 1ft.

Date: August 1, 2016

Approx. Adjusted.

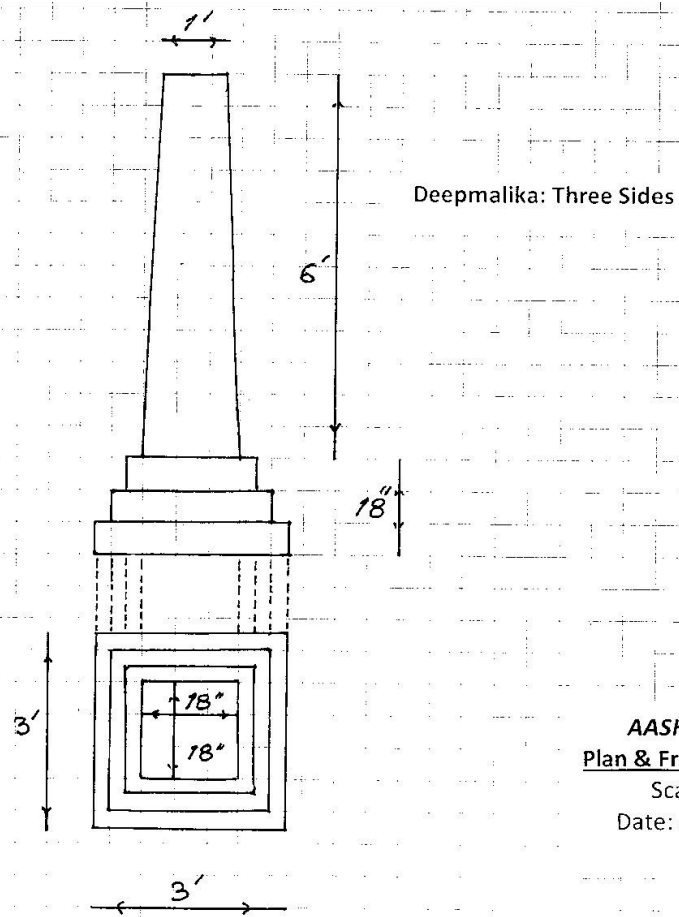

AASHAD KA EK DIN
Plan & Front Elevation:
 Scale : 1cm. = 1ft.
 Date: August 1, 2016

Furniture to be made:

- 1) **Stool:** Length-1'6", Depth-1'6", Height-15"
- 2) **Stool:** Length-1'6", Depth-1'6", Height-1'
- 3) **Stool:** Length-1', Depth-1', Height-1'
- 4) **Table:** Length-2', Depth-2', Height-20"
- 5) **Cot:** Length-5', Depth-2'6", Height-1'6"
- 6) **Long Block for Seating:** Length-3', Depth-1', Height: 9" - 2 Nos. (All the Furnitures are to be polished or Varnished. Floral motif will be brought by Circle Theatre, New Delhi.)

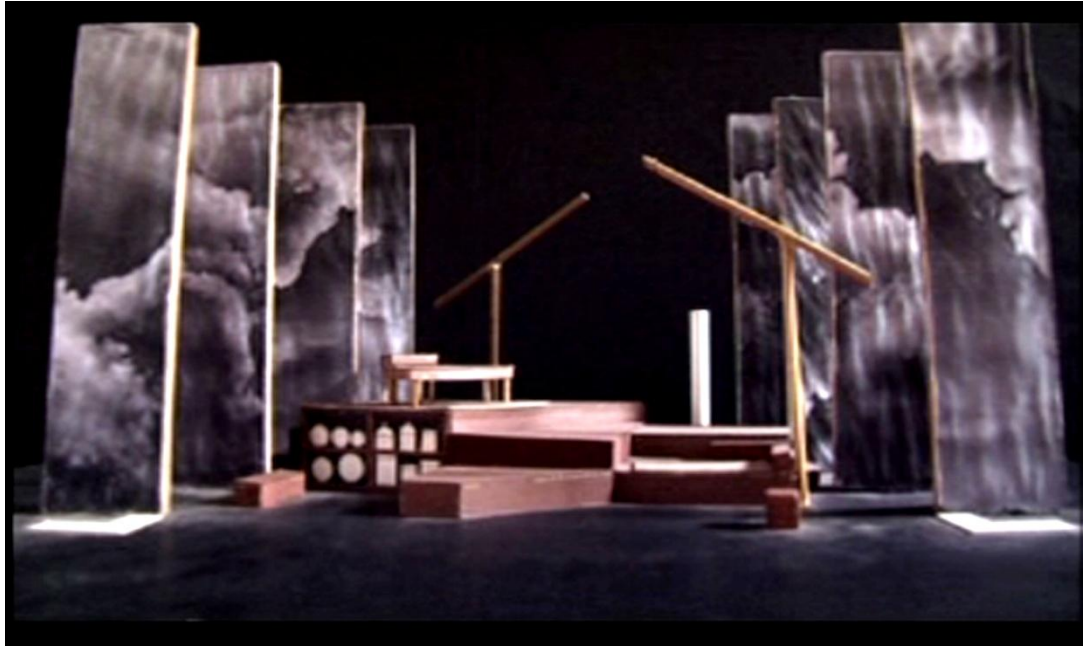





Play – Doodhan

Date –5.3.2019

Platform – 6'x'6'x9" –1 nos.

Platform – 4'x4'x9" – 1 nos.

Frame – 6'x5' – 2 nos. (With stand)

SHAKUN

Chopra Brothers, Jaipur. Ph: 0141-2314282 | Rajasthan Tea Traders, Bikaner. Ph: 0151-2523275

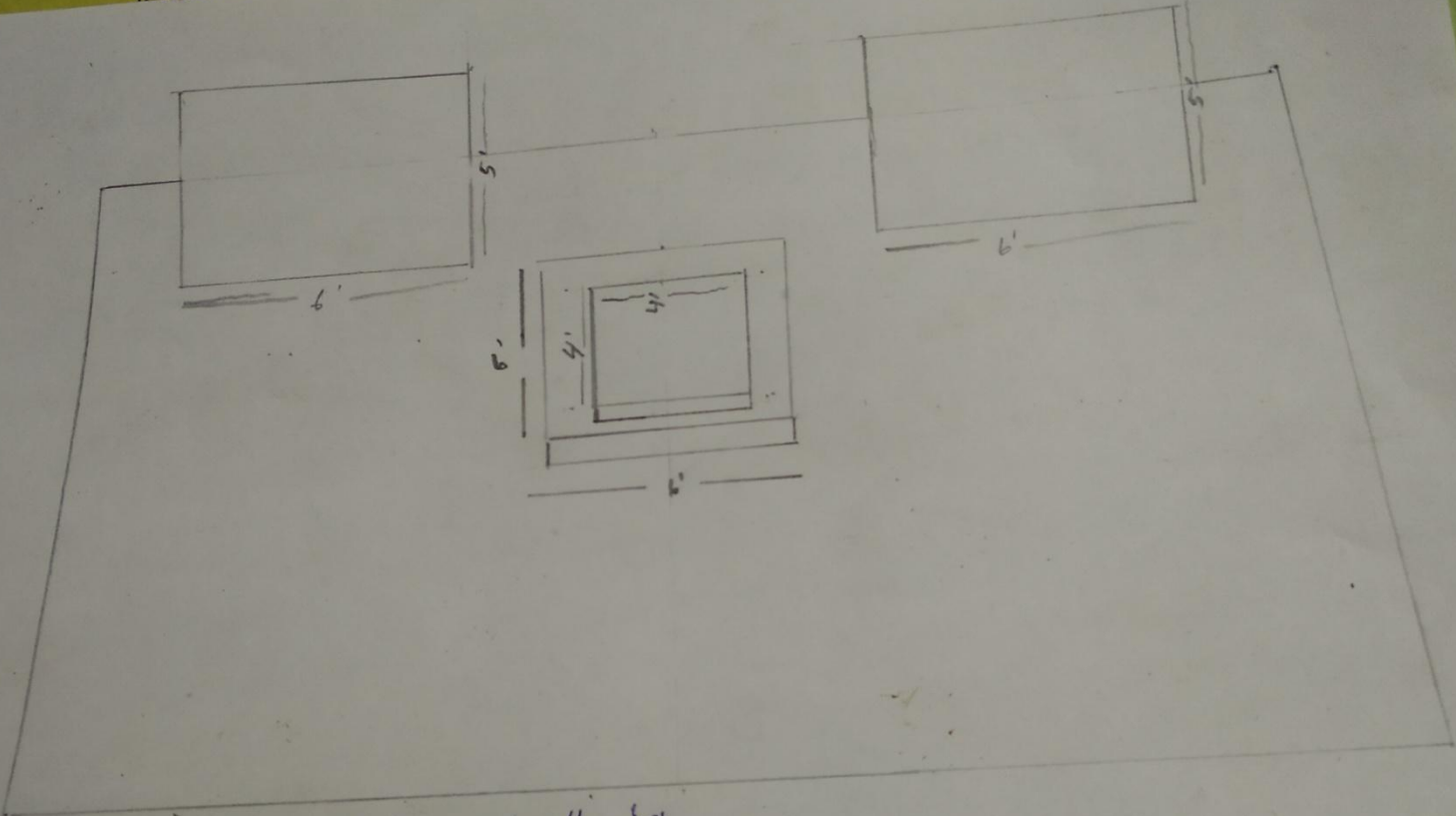

Two Platforms.
 4x4 ft Height 75" inch (2) 6x6 ft Height 75" inches
 Two Blank frames. 6x5' ft (standable)

Play-- Court Martial

Date – 6.3.2019

1. Platform – 6'x4'x18" – 8 nos.
2. Wooden chair – 9 nos.
3. Revolving Chair – 1 nos.
4. Centre table – 3'x2'x2' – 1 nos.
5. Stool – 18" height.
6. Witness Box – 3.5'x3.5'x3' – 1 nos.
7. Platform – 6'x3' – 2 nos.
8. Glass – 12 nos.

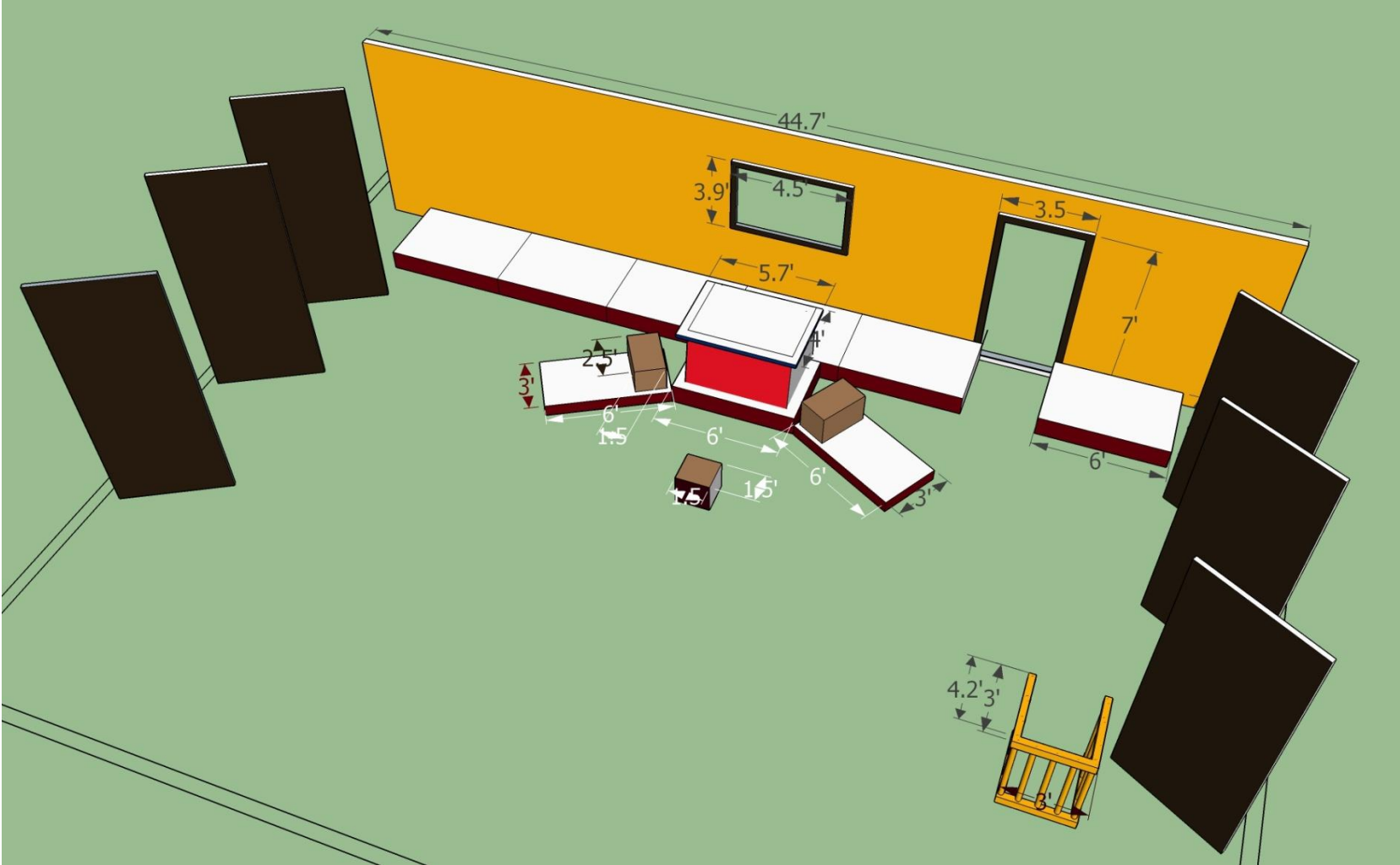

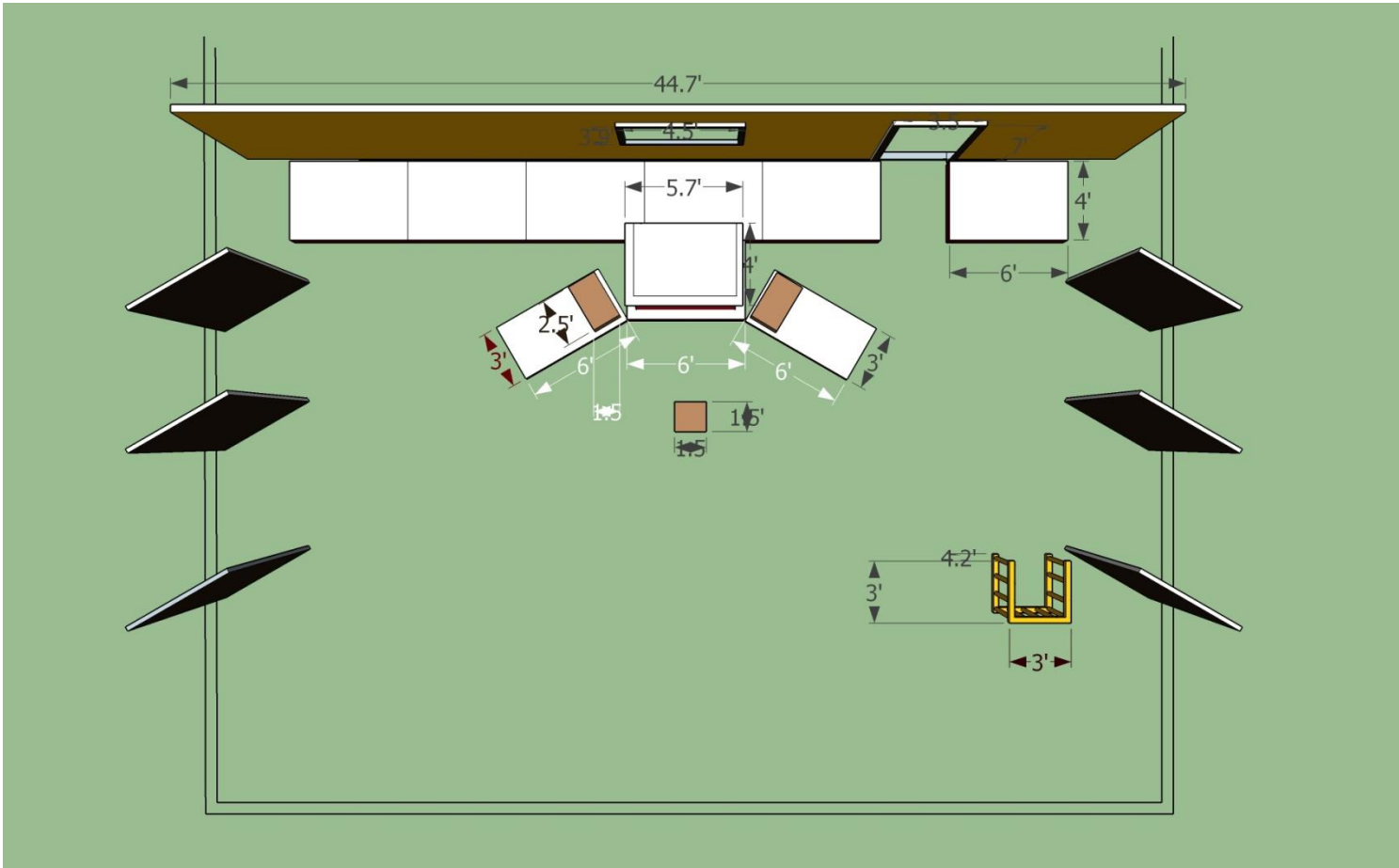

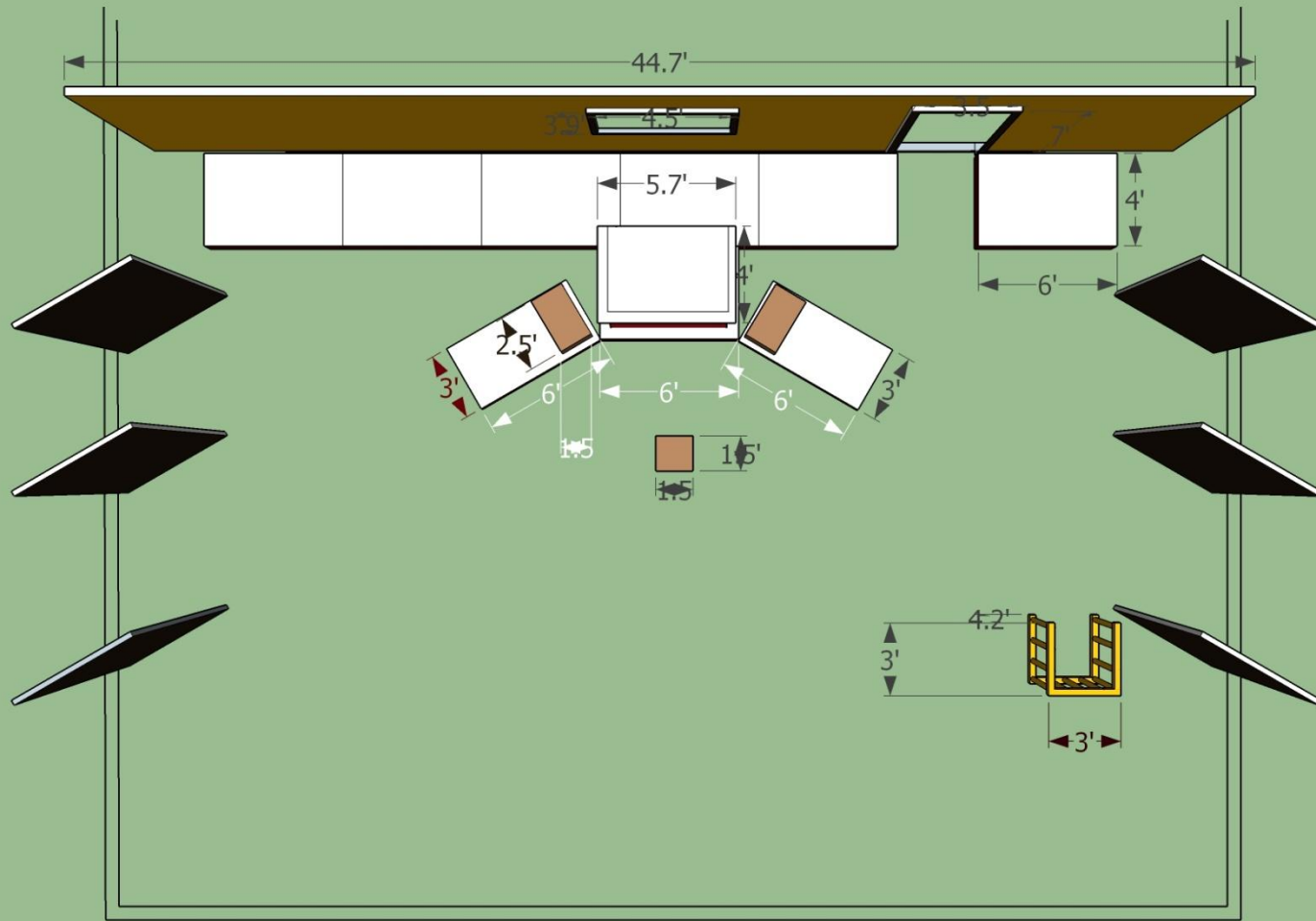



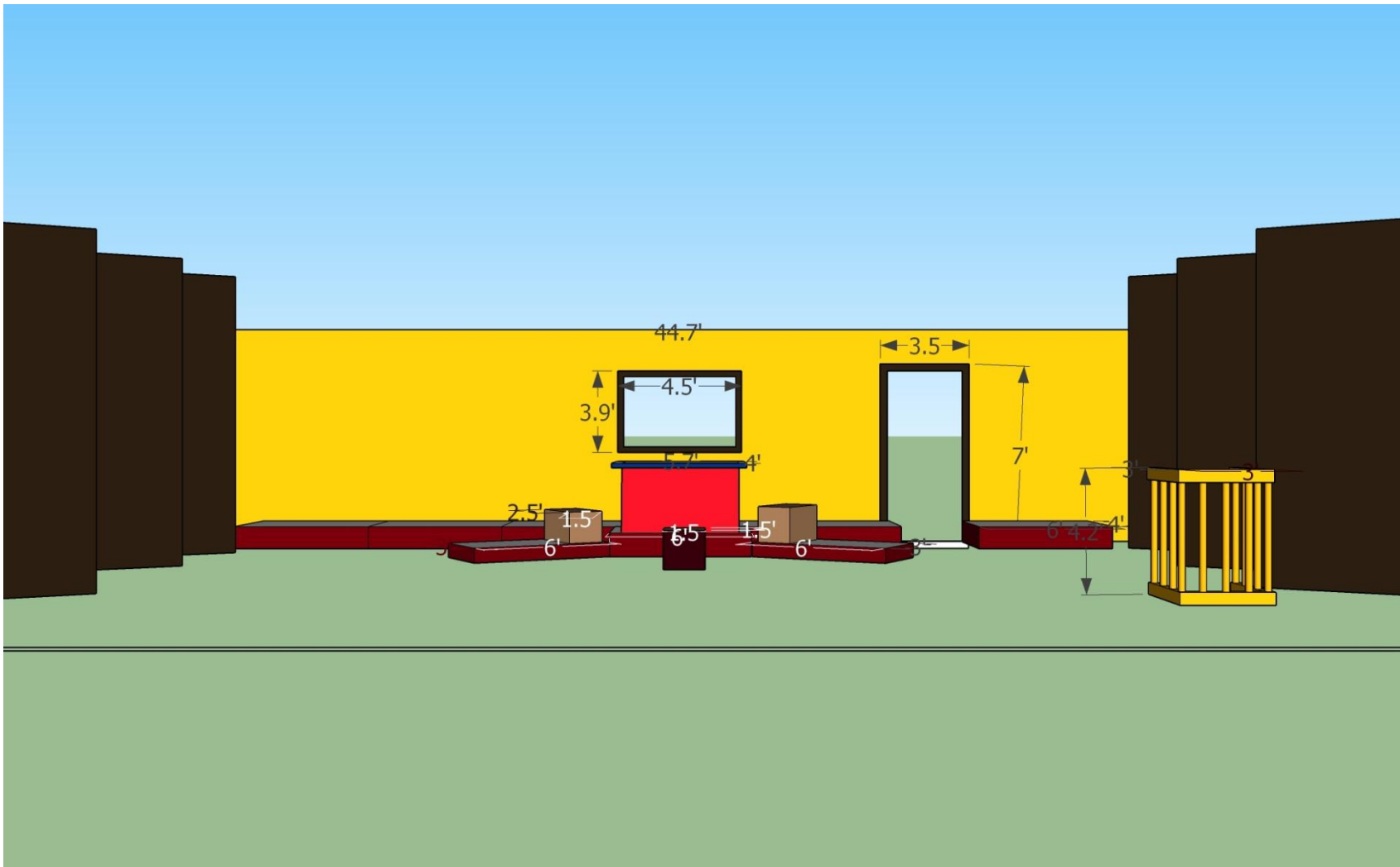

Play – Caligula

Date—7.3.2019

9. Wooden Hollo Frame

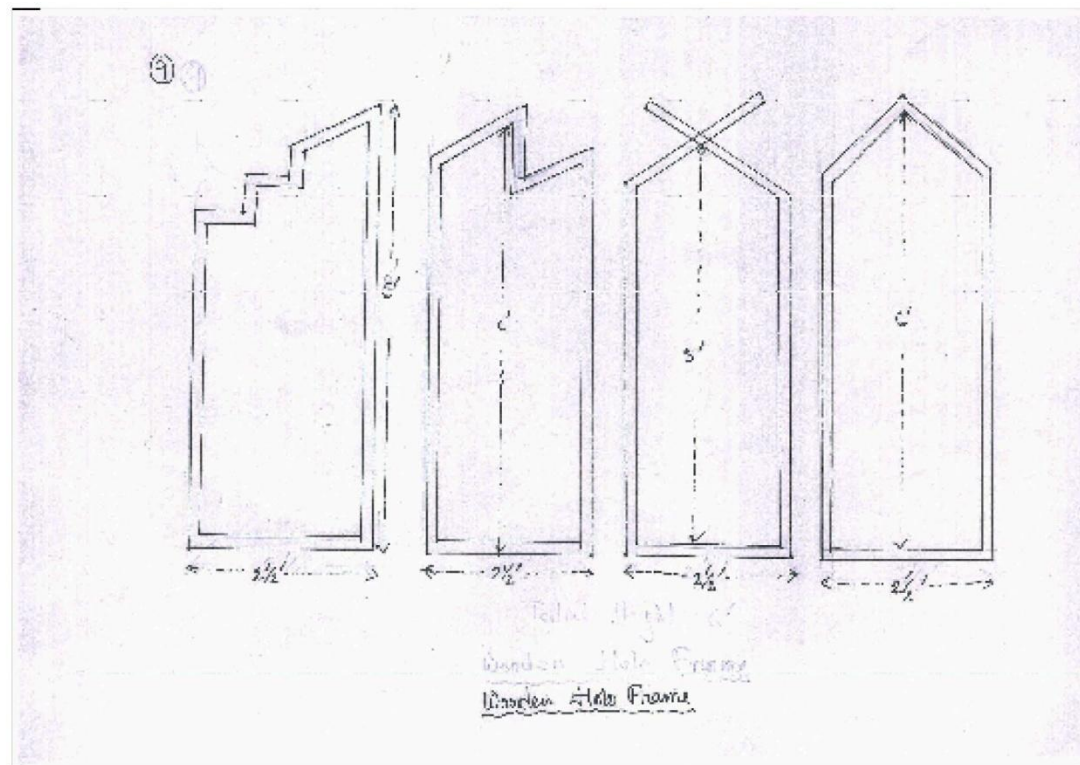

10. Stool

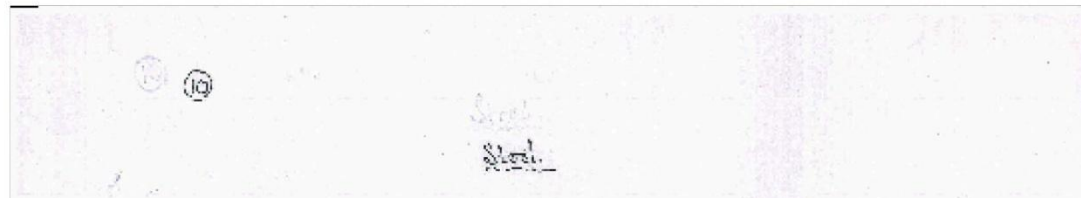

7. Curve Stair (A) - 4sides should be covered with ply, then jute fabric pasting on ply then texture and then colour on texture.

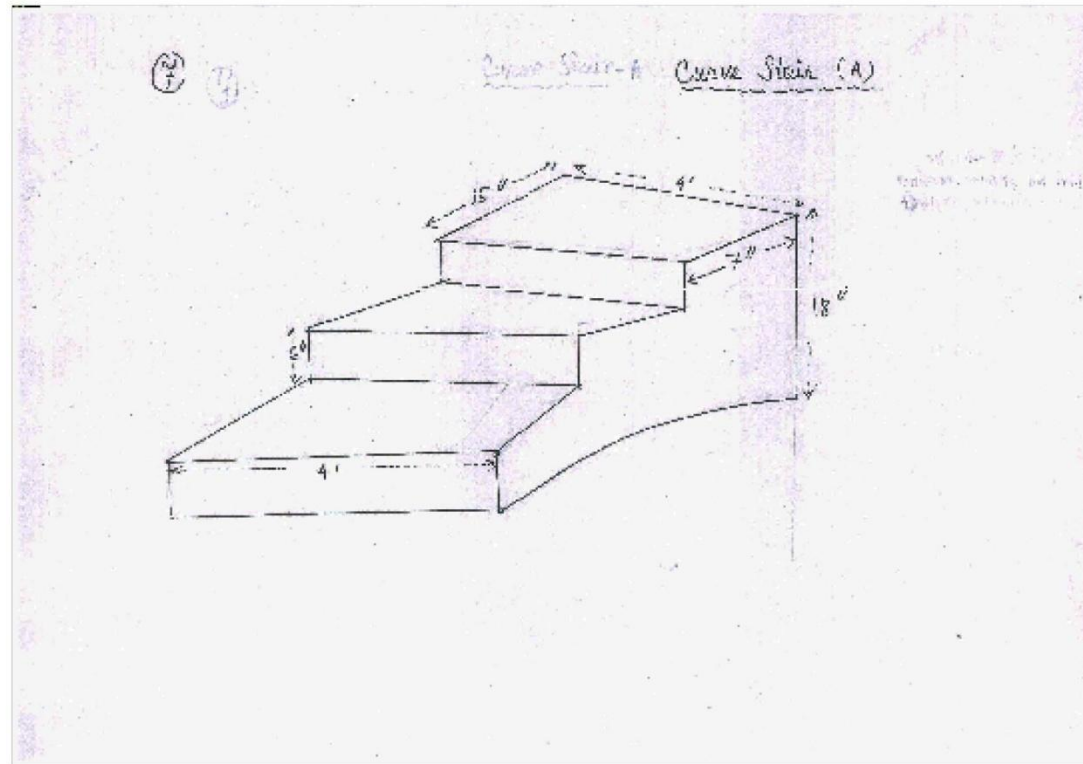

8. Curve stair (B) - 4sides should be covered with ply, then jute fabric pasting on ply then texture and then colour on texture.

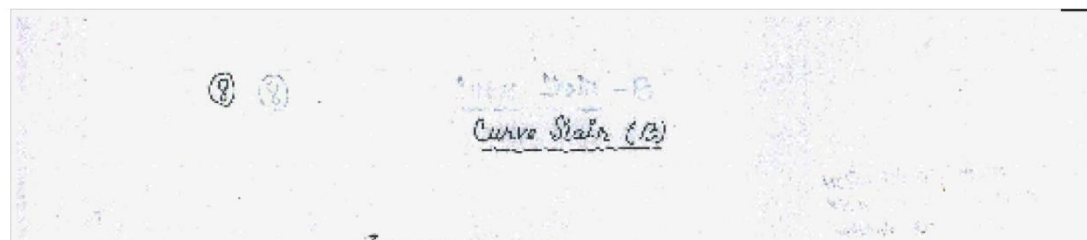

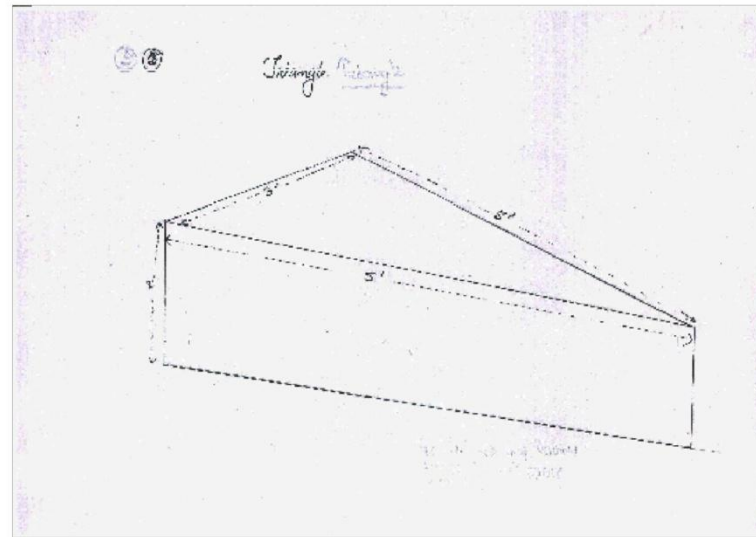

6. Flat Stair - 4 sides should be covered with ply, then jute fabric pasting on ply then texture and then colour on texture.

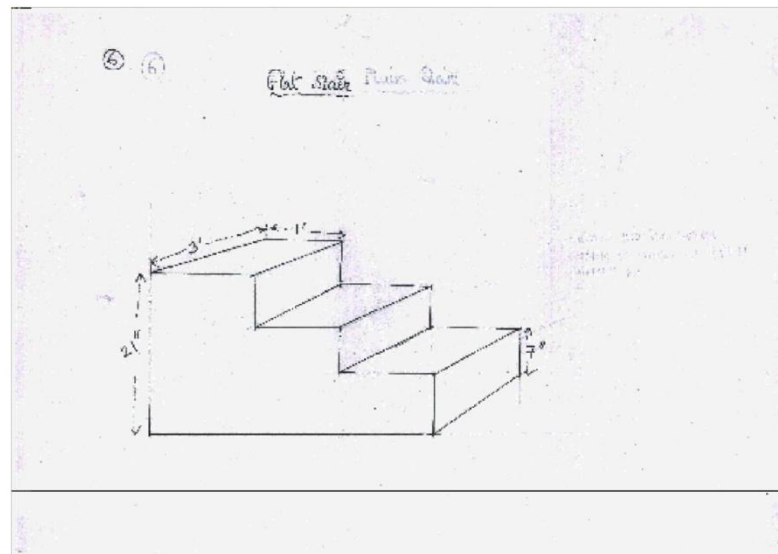

then texture and then colour on texture.

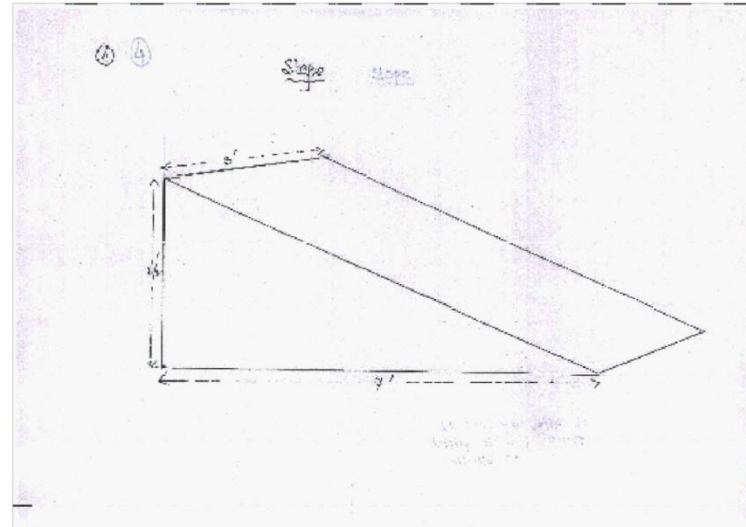

5. Triangle - 4 sides should be covered with ply, then jute fabric pasting on ply then texture and then colour on texture.

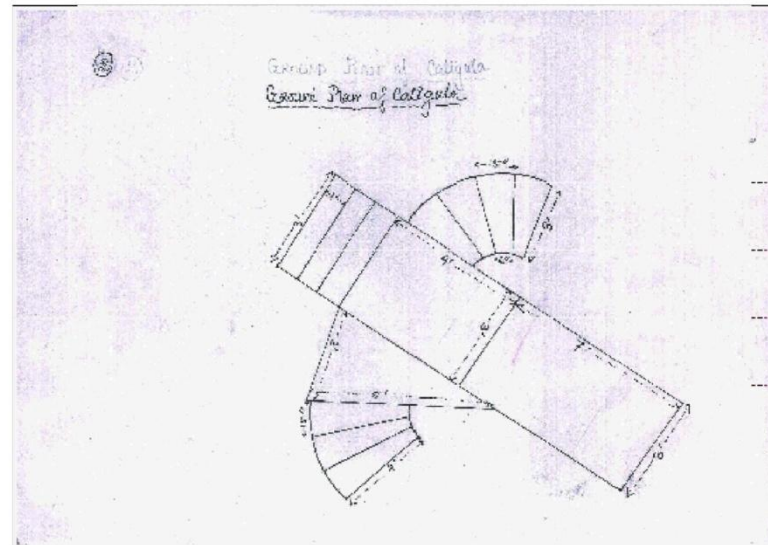

3. Block - 5 sides of the block should be covered with the ply, then jute fabric pasting on ply then texture and then colour on texture.

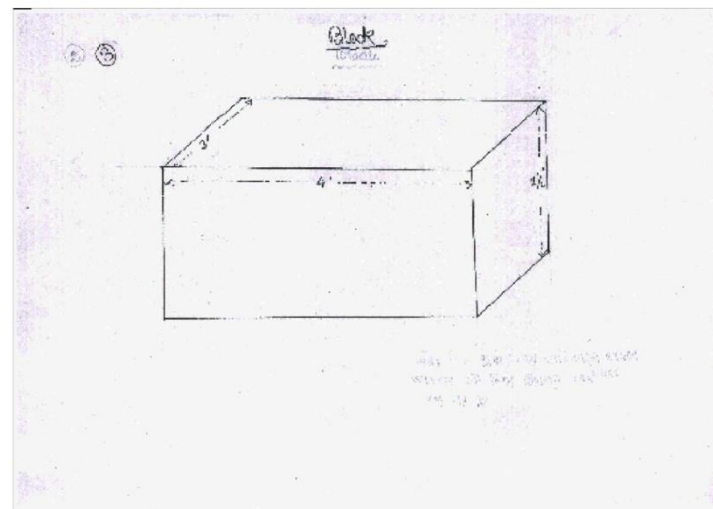

4. Slope - 3 sides and the upper portion will be covered with ply, then jute fabric pasting on ply

1. Total Set Design of Caligula

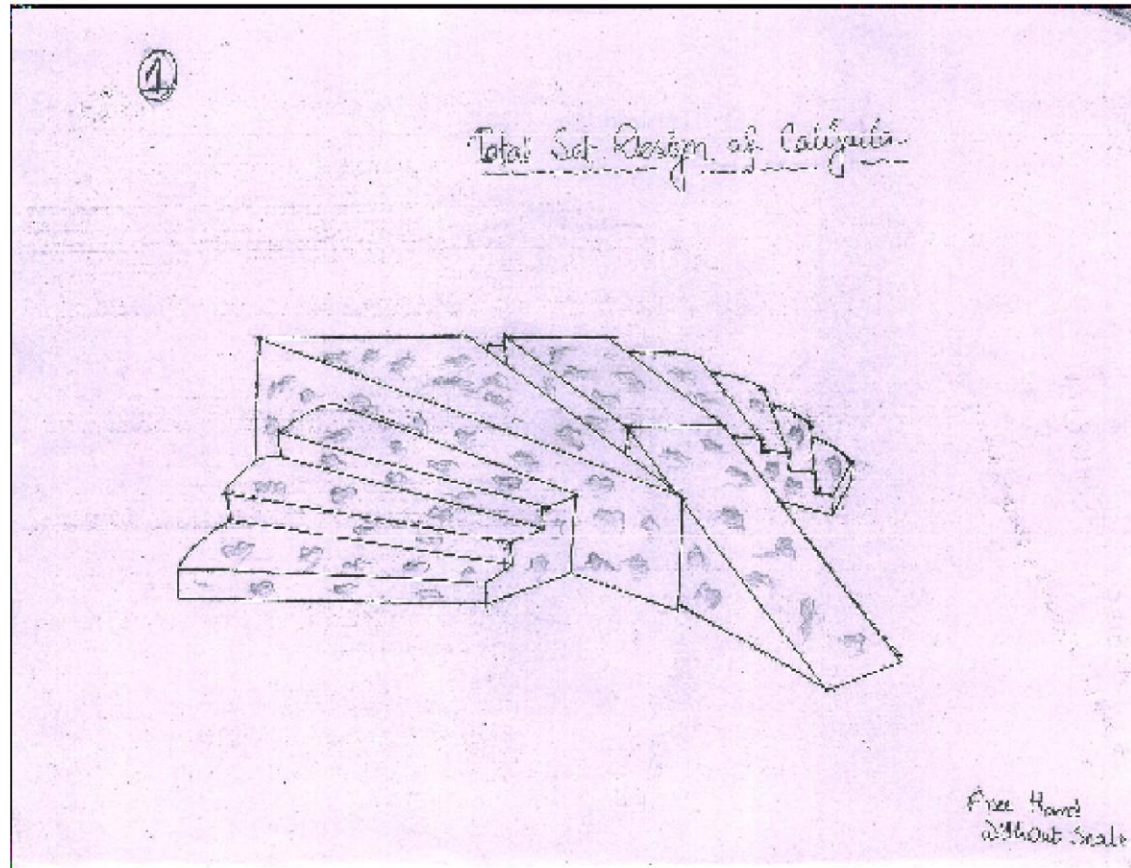

2. Ground Plan

Set Details

Details of Props :

We will bring the entire props except one thing 'Spear'. We will need 12 Spears, so, you have to provide this to us. 6 spears 6 feet height ,2 spears 7 feet height, 2 spears 8 feet height. And it should be look like this:



If you have any further queries about props contact to this No. : +919732550197(Pritam Bhattacharya).

Perishable Item: 1Kg apples

Details of Set Props such as Ground plan Section plan front elevation & Scale drawing of sets which has to made in Delhi :

11. Wooden Ladder

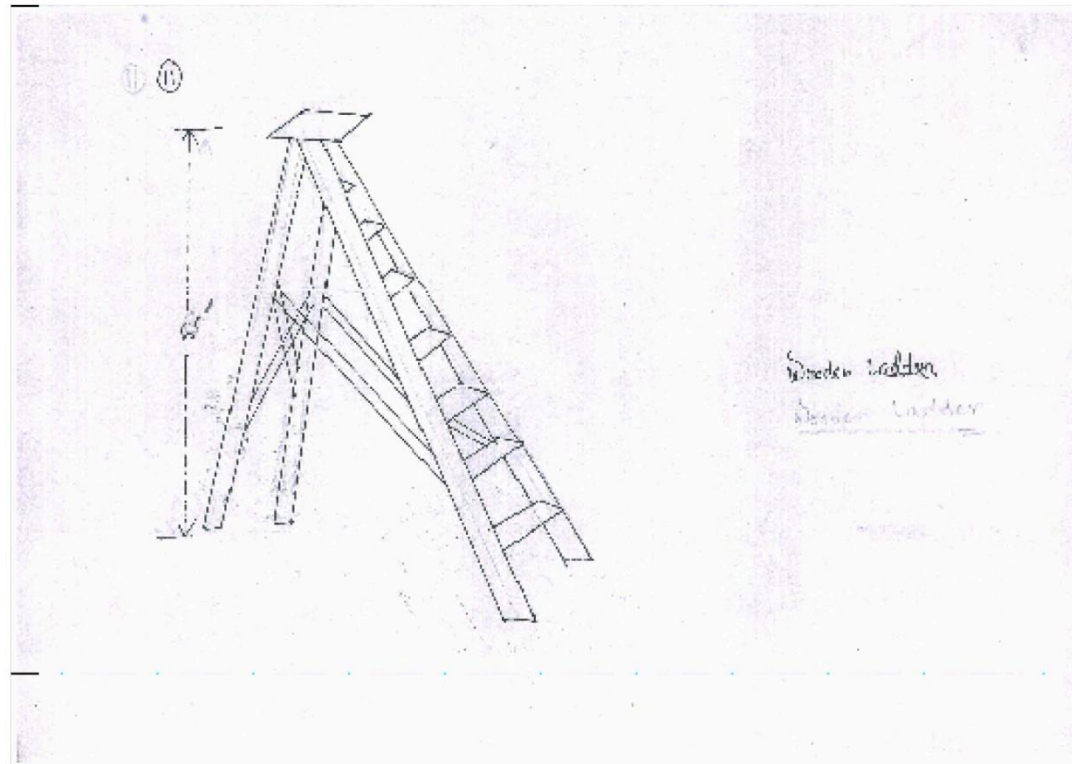

If you have any further queries about Set props contact to this No.: +919233121155 (Koushik Das)

In addition, we also need:

1. 100 foot nylon wire (Red coloured)



Set Details of Caligula-4.jpif

Play – samrat Ashok

Date – 8.3.2019

- 1. Door Frame – 4 nos. (Mechanism to hang Both side Curtain)**
- 2. Some platform**
- 3. Pillars –2 nos.**

RASHTRIYA POORVOTAR NATYA SAMAROH

Set requirement as per Design & Measurement, SHILLONG

Play – Gul – E – Bakawali

Date – 1.3.2019

SET: Wooden Platform 2'X6'X1.5'ht: 1 No.

Wooden Square Stand: 1'X1'X 2.5' ht: 2 Nos.

Play – karnbharam

Date – 2.3.2019

- 1. Black Curtain in back**
- 2. Wooden Platform – 4'x4'x1' painted black**
- 3. Banana Tree – 6' Height – 6 nos.**
- 4. Wing to Wing Platform – width – 1.5' to 2.5' , Height – 1' or 2'**

Play – Mahanirvan

Date –3.3.2019

Platform – 6'x4'x1' – 2 nos. (Mask & Painted Black)

Platform – 6'x3'x1' – 7 nos. (Mask & Painted Black)

Play – Loha Kutt

Date – 4.3.2019

Black - F (for kitchen)
Quantity - 01 No

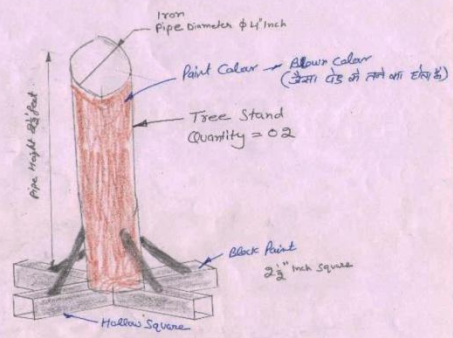
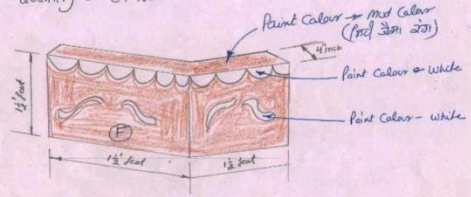

Charpai = 01

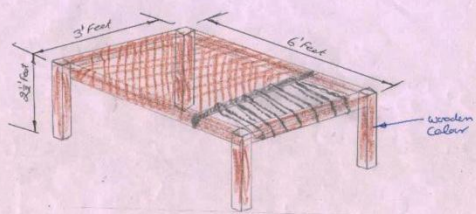

Block - E (for making Bhatti)

Quantity → 01 No

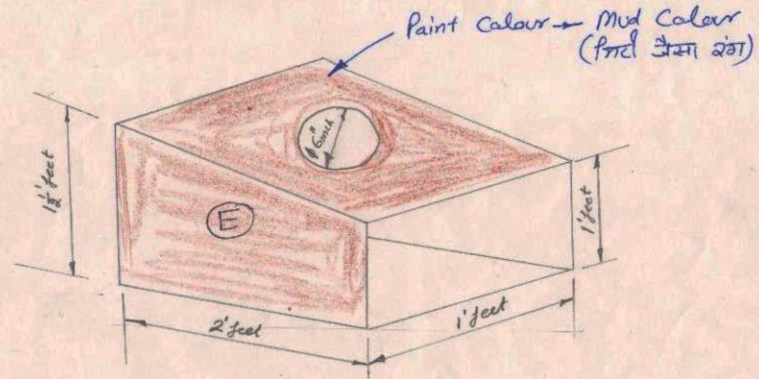

Block G for Making (4' x 4' x 1/2' feet)

Quantity → 08 No

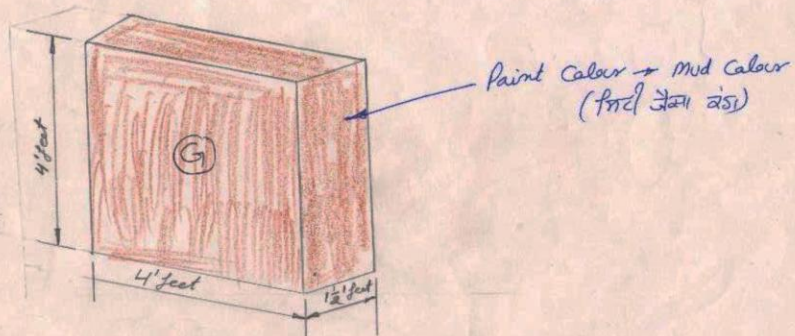

कुम्भ (2 x 1 1/2 feet) ①
दोस्त मरी 1 x 1 1/2 feet ②
1 1/2 x 1 1/2 feet ③
1 1/2 x 1 1/2 feet ④
1 1/2 x 1 1/2 feet ⑤
1 1/2 x 1 1/2 feet ⑥
1 1/2 x 1 1/2 feet ⑦
1 1/2 x 1 1/2 feet ⑧

Block - C (for wall)
Quantity = 02 No

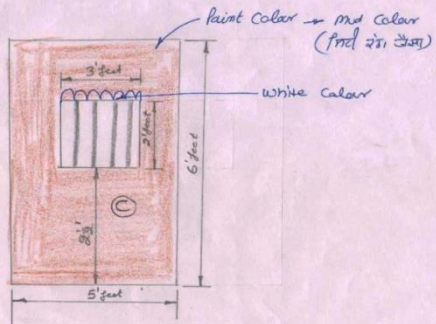

Block - D (for wall)
Quantity - 3

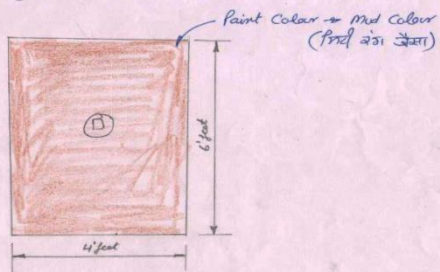

Block - A (for wall)
Quantity = 01 No

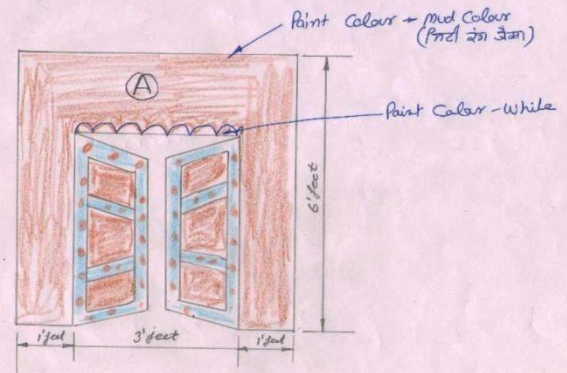

Block - B (for wall)
Quantity - 01 No

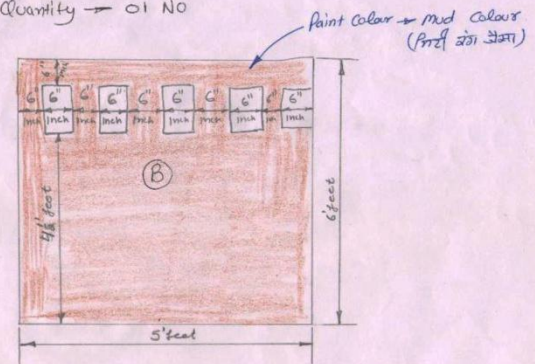

Technical detail of Play “LOHA KUTT”

1 Drawing of required wooden Blocks for making set are attached with mail including quantity, size, and required color also kindly check it

2 Lighting requirements : (a) 20 No CP64 par light with 1000 watt lamp

(b) 16 No L.D lights

(c) 12 No Profile with Irish cutter

3. Sound requirements : Normal Sound as Music operated by laptop

4 Properties Requirements

A) Iron Bucket (□□□□ □□ □□□□□□) 01 No

B) Old Agriculture equipment Such as (Kassi □□□□□ , kulhari □□□□□□□□□, drati □□□□□, cheni □□□□ ,reeti □□□□ , old talwar,□□□□□□ □□□□□)

C) Dummy sledge Hammer Made from iron hollow pipe

D) old iron chain 2 feet length (□□□□□□ □□□□ □□ □□□□□)

E) constructional Bricks 20 No

F) Tokra □□□□□ 02 No

G) brass utensils commonly used in kitchen

5. Photograph of set of play are also attached

PLAY LOHA KUTT YOU TUBE LINK FOR SET REFERENCE

<https://www.youtube.com/watch?v=z8rw-2jdUM4>



Play – Hum Mukhtara

Date – 5.3.2019

① One opposite two

1)

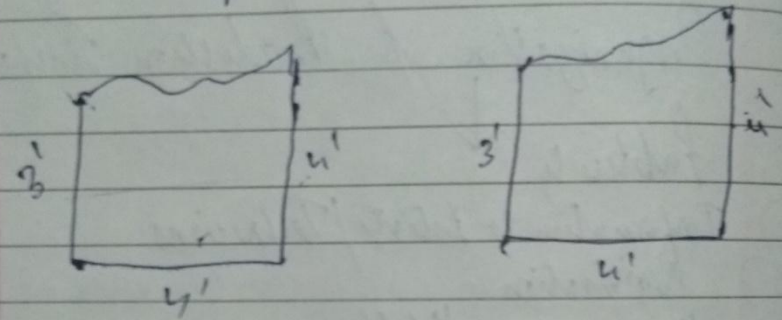

②

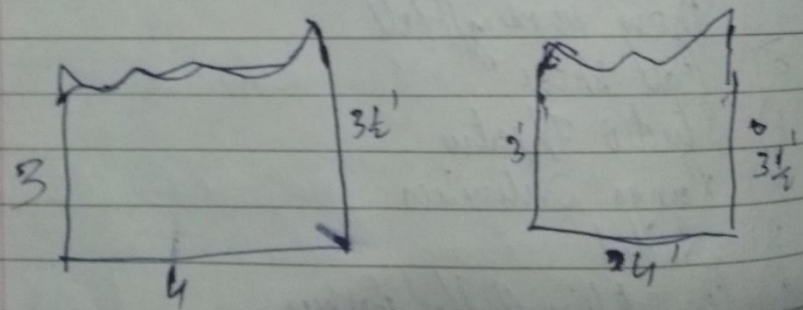



















'HUM MUKHTARA'

- 1) Lantern -- 20
- 2) School Board -- 15
- 3) Torch -- 30
- 4) Gita (Quran) -- 01
- 5) Signature Paper -- 04
- 6) Ink pad -- 01
- 7) Cheque -- 01
- 8) Jay Namaz -- 01
- 9) Kite -- 04
- 10) Doll -- 02
- 11) Red Curtain -- 02
- 12) Salma Choti -- 01
- 13) Court Board -- 04
- 14) Gun -- 05
- 15) Choti -- 14
- 16) Dhol -- 02
- 17) Costume Box -- 01
- 18) Prop Box -- 02
- 19) Doll's Dopatta, Kurta, Salwar - 01 each
- 20) Kaji's Mora -- 01
- 21) Yellow Big Torches - 02
- 22) Charging Wire -- 02
- 23) Kerosene Oil -- 2 Ltrs
- 24) Funnel -- 01
- 25) Hurricane's Fita -- 4 Bundles

Play – Ashad ka Ek Din

Date – 6.3.2019

Sets & Furnitures

Sl. No.	Particulars	Quantity
1.	Platforms (6' × 4')	4 Pieces
2.	Platforms (Triangular) - See Drawing	5 Pieces
3.	Stair Case - See Drawing	2 Pieces
4.	Bamboo Poles - See Drawing	4 Pieces
5.	Plug in Shelf for Utensils- To be pushed & adjusted inside the Platform- See Drawing	1 Piece
6.	Woven-Chulha - Length-3' × Depth-1'6" × Height-1'6"	1 Piece
7.	Stool with Legs (Chauki) - Length-1' 6", Depth-1' 6", Height-15"	1 Piece
8.	Cubic Stool - Length-1' 6", Depth-1' 6", Height-1'- Polished	1 Piece
9.	Cubic Stool Different Style - Length-1', Depth-1', Height1' - Polished	1 Piece
10.	Bed-Cot - Platform- Length-5', Depth-2'6", Height-1'6"	1 Piece
11.	Table - Length-2', Depth-2', Height-2',	1 Piece
12.	Deepmalika (Off White)- See Drawing	1 Piece
13.	Long Block for Seating - Length-3', Depth-1', Height-9" - Polishsed	2 Pieces
14.	Clay made Urns (Tall <i>Haandi</i> or <i>Jaala</i> in Traditional name) - See Picture of the SET.	2 Pieces





CUBIC STOOL- Length-1', Depth-1', Height1'

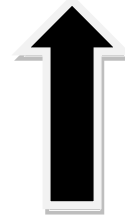



LONG BLOCK for Seating - Length-3', Depth-1', Height-9 inches





STOOL - Length-1' 6 inches, Depth-1' 6 inches, Height-15 inches





STOOL - Length-1' 6 inches, Depth-1' 6 inches, Height-1'





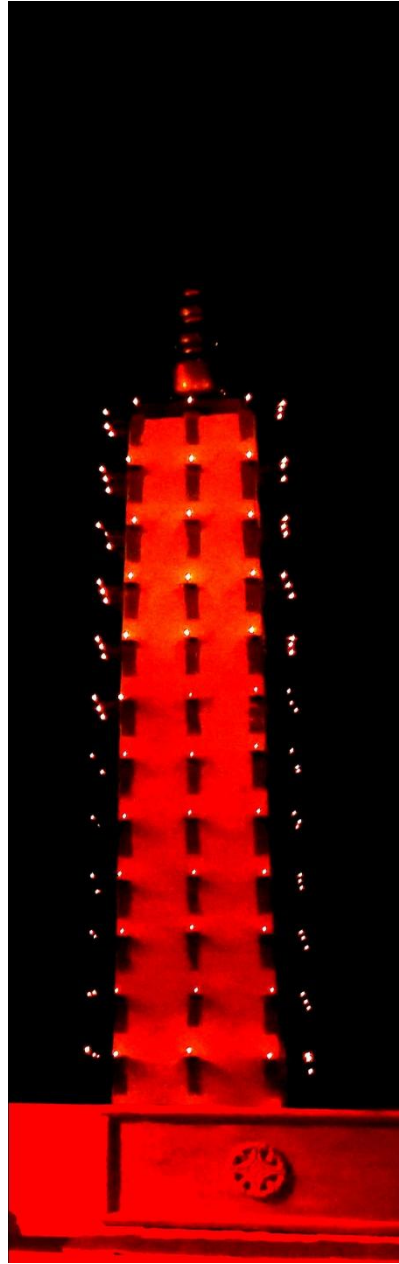





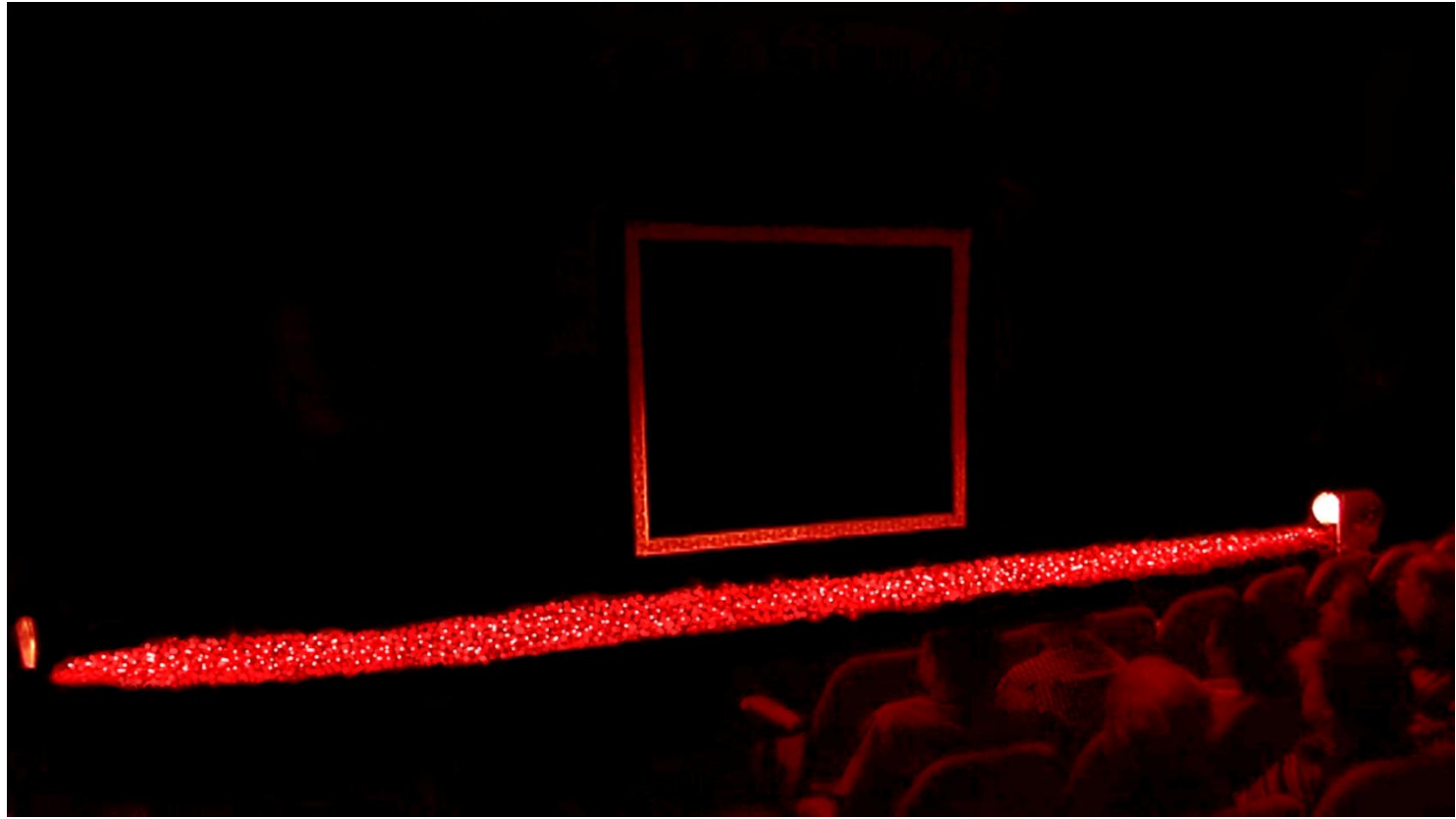

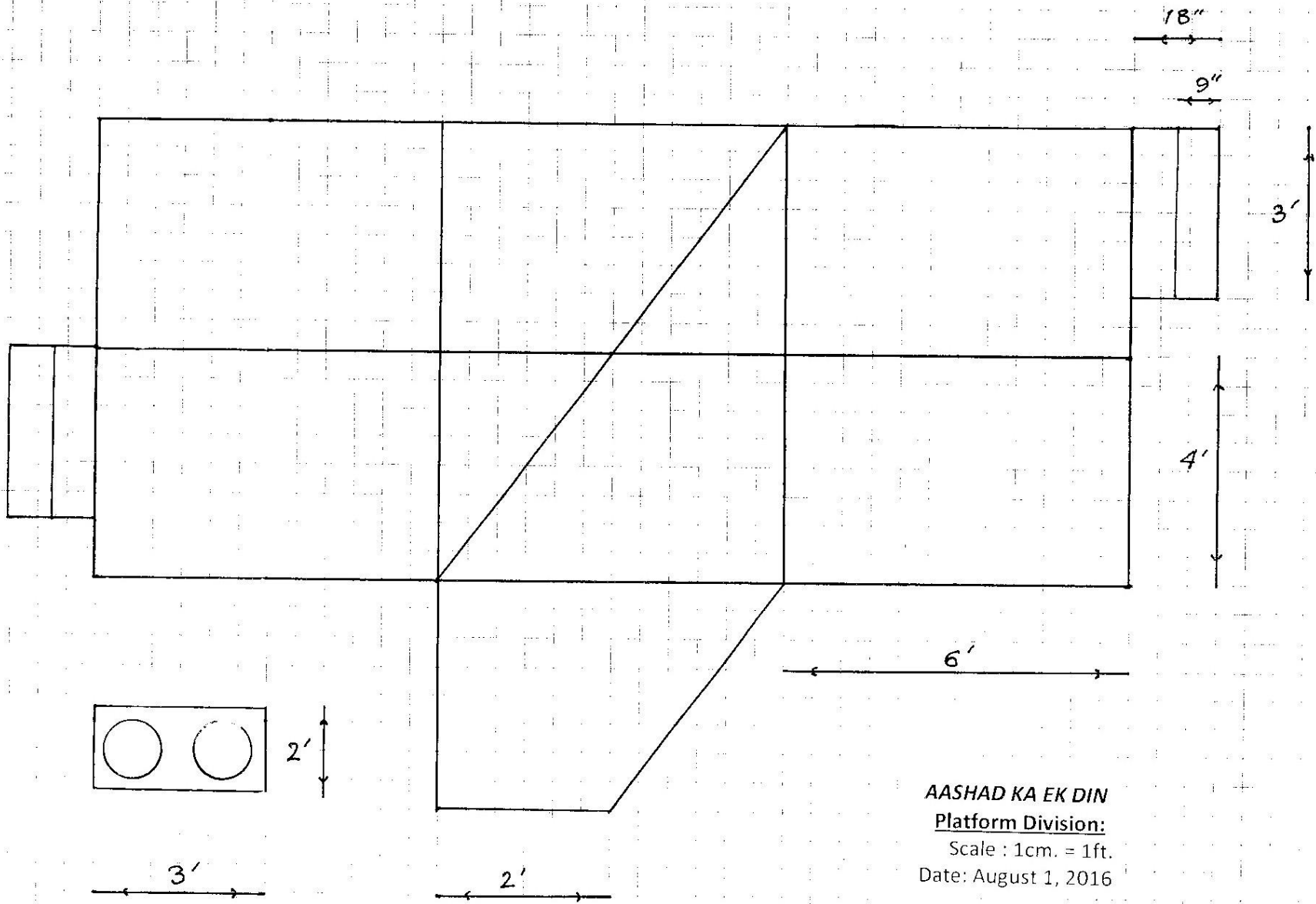

AASHAD KA EK DIN
Platform Division:
 Scale : 1cm. = 1ft.
 Date: August 1, 2016

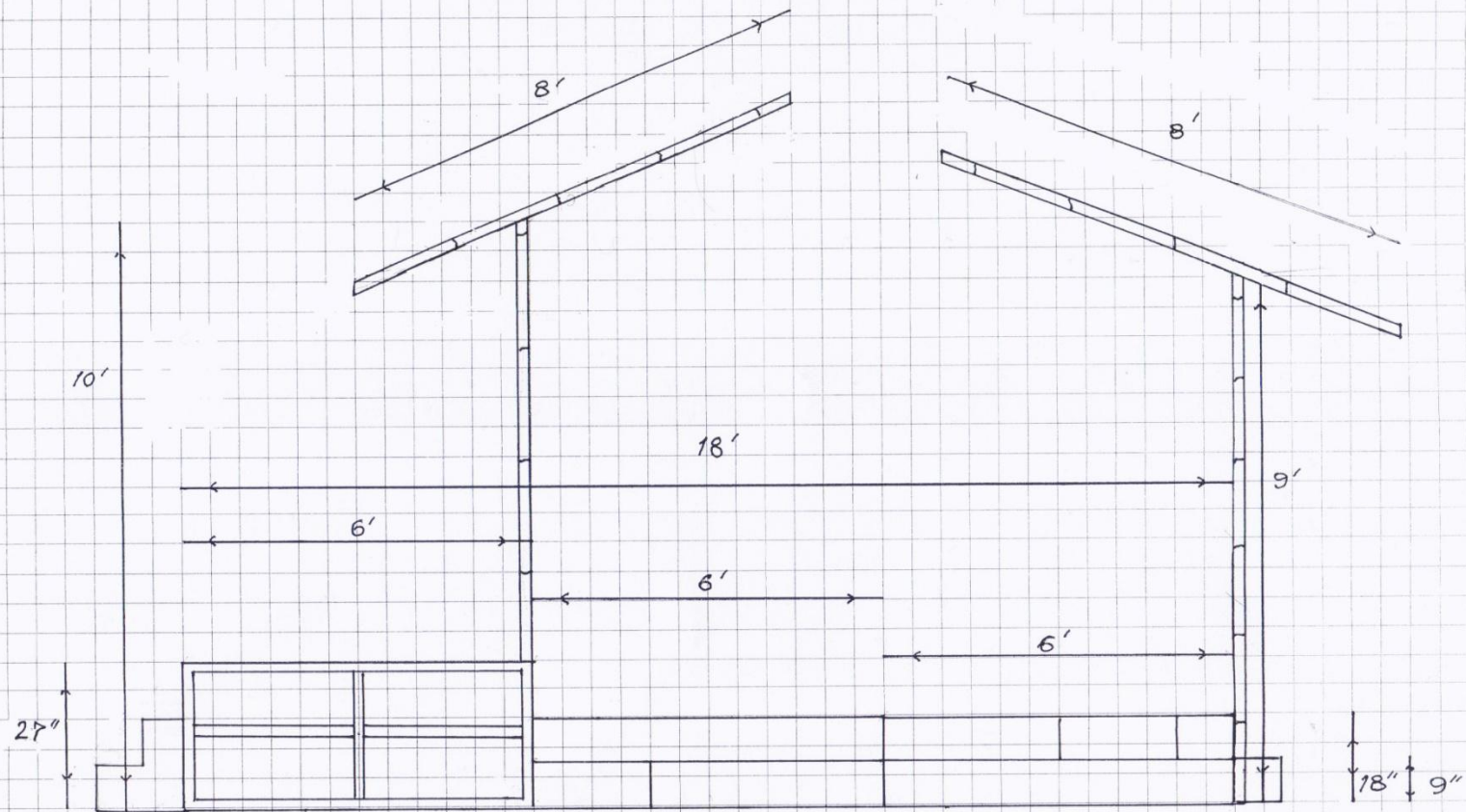

AASHAD KA EK DIN

Front Elevation:

Scale : 1cm. = 1ft.

Date: August 1, 2016

Approx. Adjusted.

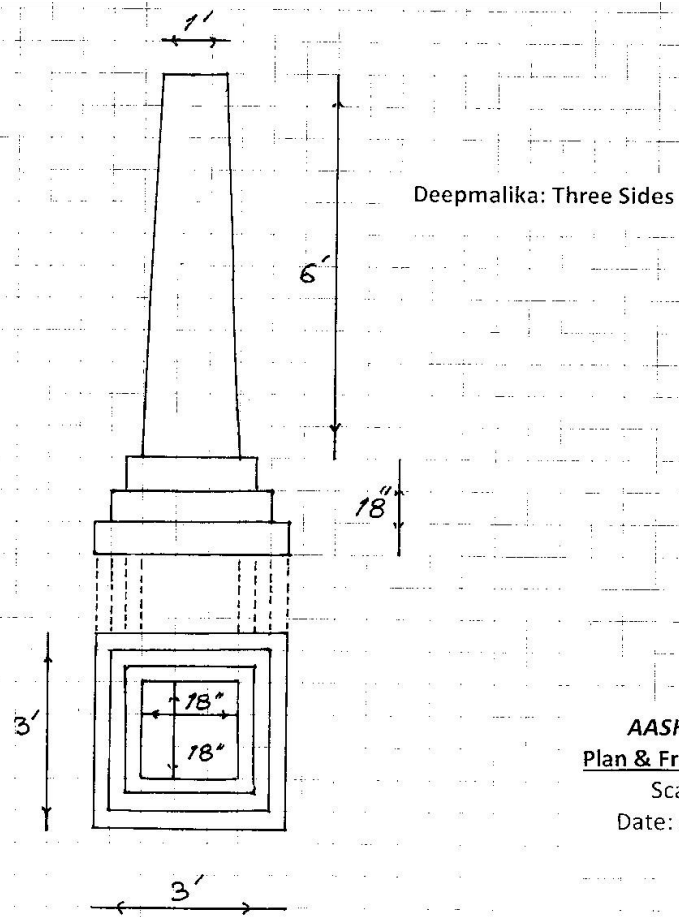

AASHAD KA EK DIN
Plan & Front Elevation:
 Scale : 1cm. = 1ft.
 Date: August 1, 2016

Furniture to be made:

- 1) Stool: Length-1'6", Depth-1'6", Height-15"
- 2) Stool: Length-1'6", Depth-1'6", Height-1'
- 3) Stool: Length-1', Depth-1', Height-1'
- 4) Table: Length-2', Depth-2', Height-20"
- 5) Cot: Length-5', Depth-2'6", Height-1'6"
- 6) Long Block for Seating: Length-3', Depth-1', Height: 9" - 2 Nos. (All the Furnitures are to be polished or Varnished. Floral motif will be brought by Circle Theatre, New Delhi.)

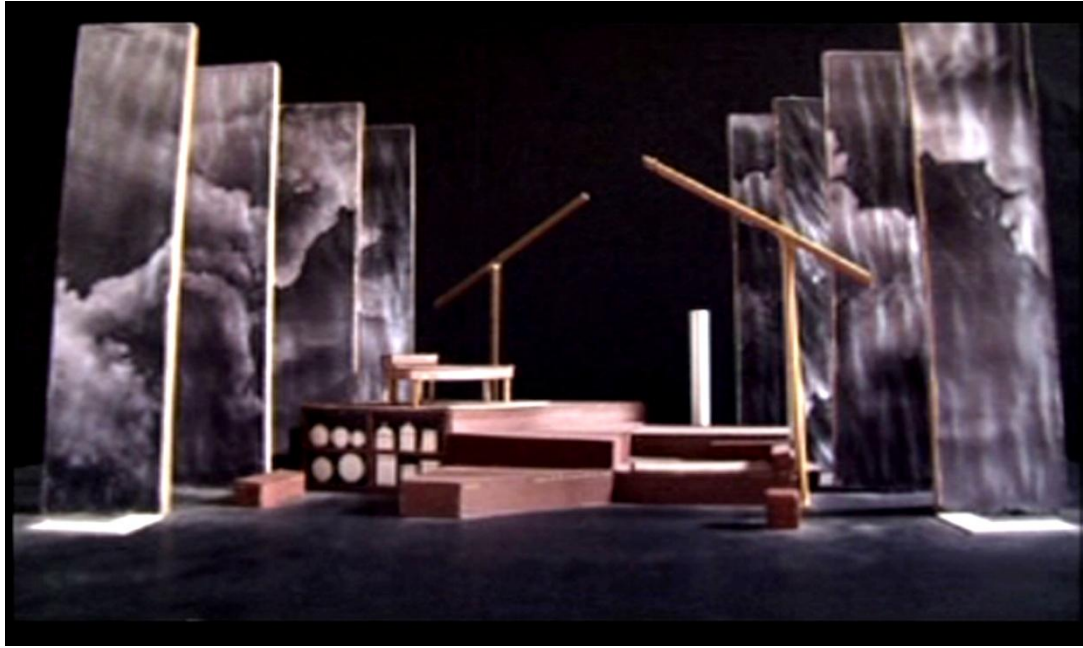





Play – Doodhan

Date –7.3.2019

Platform – 6'x'6'x9" –1 nos.

Platform – 4'x4'x9" – 1 nos.

Frame – 6'x5' – 2 nos. (With stand)

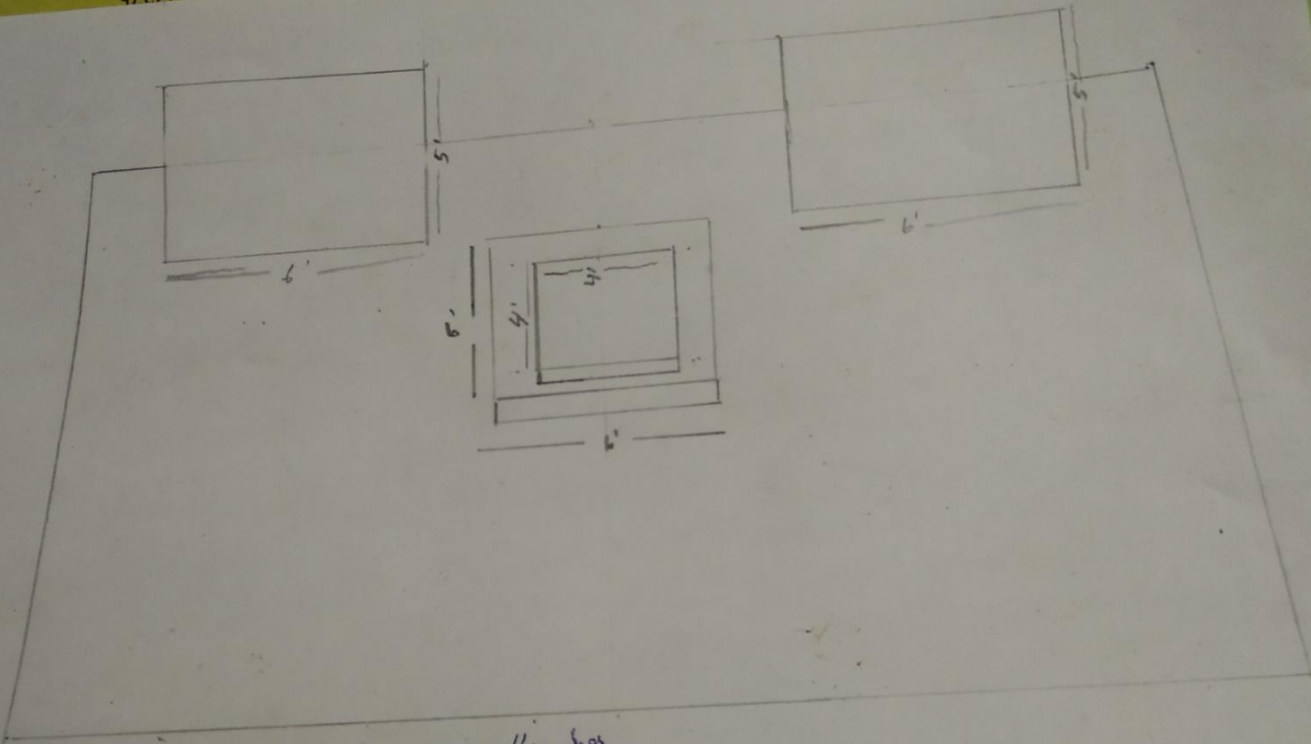

Two Platforms.
 ① 4x4 ft Height 75" (2) 6x6 ft Height 75" inches
 Two Blank frames. 6x5' ft (standable)

Play-- Court Martial

Date – 8.3.2019

1. Platform – 6'x4'x18" – 8 nos.
2. Wooden chair – 9 nos.
3. Revolving Chair – 1 nos.
4. Centre table – 3'x2'x2' – 1 nos.
5. Stool – 18" height.
6. Witness Box – 3.5'x3.5'x3' – 1 nos.
7. Platform – 6'x3' – 2 nos.
8. Glass – 12 nos.

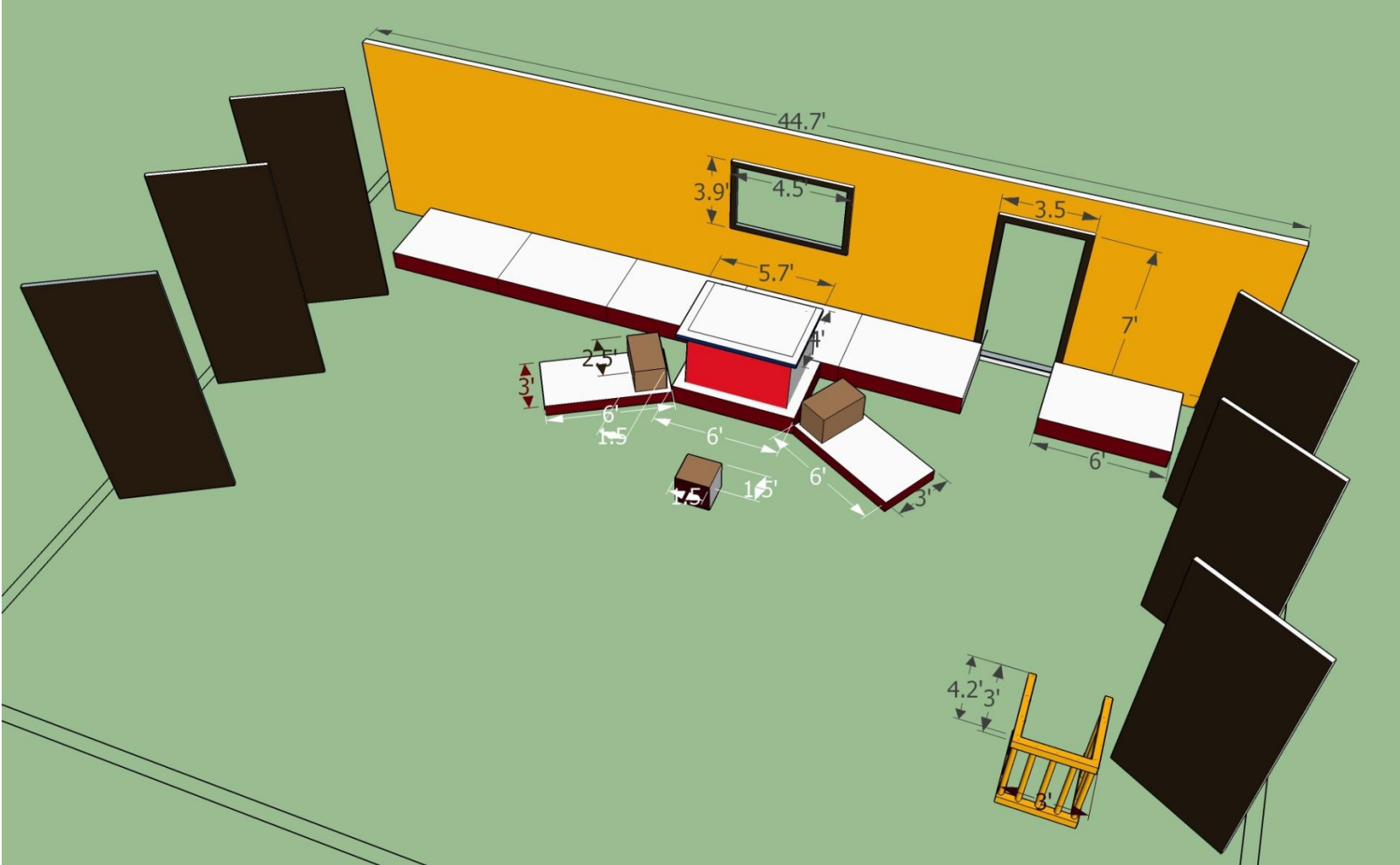

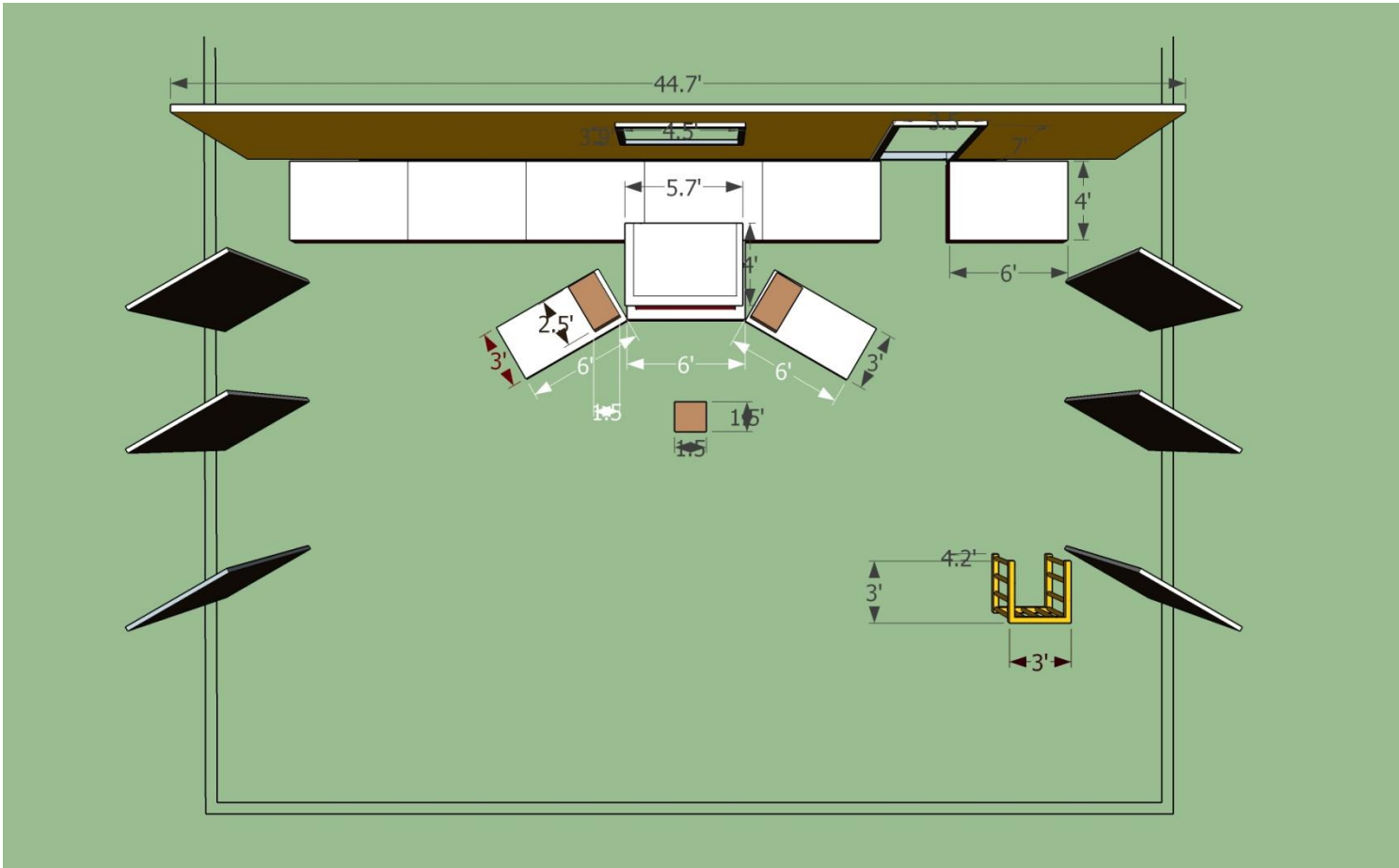

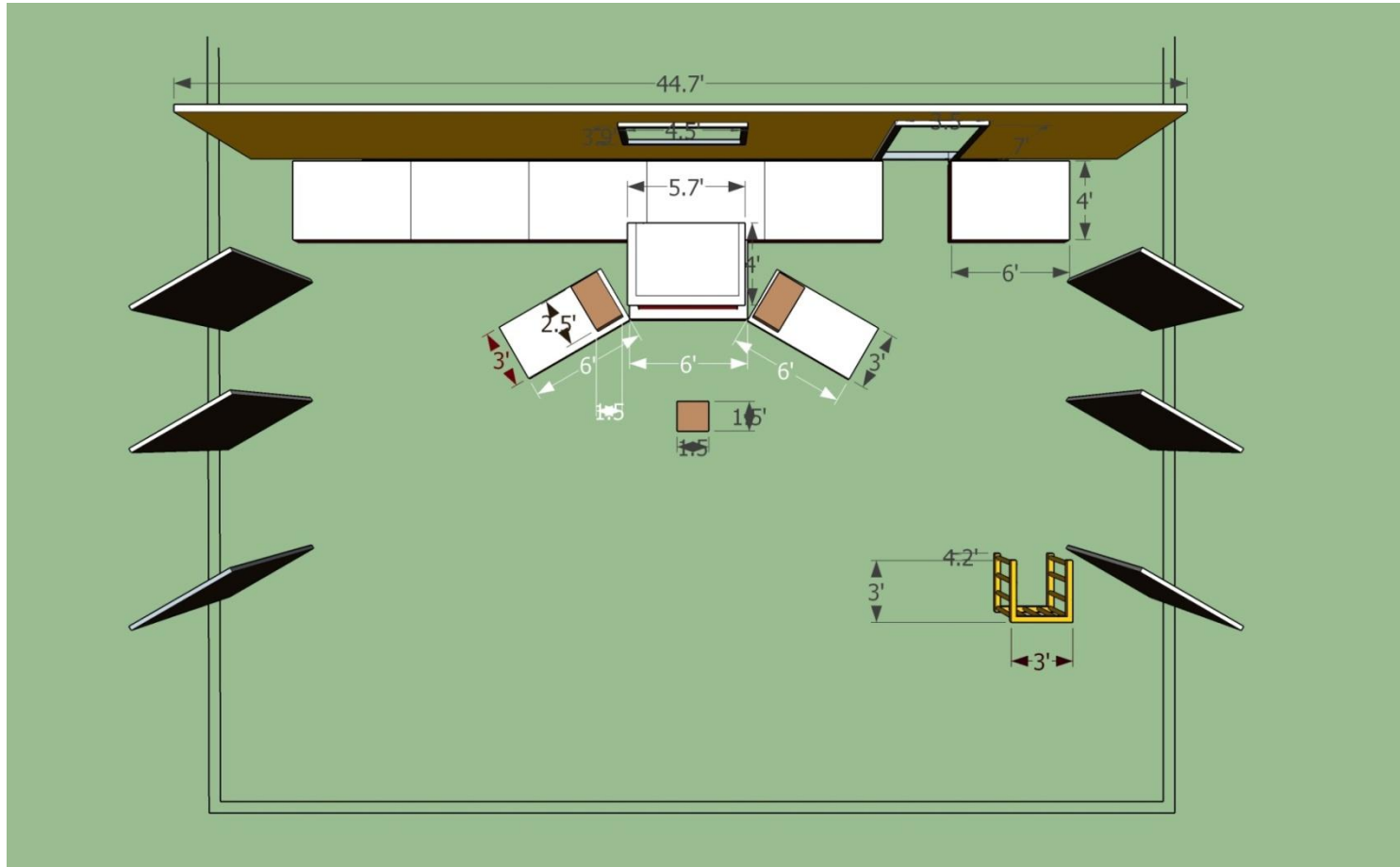



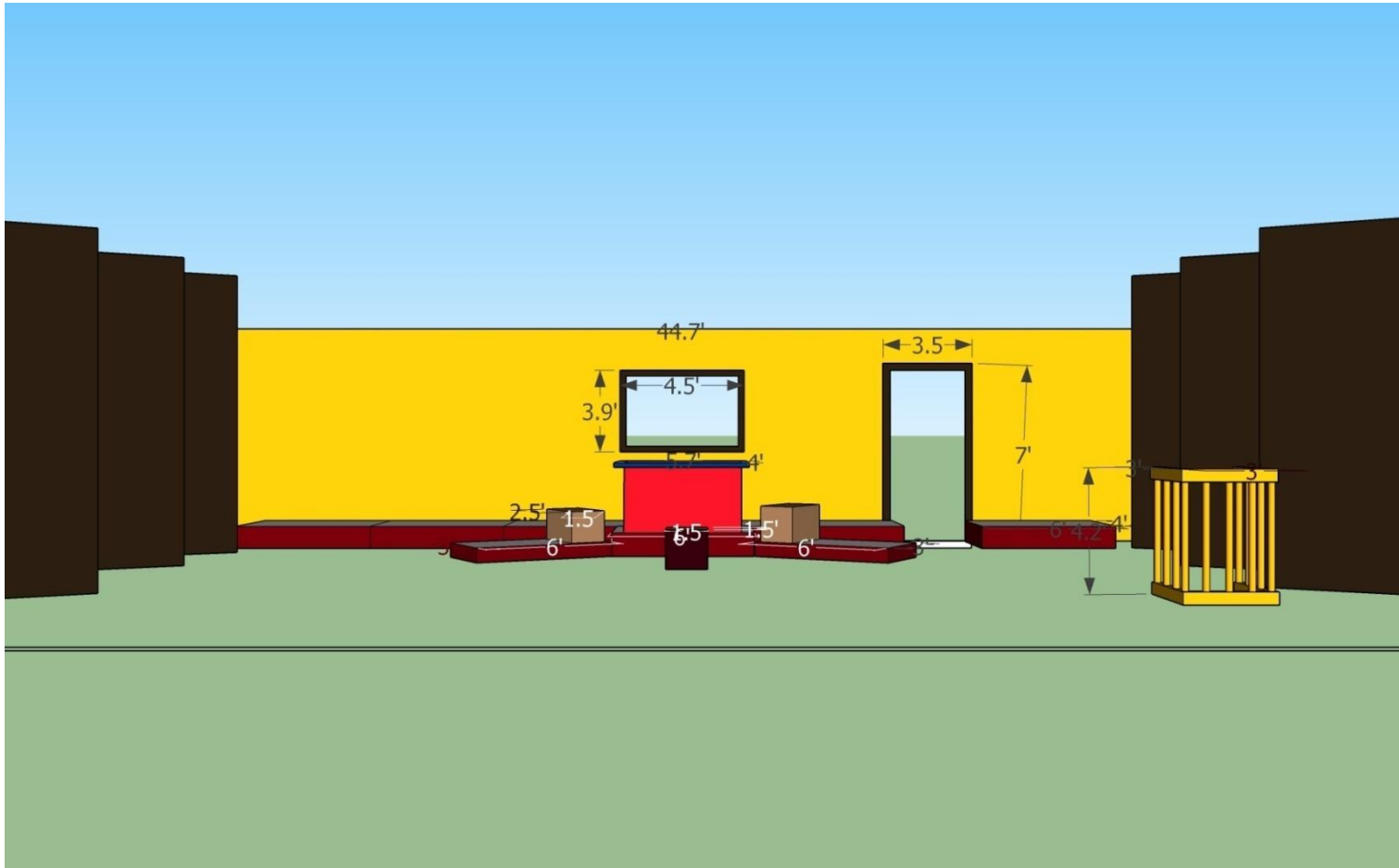

Play – Caligula

Date—9.3.2019

1. Total Set Design of Caligula

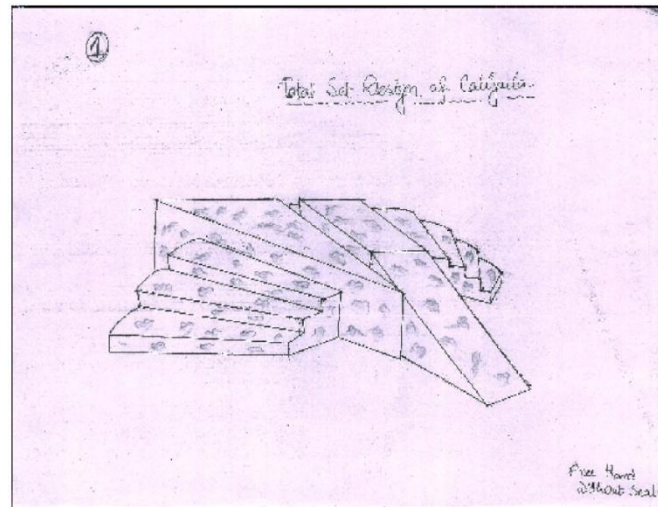

2. Ground Plan

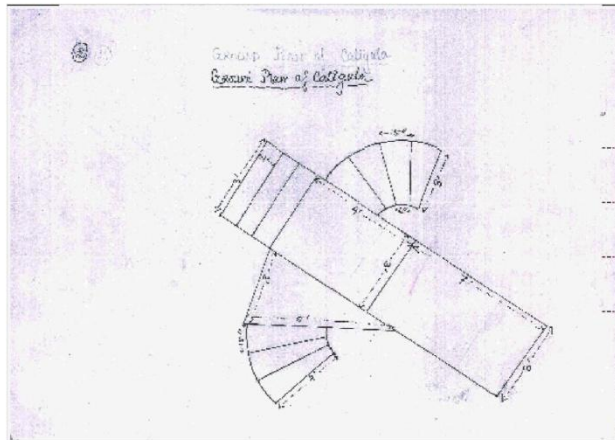

3. Block - 5sides of the block should the covered with the ply,then jute fabric pasting on ply then texture and then colour on texture.

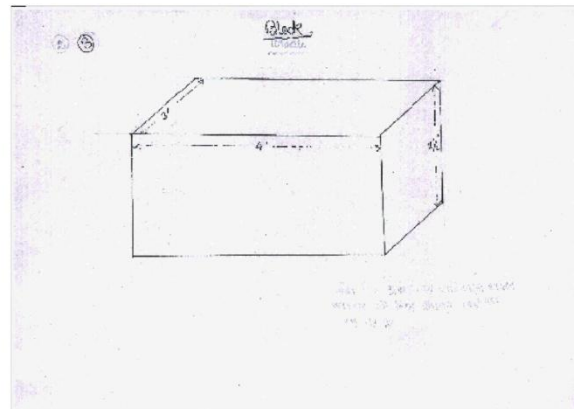

4. Slope - 3sides and the upper portion will be cover with ply,then jute fabric pasting on ply

9. Wooden Hullo Frame

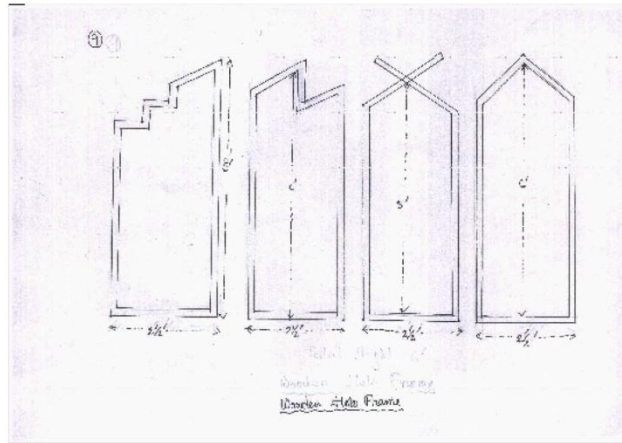

10. Stool

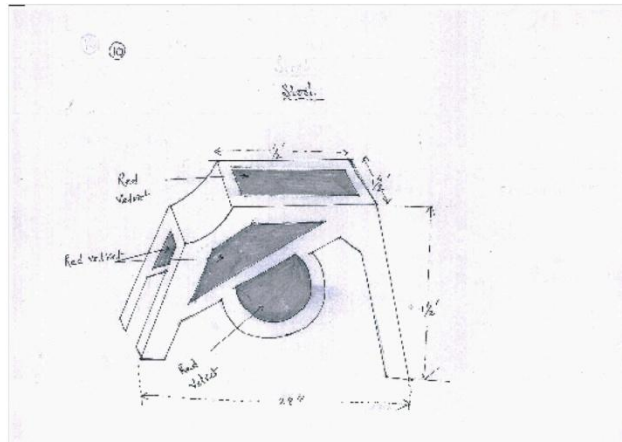

7. Curve Stair (A) - 4 sides should be covered with ply, then jute fabric pasting on ply then texture and then colour on texture.

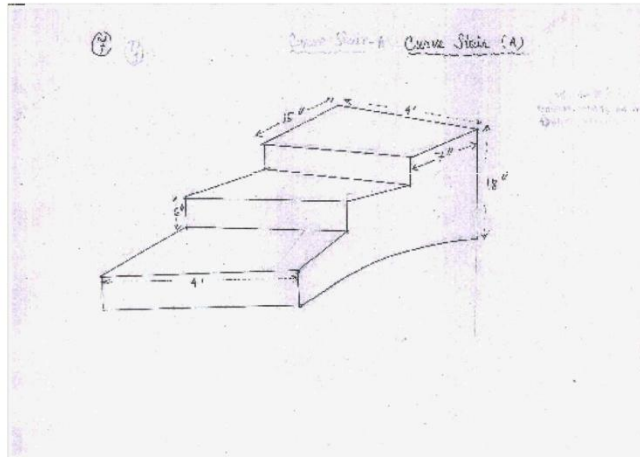

8. Curve stair (B) - 4 sides should be covered with ply, then jute fabric pasting on ply then texture and then colour on texture.

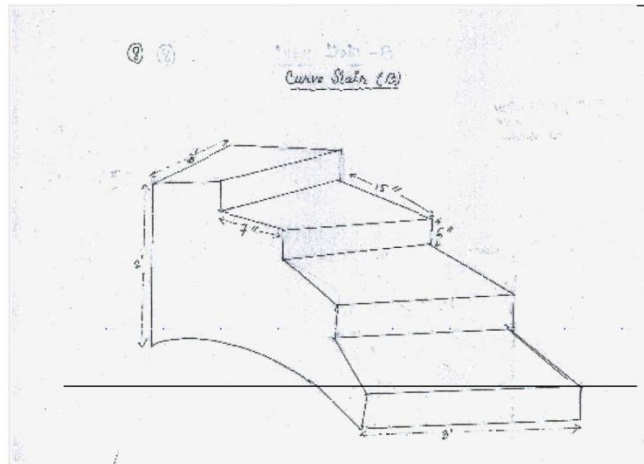

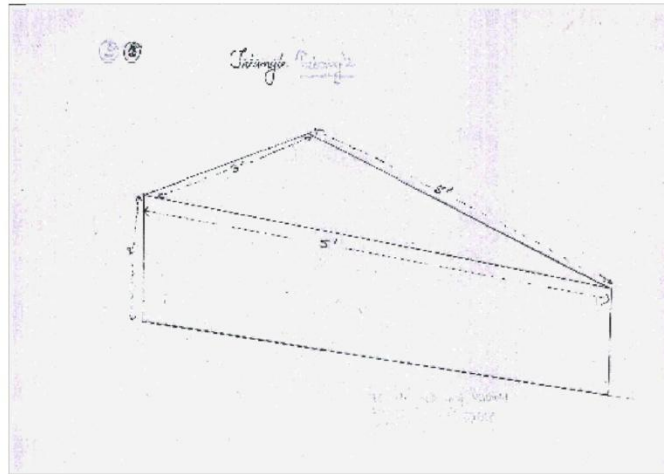

6. Flat Stair - 4sides should be covered with ply, then jute fabric pasting on ply then texture and then colour on texture.

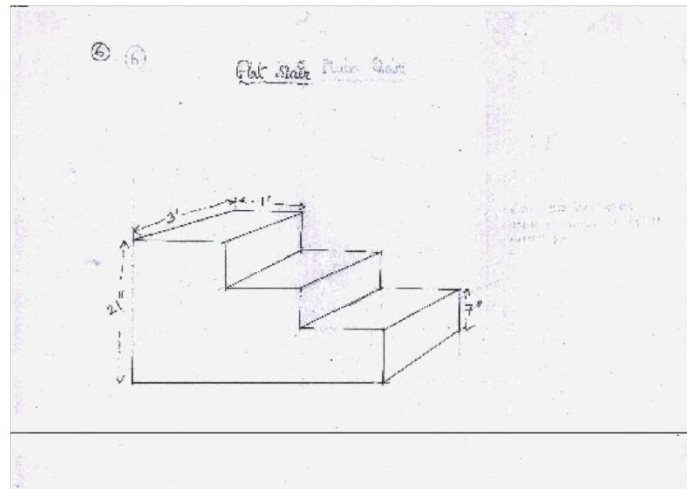

then texture and then colour on texture.

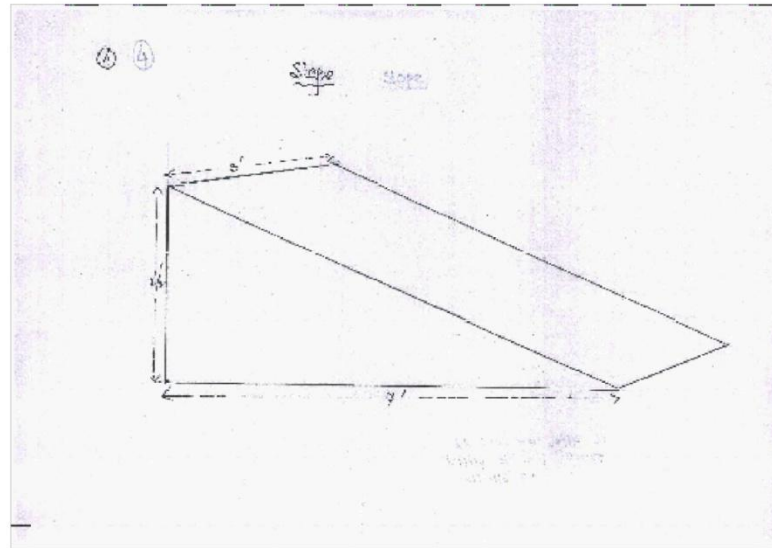

5. Triangle - 4sides should be covered with ply,then jute fabric pasting on ply then texture and then colour on texture.

Set Details

Details of Props :

We will bring the entire props except one thing 'Spear'. We will need 12 Spears, so, you have to provide this to us. 6 spears 6 feet height ,2 spears 7 feet height, 2 spears 8 feet height. And it should be look like this:



If you have any further queries about props contact to this No. : +919732550197(Pritam Bhattacharya).

Perishable Item: 1Kg apples

Details of Set Props such as Ground plan Section plan front elevation & Scale drawing of sets which has to made in Delhi :

11. Wooden Ladder

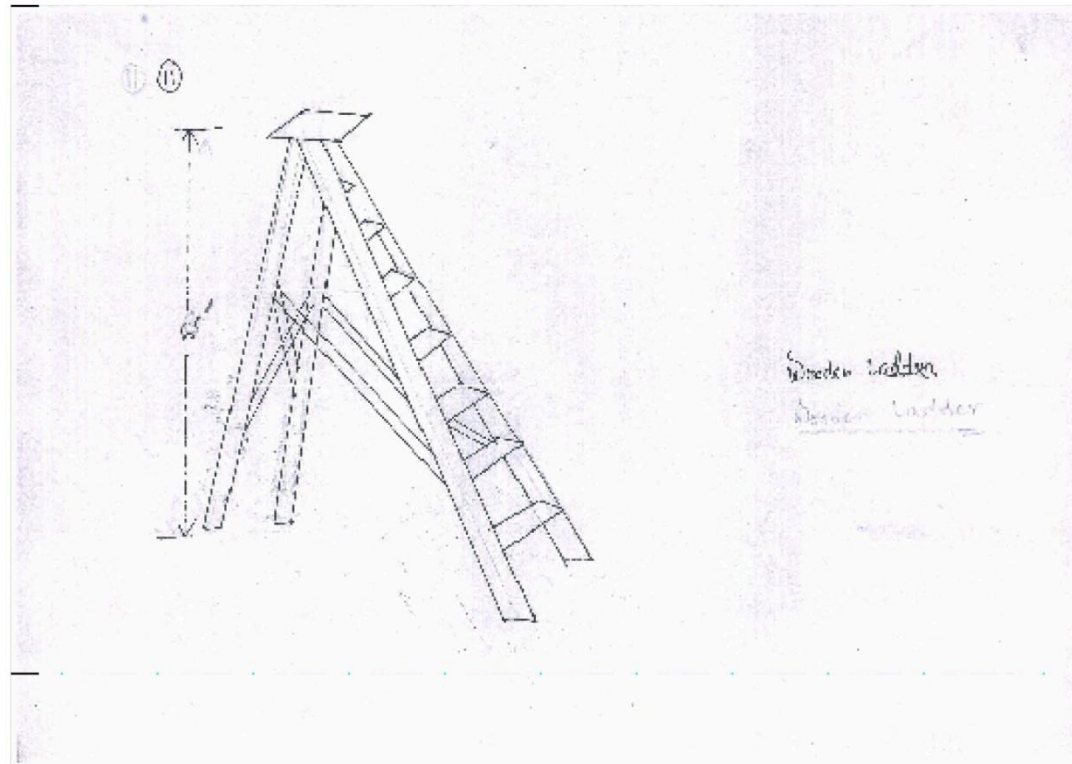

If you have any further queries about Set props contact to this No.: +919233121155 (Koushik Das)

In addition, we also need:

1. 100 foot nylon wire (Red coloured)

Play – Samrat Ashok

Date – 10.3.2019

- 1. Door Frame – 4 nos. (Mechanism to hang Both side Curtain)**
- 2. Some platform**
- 3. Pillars –2 nos.**