

Tender Cost: Rs. 1,000/-

NATIONAL SCHOOL OF DRAMA

(An autonomous Institute under Ministry of Culture, Govt. of India)
Bahawalpur House, 1, Bhagwandas Road, New Delhi-110001

Tender Document along with Terms & Conditions

Subject:- Renovation of Chairman office at National School of Drama, New Delhi.

1. Sealed Tenders are invited from eligible and reputed firms, for Renovation of Chairman office at National School of Drama, New Delhi. Agencies shall have relevant experience of similar work in Government Departments only.
2. Tender Documents can be downloaded from NSD's website <http://www.nsd.gov.in> for which the Agency has to pay Rs. 1,000/- (Rupees One Thousand Only) as Tender documents charges in the form of a crossed Demand Draft/Pay Order drawn in favour of the **Director, National School Drama, New Delhi** which is to be attached with tender at the time of submitting.
3. The bids are invited into two parts, i.e., **Qualifying/Technical Bid and Financial Bid**. The Qualifying/Technical Bid should be consisting of all technical details as per schedule of work enclosed along with commercial terms and conditions as per the proforma at **Annexure-I**. The financial bid indicating item-wise prices for the items mentioned in proforma at **Annexure-II**.
4. The Qualifying/Technical Bid and Financial Bid should be sealed by the bidder in separate covers duly superscribed and both these sealed covers are to be put in a bigger cover which should also be sealed and duly superscribed '**Tender for Renovation of Chairman office at NSD**'. The Qualifying/Technical Bid and financial bid should be addressed to **The Registrar, National School of Drama, Bahawalpur House, 1, Bhagwandas Road, New Delhi-110001** so as to reach the office on or before **09.12.2016 till 1500 hours** along with the Earnest Money Deposit of Rs. 15,000/- (Rupees Fifteen Thousand Only) in the form of a crossed Demand Draft/Pay Order drawn in favour of the **Director, National School Drama, New Delhi**. The tenders received without EMD, incomplete tenders or tenders without the supporting documents or not agreeing to terms & conditions shall be summarily rejected. A Tender Evaluation Committee constituted for the purpose will open the Qualifying/Technical Bid of the tenderers on **09.12.2016 at 1530 hours** in the presence of such tenderers who wish to be present.
5. The tenderer should sign and stamp each page of tender document as a token of acceptance of the terms & conditions contained therein and submit the same along with the bid.
6. If an Agency qualifies in the technical bid, then only its financial bid shall be opened. The financial bid indicating item-wise prices for the items mentioned in proforma at **Annexure-II**. The financial bids shall be opened by a Committee constituted by the office.

A. EARNEST MONEY DEPOSIT:-

1. Earnest Money Deposit of Rs. 15,000/- (Rupees Fifteen Thousand Only) shall be kept in the envelope containing the qualifying/technical bid. Those who do not qualify the pre-qualification conditions, shall be summarily rejected and their financial bids shall not be opened.
2. The EMD shall remain deposited with the NSD during the period of validity of the offer, i.e., maximum period of 90 calendar days from the date of opening of tender.
3. No interest shall be paid by NSD on the EMD for the above said period.

B. EVALUATION OF TENDER:-

1. The Qualifying/Technical Bid shall be opened in the first instance in the presence of the tenderers or their representatives. Only one authorized representative per tenderer, will be permitted to be present at the time of opening of tender.
2. In the Financial Bid, in proforma at **Annexure-II**, the rates, amount and total amount shall be written both in words and figures. If there is any discrepancy between the amount quoted in words and figures, the amount quoted in words will be treated as final.
3. The NSD reserves the right to select the tenderer on the basis of best possible bids received. The decision of the Tender Evaluation Committee arrived at as above shall be final and representation of any kind shall not be entertained on the above. Any attempt by any tenderer to bring pressure of any kind may disqualify the tenderer for the present tender and the tenderer may be liable to be debarred from bidding for tenders in future for a period of three years.

C. PERFORMANCE SECURITY:-

1. The successful bidders will have to submit performance security to ensure due performance of Contract to an amount of Rs. 40,000/- (Rupees Forty Thousand Only) in the form of an Account Payee Demand Draft / Fixed Deposit Receipt from a commercial bank / Bank Guarantee from a commercial bank in the name of the Director, National School of Drama, New Delhi as per the text provided by the NSD.
2. The performance security should be valid for a period of 30 days beyond the date of completion of the Contract obligation.
3. If the successful tenderer fails to furnish the performance guarantee on the terms and conditions laid down by the NSD, the tender will be rejected and the EMD shall be forfeited by NSD.

D. COST OF TENDER AND SCHEDULE OF SUBMISSION OF TENDER DOCUMENTS:-

- | | |
|--|------------------------------|
| i) Cost of Tender (Non refundable) | : Rs. 1,000/- |
| ii) Time and last date of submission of tender documents | : 09.12.2016 till 1500 hours |
| iii) Time and date of opening of tenders | : 09.12.2016 at 1530 hours |

E. COMPLETION TIME:-

The work to be completed within two months from the 7th day of award of work order.

F. PENALTY CLAUSE:-

For any delay in work beyond completion period, the penalty will be imposed for delay in work at the rate of one percent per week with maximum penalty of ten percent of total value of the contract.

G. GENERAL CONDITIONS OF THE CONTRACT:-

1. National School of Drama does not bind itself to accept the lowest or any other tender and reserves the right to reject any or all the tenders. Tenders in which any of the prescribed conditions are not fulfilled, shall be summarily rejected.
2. Canvassing whether directly or indirectly, in connection with the tender is strictly prohibited and the tenders submitted by the Contractors who resort to canvassing will be liable to rejection.
3. The tenderer shall be responsible for payment of any compensation/settlement of any liability arising out of any death or injury caused to the persons employed by him for rendering the jobs on contract under the agreement.
4. Tenderer shall not sub-let or sub-contract any part of this contract/job without the expressed written consent of the NSD. The Contractor shall also be responsible for any act of omission or commission on the part of his supervisors/workers. NSD is an International level theatre (Culture) Institute and this is a heritage building, therefore, the renovation works are to be carried out carefully as per International norms/standards. Any damage done/caused to the existing structure/furniture/fitting/equipment by the workers of the Contractor Agency shall be got rectified by the Contractor at his own risk and cost/cost received from by the Contractor.
5. The decision of the authorized officials of NSD regarding the satisfactory standard of work shall be final and binding on the Contractor. The Contractor shall comply with the monitoring mechanism/system as advised by the NSD.
6. The services provided by Firm/Agency shall be to the entire satisfaction of NSD.
7. The tenderer should ascertain the complete work to be undertaken by visiting the site before submission of tender.

8. Any additional/extra items required to be executed for the above work may kindly be intimated in advance before the execution of the same and coordinate with Estate Manager during execution of work for any change.
9. The work shall be carried out as per tender. Where specifications are silent, the decision of Estate In-Charge shall be final and binding on contractor.
10. Any damage done by the contractor to any existing item / any part of the building during the course of execution of work shall be made good by at his own cost.
11. Only articles classified as “First quality” by the manufacturer shall be used unless otherwise specified as approved by Estate In-charge.
12. The sample of material required in the work brought at site shall be got approved from Estate In-charge before use in execution of work.
13. The contractor shall submit a detailed programme of work within 7 days of the date of award of work. The Engineer – in- Charge can modify the programme and the contractors have to work accordingly.
14. The contractor shall be fully responsible for the safe custody of the material brought at site by him for doing the work and NSD will not be responsible whatever the reasons may be thereof.
15. The Malba / Garbage generated at site due to construction activities shall be removed from the site immediately & shall be disposed off by the contractor to the approved dumping site of MCD.
16. Statutory deductions will be made as applicable from the bills of contractor.

H. TERMINATION OF CONTRACT:-

In the event of services rendered being found unsatisfactory or delayed, the contract is liable to be terminated and EMD deposit will be forfeited. The decision of the NSD in this regard will be final.

I. DISPUTE RESOLUTION:-

In case of any dispute with regard to the interpretation of any clause(s) of this agreement, the same shall be referred to the sole arbitration of person appointed by NSD (Ist Party), whose decision will be final and binding on both parties.

J. VALIDITY:-

The Tender shall be valid for a period of at least three calendar months from the date of opening of the tenders for the purpose of evaluation of tender.

National School of Drama

ANNEXURE – I

(To be kept duly signed in Envelope 1 – Qualifying/Technical Bid)

TECHNICAL BID

National School of Drama

(To be kept duly signed in Envelope 1 – Qualifying/Technical Bid)

QUALIFYING/TECHNICAL BID

BIDDER IS REQUIRED TO FORWARD THE FOLLOWING DOCUMENTS FOR QUALIFYING DULY SELF-CERTIFIED, SIGNED & STAMPED:-

DETAILS

1. Name of the Registered Firm/Agency :
2. Address of the Firm/Agency :
(with Tel no., Fax & Email)
3. Name & Address of the Proprietor/ Partners/Directors (with mobile no.) :
4. Contact Person(s) (with mobile no.) :
5. PAN No. :
6. VAT Registration No. :
7. Current Bank Solvency Certificate of minimum value Rs. 20 Lakhs should be valid on date of submission :
8. Details of Tender Cost :
9. Details of EMD :
10. Details of the experience with Govt. departments only. The firm should have carried out the minimum two similar type of work above Rs. 10 lakhs in Government departments and should enclosed the necessary documents.
11. Declaration certificate attached to be stamped & signed.

(Signature of Authorized Signatory with date)

Date : _____

Place: _____

Name of the Firm/Agency & stamp

DECLARATION

I hereby certify that all the information furnished in the offer submitted above are complete and correct to the best of my/our knowledge. I also hereby confirm and declare that the firm has not been black listed by any Institutional agencies / Govt. Deptt. / PSU. I understand that in case any deviation is found in the above statement at any stage, the tender will be out right rejected & action as deem fit will be initiated against the firm/agency.

Date: _____

Signature of the Bidder with date

Place: _____

(Name of the Firm/Agency and stamp)

Name of Work: - Renovation of Chairman office at National School of Drama.

S. No.	Description	Unit	Qty.
1	Dismantling & Demolishing Work		
1a	Dismantling of false ceiling and wooden paneling & flooring including removing of main door, Washbasin, WC, Old electric wiring & switch box board etc., including disposal of malba to outside premises at MCD dumping ground.	Job	1.00
2	Masonry Work		
2a	(i) P/F 6 mm wooden ply duly painted to close the existing window. (ii) Half brick masonry with common burnt clay F.P.S. (non modular) Plaster Cement mortar 1:3 (1 cement : 3 coarse sand) including providing 2 nos reinforcement of 8mm dia at every forth layer.	Job	1.00
3	Fancy Sliding Door		
3a	(i) P/F outer frame with 125mm x 50mm teak wood frame. (ii) P/F 19 mm commercial board high density exterior grade (Grade I) in between teak wood frame as per drawing. (iii) P/F 3mm veneer (off white) fitted on top of commercial board on front side and Melamine polishing on back side. (iv) P/F Teak wood wood strip to be fitted on veneer on front as per drawing. P/F over hanging stainless steel sliding channel for smooth moving of sliding door including all necessary accessories complete as per approved drawing.		
3b	For Bath Room sliding door (Size 1100x2100mm).	Nos.	1.00
3c	For Chairman Room sliding door (Size 1500x2100mm).	Nos.	1.00
4	Decorative design main door total 38 mm thick		
4a	(i) P/F internal frame of 1st class hard wood. (ii) 4 mm thick teak veneer with vertical grains or cross (bands) on hard board. (iii) Melamine polishing on both side. Rate including P/F SS hinges, Anodized Stainless steel handle, Mortice lock, Tower bolts, Door stopper & Hydraulic door closer complete in all respect and including providing & fixing moulding at door chowkhat of size 50mm x 25mm. Complete work as per specification and as per approved drawing.	Nos.	1.00
5	Wooden Partition (Size 1800x1950mm)		
5a	(i) P/F outer frame of 125x50mm teak wood. (ii) P/F 19 mm commercial board fitted on saal wood frame. (iii) P/F 3mm veneer (off white) both side on commercial board. (iv) P/F Teak wood strip to be fitted on top of veneer as per drawing.	Job	1.00

6	Art Work board (Size 760mmx2100mm)		
6a	(i) P/F Kiln seasoned and chemically treated including termite treatment with polishing saal wood frame battens 125x50mm. (ii) P/F 8mm thick commercial board high density exterior grade (Grade I) on front side on saal wood frame. (iii) P/F the decorative veneer 3mm (off white) on top of commercial board on front side. (iv) P/F of 4mm thick MDF decorative design pieces (duly painted with deco paint) over the veneer as per approved pattern with necessary adhesive, screws.	Nos	2.00
7	Wooden Flooring		
7a	P/F of 8MM thick HDF (850 plus kg/m3) laminated wooden flooring, plank size 1202MM x 192MM and having weight per plank of 1.75 kgs., made with wood used plantation timber, with licensed interlocking system having L2C Holographic Label conforming to abrasion class AC3/AC4 requirements as per (EN 13329) standard. Underlay of 0.6 mm PE film and 2MM PU Foam with accessories like skirting (100/60mmX 12MM), T-profile(45MMX 15MM), beading (18MMx 18mm) to be used for installation.	Sqm	20.00
8	Wall wooden work		
8a	<u>Sal Wood for battens</u> (i) P/F Kiln seasoned and chemically treated including termite treatment with polishing saal wood frame battens 125x50mm to be fix on wall on all sides as per drawing with drilling/ screwing.	Cum	0.50
8b	<u>Commercial Board</u> P/F approved 19 mm commercial board high density exterior grade (Grade I) on saal wood batten frame, backing or studding with screws, polishing etc. complete on all sides.	Sqm	20.00
8c	Providing & fixing 4mm thick vineer (teak wood look) on top of commercial ply board on all sides as per drawing.	Sqm	20.00
8d	(i) P/F teak wood (first class) 100x40mm frame on veneer on wall. (Please refer 3D Image). (ii) P/F teak wood (first class) 100x40mm frame below false ceiling refer (item No. 12).	Cum	1.00
9	Ceiling wooden jali		
9a	P/F approved 600x600mm wooden jali (10 Nos.) made of size 12x18mm Teak wood, in side teak wood ceiling frame (frame already taken in item no. 8d (ii) with necessary screws, polishing etc. complete as per 3d image.	Sqm	18.00

10	Cupboard & Racks		
10a	(i) P/F Kiln seasoned and chemically treated including termite treatment with polishing saal wood frame battens 125x50mm. (i) P/F 19mm commercial board high density exterior grade (Grade I) on frame. (iii) P/F 4mm thick vineer (teak wood look) on board. The work to be complete with garnish moulding etc. as per drawing. Size of Rack 1800x1860mm	Job	1.00
11	Painting Work		
11a	Painting of room with Royal paint of approved colour and shade, including preparing the surfaces with filling materials (primer, POP, birla wall putty) etc complete including scaffolding as per requirement of Architect and Estate In-charge.	Sqm	40.00
12	FALSE CEILING		
12a	Providing & fixing 25mmx28mm (T shape) grid frame with powder coating with all hanging support including accessories along with white ceiling tile of 600mmX600mm (ARMSSTRONG make) as per approved design.	Sqm	24.00
13	Bath Room wall tiles		
13a	P/F first quality bath room wall tiles 600x300 mm including highlighter tile of approved make and colour fitted with 12 mm thick cement Mortar 1:3 (1 cement : 3 coarse sand) and jointing with white cement slurry.	Sqm	10.00
14	Bath Room Floor tiles		
14a	Providing and laying 1st quality vitrified floor tiles (600x600 mm) for bath room, as per approved make and colour fitted with cement mortar 1:4 (1Cement : 4 Coarse sand) including grouting the joints with white cement and matching pigments etc.	Sqm	4.00
15	Sanitary & Bathroom Fittings		
15a	Providing & fixing European W.C in single piece including flushing system as approved by Estate In-charge of approved make Hindware/Cera or equivalent. The work to be completed in all respect with all fittings and accessories.	Nos.	1.00
15b	P/F soap container, paper holder, bib cocks, brass angle valve for basin mixture, health faucet, jetspreader, wash basin, white granite counter, bottle trap, towel rail, looking mirror, air freshener, 3 ltr. geyser, wall fan & exhaust fan. The rates should be inclusive of all items of reputed brand to be approved by Estate In-charge.	Job	1.00
16	Electrical Work: LED Light		
16a	(i) P/F 8 Nos. of 18watt LED lights (LED panel slim downlight (round Edge lite) Dia 135mm. (ii) P/F 3 Nos. of 12watt LED lights (LED panel slim downlight (round Edge lite) dia 75mm. (iii) P/F 4 Nos. of 36 watt 600mmx600mm ceiling LED lights.	Job	1.00

16b	P/F modular switches and sockets of approved make and colour with box & switch plates including concealed conduiting & electric wiring. P/F 25 Nos. 10 Amp modular electric switch with socket. P/F 4 Nos. 15 Amp modular electric switch/ socket. P/F 1 Nos. 25 Amp. MCB double pole, 1ph, 240 V with complete concealed conduiting/wiring for AC. P/L one internet point along with wiring and tag block for connection.	Job	1.00
-----	--	-----	------

NOTE:- THE BLANK SCHEDULE OF QUANTITIES ENCLOSED SHOULD BE DULY SIGNED AND WITHOUT AMOUNT. THE AMOUNT SHOULD BE FILLED ONLY IN THE FINANCIAL BID.

Signature of the Bidder with date

Date :

Place :

**(Name of the Firm/Agency and stamp)
(with Address, Tel. No., Fax & Email)**

National School of Drama

ANNEXURE – II

(To be kept duly signed in Envelop 2 – Financial Bid)

FINANCIAL BID

FINANCIAL BID

Name of Work: - Renovation of Chairman office at National School of Drama.

S. No.	Description	Unit	Qty.	Rate	Amount
1	Dismantling & Demolishing Work				
1a	Dismantling of false ceiling and wooden paneling & flooring including removing of main door, Washbasin, WC, Old electric wiring & switch box board etc., including disposal of malba to outside premises at MCD dumping ground.	Job	1.00		
2	Masonry Work				
2a	(i) P/F 6 mm wooden ply duly painted to close the existing window. (ii) Half brick masonry with common burnt clay F.P.S. (non modular) Plaster Cement mortar 1:3 (1 cement : 3 coarse sand) including providing 2 nos reinforcement of 8mm dia at every forth layer.	Job	1.00		
3	Fancy Sliding Door				
3a	(i) P/F outer frame with 125mm x 50mm teak wood frame. (ii) P/F 19 mm commercial board high density exterior grade (Grade I) in between teak wood frame as per drawing. (iii) P/F 3mm veneer (off white) fitted on top of commercial board on front side and Melamine polishing on back side. (iv) P/F Teak wood wood strip to be fitted on veneer on front as per drawing. P/F over hanging stainless steel sliding channel for smooth moving of sliding door including all necessary accessories complete as per approved drawing.				
3b	For Bath Room sliding door (Size 1100x2100mm).	Nos.	1.00		
3c	For Chairman Room sliding door (Size 1500x2100mm).	Nos.	1.00		
4	Decorative design main door total 38 mm thick				
4a	(i) P/F internal frame of 1st class hard wood. (ii) 4 mm thick teak veneer with vertical grains or cross (bands) on hard board. (iii) Melamine polishing on both side. Rate including P/F SS hinges, Anodized Stainless steel handle, Mortice lock, Tower bolts, Door stopper & Hydraulic door closer complete in all respect and including providing & fixing moulding at door chowkhat of size 50mm x 25mm. Complete work as per specification and as per approved drawing.	Nos.	1.00		

5	Wooden Partition (Size 1800x1950mm)				
5a	(i) P/F outer frame of 125x50mm teak wood. (ii) P/F 19 mm commercial board fitted on saal wood frame. (iii) P/F 3mm veneer (off white) both side on commercial board. (iv) P/F Teak wood strip to be fitted on top of veneer as per drawing.	Job	1.00		
6	Art Work board (Size 760mmx2100mm)				
6a	(i) P/F Kiln seasoned and chemically treated including termite treatment with polishing saal wood frame battens 125x50mm. (ii) P/F 8mm thick commercial board high density exterior grade (Grade I) on front side on saal wood frame. (iii) P/F the decorative veneer 3mm (off white) on top of commercial board on front side. (iv) P/F of 4mm thick MDF decorative design pieces (duly painted with deco paint) over the veneer as per approved pattern with necessary adhesive, screws.	Nos	2.00		
7	Wooden Flooring				
7a	P/F of 8MM thick HDF (850 plus kg/m ³) laminated wooden flooring, plank size 1202MM x 192MM and having weight per plank of 1.75 kgs., made with wood used plantation timber, with licensed interlocking system having L2C Holographic Label conforming to abrasion class AC3/AC4 requirements as per (EN 13329) standard. Underlay of 0.6 mm PE film and 2MM PU Foam with accessories like skirting (100/60mmX 12MM), T-profile(45MMX 15MM), beading (18MMx 18mm) to be used for installation.	Sqm	20.00		
8	Wall wooden work				
8a	<u>Sal Wood for battens</u> (i) P/F Kiln seasoned and chemically treated including termite treatment with polishing saal wood frame battens 125x50mm to be fix on wall on all sides as per drawing with drilling/ screwing.	Cum	0.50		
8b	<u>Commercial Board</u> P/F approved 19 mm commercial board high density exterior grade (Grade I) on saal wood batten frame, backing or studding with screws, polishing etc. complete on all sides.	Sqm	20.00		
8c	Providing & fixing 4mm thick vineer (teak wood look) on top of commercial ply board on all sides as per drawing.	Sqm	20.00		
8d	(i) P/F teak wood (first class) 100x40mm frame on veneer on wall. (Please refer 3D Image). (ii) P/F teak wood (first class) 100x40mm frame below false ceiling refer (item No. 12).	Cum	1.00		

9	Ceiling wooden jali				
9a	P/F approved 600x600mm wooden jali (10 Nos.) made of size 12x18mm Teak wood, in side teak wood ceiling frame (frame already taken in item no. 8d (ii) with necessary screws, polishing etc. complete as per 3d image.	Sqm	18.00		
10	Cupboard & Racks				
10a	(i) P/F Kiln seasoned and chemically treated including termite treatment with polishing saal wood frame battens 125x50mm. (i) P/F 19mm commercial board high density exterior grade (Grade I) on frame. (iii) P/F 4mm thick veneer (teak wood look) on board. The work to be complete with garnish moulding etc. as per drawing. Size of Rack 1800x1860mm	Job	1.00		
11	Painting Work				
11a	Painting of room with Royal paint of approved colour and shade, including preparing the surfaces with filling materials (primer, POP, birla wall putty) etc complete including scaffolding as per requirement of Architect and Estate In-charge.	Sqm	40.00		
12	FALSE CEILING				
12a	Providing & fixing 25mmx28mm (T shape) grid frame with powder coating with all hanging support including accessories along with white ceiling tile of 600mmX600mm (ARMSSTRONG make) as per approved design.	Sqm	24.00		
13	Bath Room wall tiles				
13a	P/F first quality bath room wall tiles 600x300 mm including highlighter tile of approved make and colour fitted with 12 mm thick cement Mortar 1:3 (1 cement : 3 coarse sand) and jointing with white cement slurry.	Sqm	10.00		
14	Bath Room Floor tiles				
14a	Providing and laying 1st quality vitrified floor tiles (600x600 mm) for bath room, as per approved make and colour fitted with cement mortar 1:4 (1Cement : 4 Coarse sand) including grouting the joints with white cement and matching pigments etc.	Sqm	4.00		
15	Sanitary & Bathroom Fittings				
15a	Providing & fixing European W.C in single piece including flushing system as approved by Estate In-charge of approved make Hindware/Cera or equivalent. The work to be completed in all respect with all fittings and accessories.	Nos.	1.00		
15b	P/F soap container, paper holder, bib cocks, brass angle valve for basin mixture, health faucet, jetspreader, wash basin, white granite counter, bottle trap, towel rail, looking mirror, air freshener, 3 ltr. geyser, wall fan & exhaust fan. The rates should be inclusive of all items of reputed brand to be approved by Estate In-charge.	Job	1.00		

16	Electrical Work: LED Light				
16a	(i) P/F 8 Nos. of 18watt LED lights (LED panel slim downlight (round Edge lite) Dia 135mm. (ii) P/F 3 Nos. of 12watt LED lights (LED panel slim downlight (round Edge lite) dia 75mm. (iii) P/F 4 Nos. of 36 watt 600mmx600mm ceiling LED lights.	Job	1.00		
16b	P/F modular switches and sockets of approved make and colour with box & switch plates including concealed conduiting & electric wiring. P/F 25 Nos. 10 Amp modular electric switch with socket. P/F 4 Nos. 15 Amp modular electric switch/ socket. P/F 1 Nos. 25 Amp. MCB double pole, 1ph, 240 V with complete concealed conduiting/wiring for AC. P/L one internet point along with wiring and tag block for connection.	Job	1.00		
TOTAL:-					

All the rates & amount should be quoted in words in figure.

Note:- Chairman office renovation is a very prestigious work and should be of very high quality & finishing and to be completed strictly as per approved drawings & direction of Estate In-charge/Architect. All the items should be used of highly reputed brand and duly approved by the Estate In-charge/Architect. Contractor should visit the site before quoting the rates.

Date :

Signature of the Bidder with date

Place :

(Name of the Firm/Agency and stamp)
(with Address, Tel. No., Fax & Email)

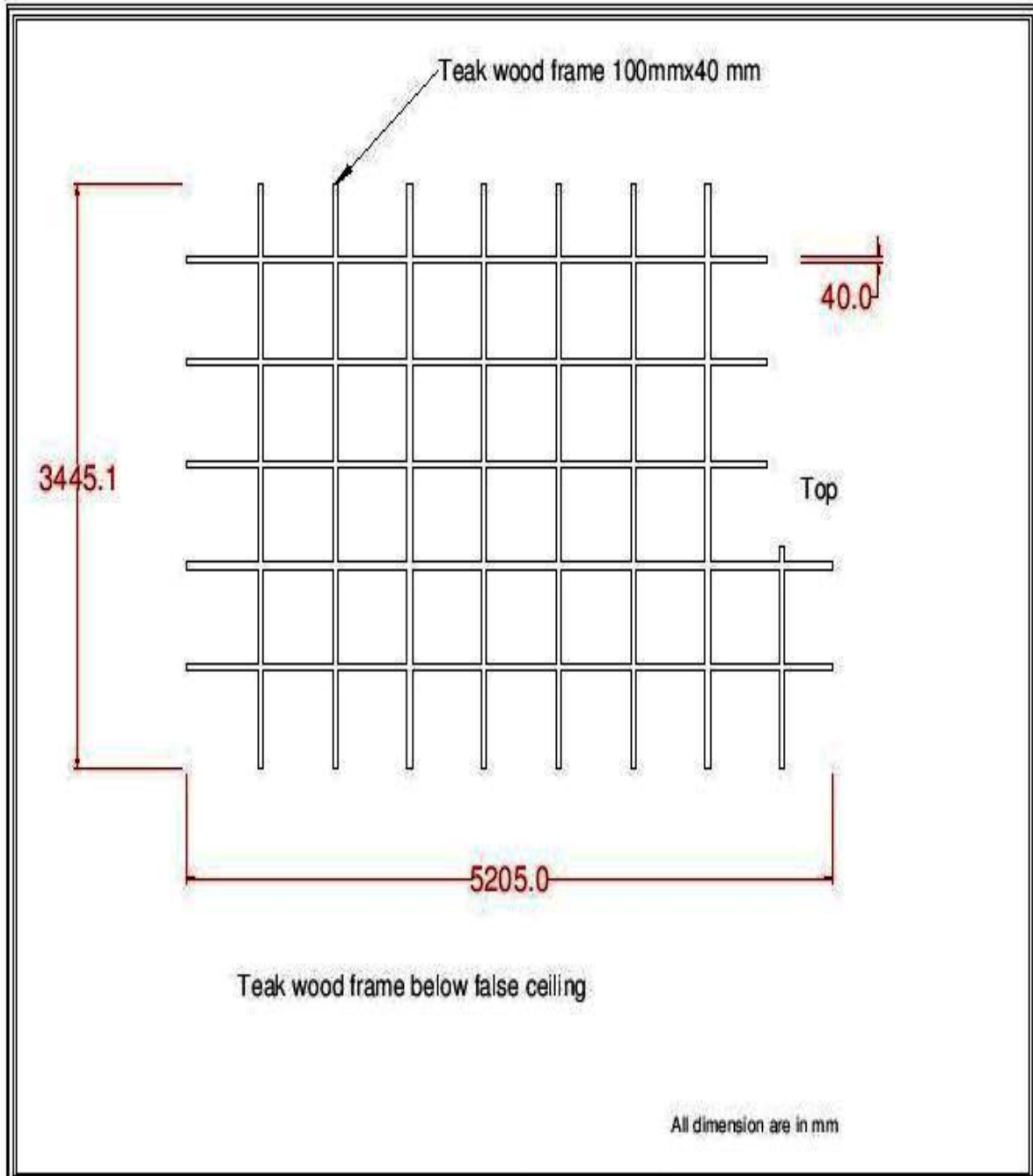

CHAIRMAN ROOM	Title	Teak wood frame below false ceiling
	Drawing NO:	A-1
PACESETTERS	Date :	
	Drawing By :	

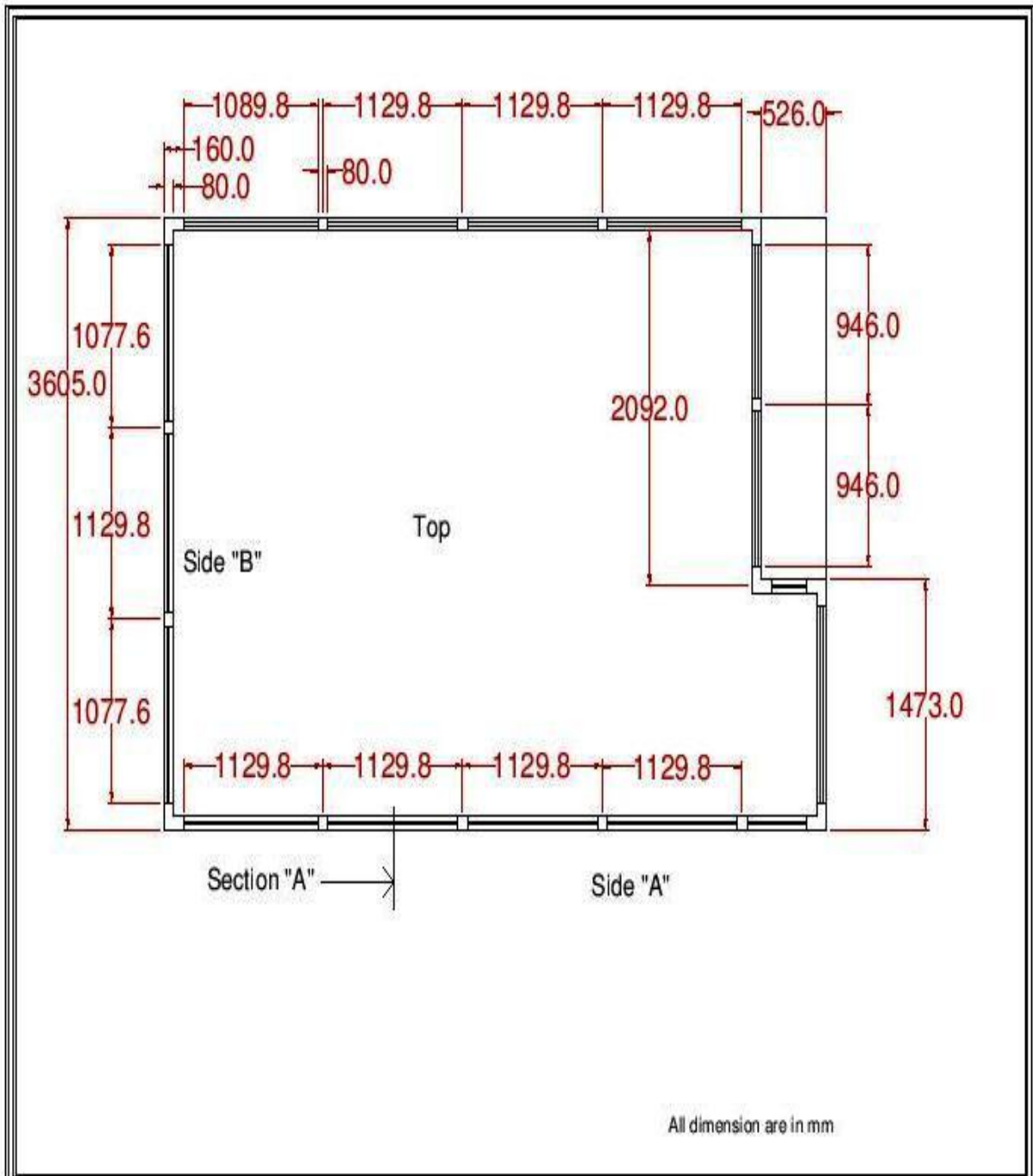

CHAIRMAN ROOM	Title	Teak wood frame on wall top view
	Drawing NO:	A-2
PACESETTERS	Date :	
	Drawing By :	

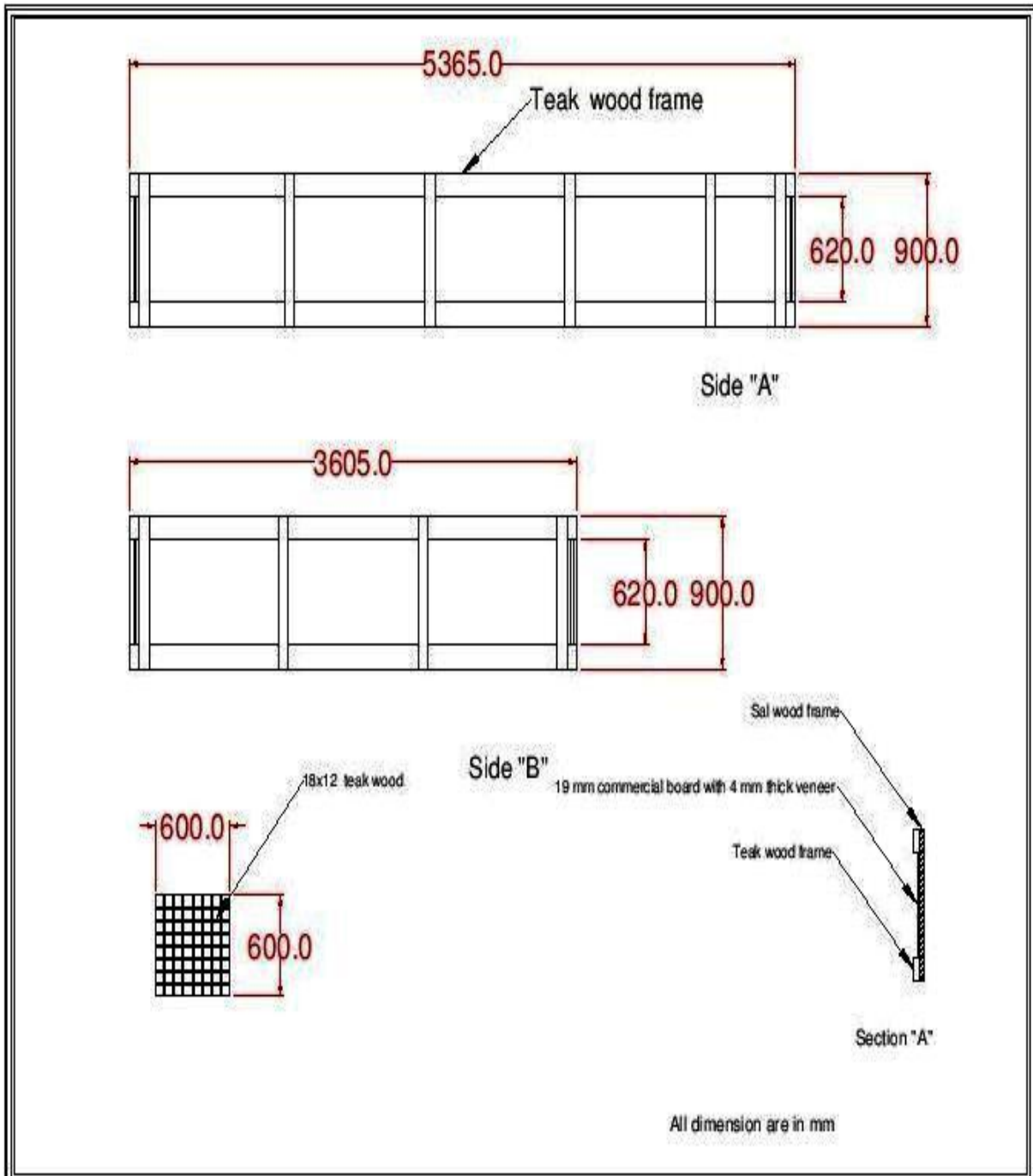

CHAIRMAN ROOM	Title	Teak wood frame on wall side view & section view
	Drawing NO:	A-3
PACESETTERS	Date :	
	Drawing By :	

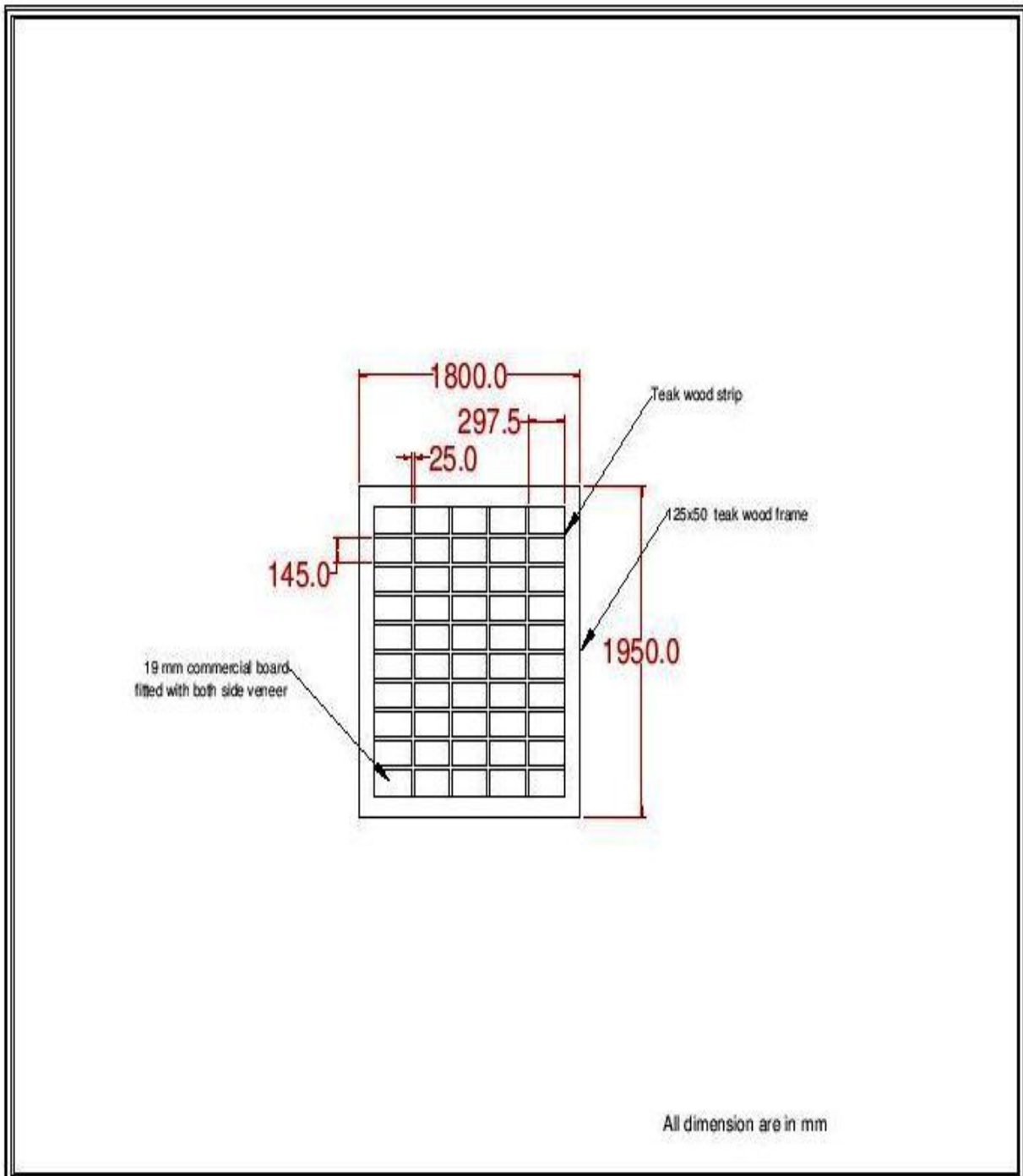

CHAIRMAN ROOM	Title	Wooden Partition
	Drawing NO:	A-4
PACSESETTERS	Date :	
	Drawing By :	

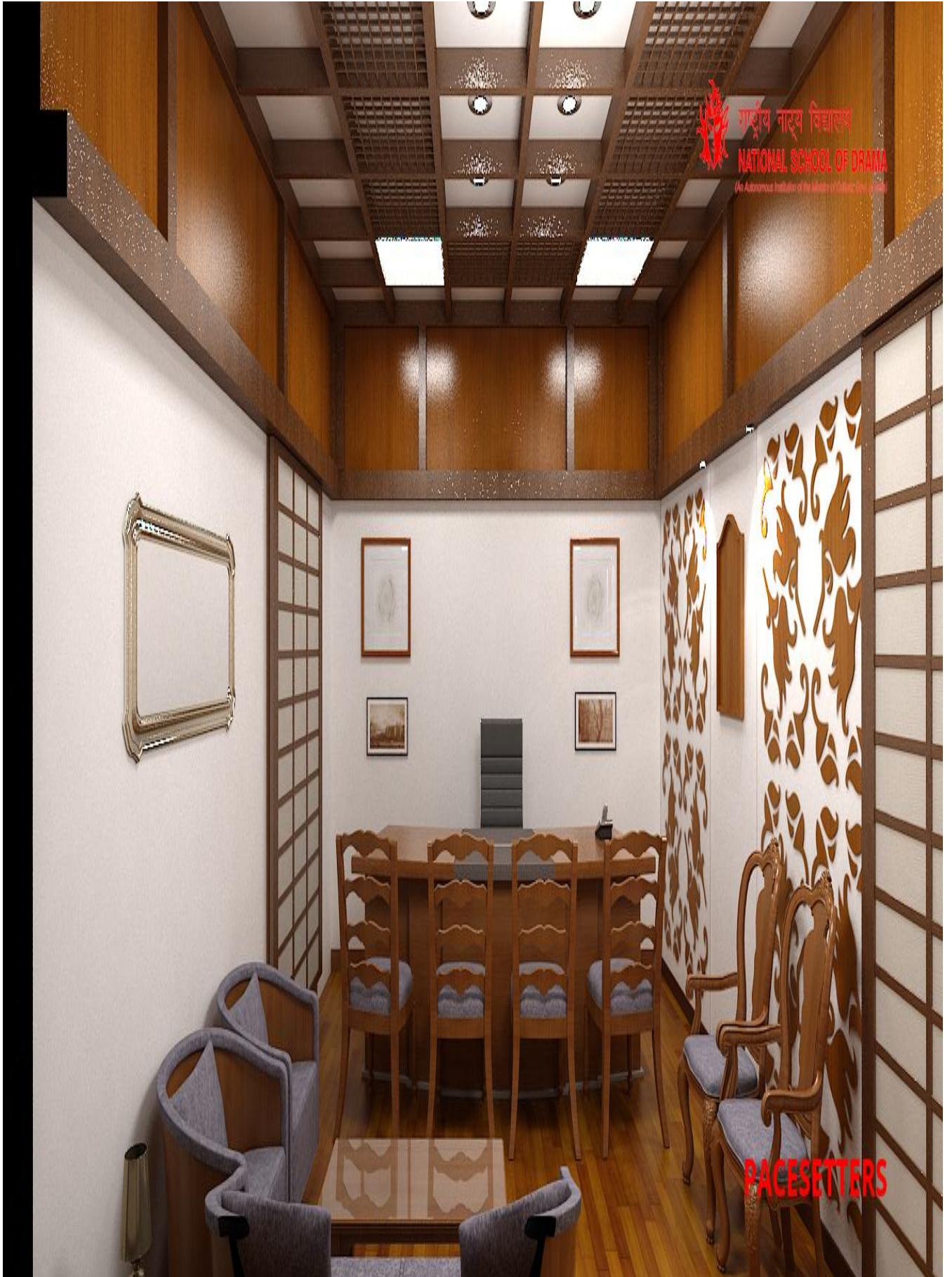



राष्ट्रीय नाट्य विद्यालय
NATIONAL SCHOOL OF DRAMA
An Autonomous Institute for the Study and Training of Students in the Field of Drama

PACESETTERS



राष्ट्रीय नाट्य विद्यालय
NATIONAL SCHOOL OF DRAMA
(An Autonomous Institution of the Ministry of Culture, Govt. of India)



PACESETTERS